

SERIES | SERIES: PROLAMP 3.0

BRAND: i-LèD



40 W

80 W

100 W

120-150 W

180-200W

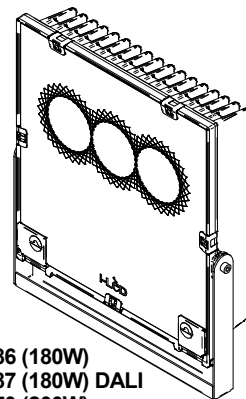
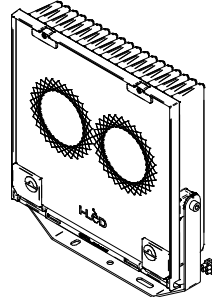
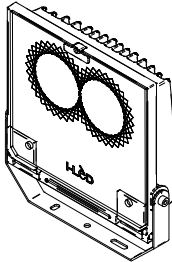
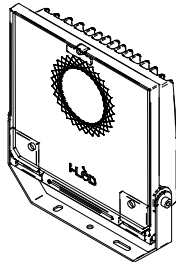
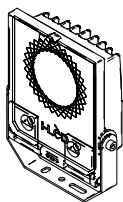

82270
82271 DALI

82272
82273 DALI

84068
84441 DALI

82274 (120W)
82275 (120W) DALI
84069 (150W)
84442 (150W) DALI

82286 (180W)
82287 (180W) DALI
84070 (200W)
84443 (200W) DALI

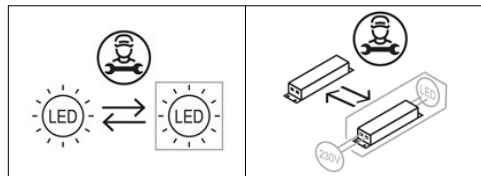

Installazione / Manutenzione

L'articolo dovrà essere installato da personale qualificato, **seguendo le normative d'installazione vigenti del paese di appartenenza**;
In caso di malfunzionamento o necessità di manutenzione dell'articolo contattare il servizio clienti Linea Light tramite la seguente mail: support@linealight.com.

**SONO SEVERAMENTE VIETATE LE OPERAZIONI DI INSTALLAZIONE E MANUTENZIONE DELL'ARTICOLO MENTRE QUEST ULTIMO È IN FUNZIONE;
!!! ATTENZIONE !!! DUARANTE IL FUNZIONAMENTO ALCUNE PARTI DELL'APPARECCHIO POSSONO RAGGIUNGERE TEMPERATURE ELEVATE.**

Installation / Maintenance

The article must be installed by qualified personnel, **following the installation regulations in force in your country**;
In the event of malfunction or need for maintenance of the article, contact Linea Light customer service via the following e-mail: support@linealight.com.

IT IS STRICTLY FORBIDDEN TO INSTALL AND MAINTAIN THE ARTICLE WHILE IT IS IN OPERATION; !!! WARNING !!! DURING OPERATION, CERTAIN PARTS OF THE APPLIANCE MAY REACH HIGH TEMPERATURES.

LINEA LIGHT declines any kind of responsibility if the instructions provided in the following instruction manual and in the main manual present in the article's packaging are not followed.

UTILIZZO CONFORME:

L'apparecchio è garantito esclusivamente se l'articolo in questione sia stato installato seguendo le istruzioni riportate in questo manuale di istruzioni e da quello generale presenti all'interno dell'imballaggio e scaricabili dal sito: www.linealight.com; **In caso di mancata osservazione delle precedenti avvertenze, l'azienda LINEA LIGHT declinerà ogni tipologia di responsabilità.**

Un utilizzo scorretto dell'articolo può influire nella durata utile della lampada e/o potrebbe causarne un guasto precoce.
Evitare la pulizia dell'apparecchio utilizzando agenti chimici aggressivi, è sufficiente passare l'articolo con uno straccio inumidito con acqua.
Per ulteriori avvertenze e/o spiegazioni di eventuali simboli si prega di visionare il foglio istruzioni generale.

CONSERVARE LE PRESENTI ISTRUZIONI PER FUTURI LAVORI DI INSTALLAZIONE/MANUTENZIONE.

COMPLIANT USE:

The luminaire is only guaranteed if the article in question has been installed in accordance with the instructions given in this instruction manual and the general manual found inside the packaging and downloadable from: www.linealight.com; **In the event of failure to comply with the above warnings, LINEA LIGHT declines all liability.**

*Incorrect use of the article may affect the service life of the lamp and/or cause it to fail prematurely.
Avoid cleaning the fixture using harsh chemicals, simply wipe the item with a cloth dampened with water.
For further warnings and/or explanations of possible symbols please refer to the general instruction sheet.*

KEEP THESE INSTRUCTIONS FOR FUTURE INSTALLATION/MAINTENANCE WORK.

(ITA) - I prodotti devono essere installati tassativamente con alimentazioni, cablaggi e accessori originali del Gruppo Linea Light, o eventualmente approvati dall'azienda. L'utilizzo di accessori non originali, o non approvati, determina il decadimento di ogni garanzia sul prodotto. (ENG) - All power supply, wiring and accessories used for product installation shall be original Linea Light Group parts or approved by the company. The warranty will become void if non original or non approved parts are used. (FRA) - Les produits doivent impérativement être installés avec des alimentations, des câblages et des accessoires Linea Light Group, ou qui ont été approuvés par l'entreprise. L'utilisation d'accessoires non d'origine, ou non approuvés, entraîne la déchéance de toute garantie sur le produit. (ESP) - Los productos se han de instalar obligatoriamente con alimentaciones, cableados y accesorios originales de Linea Light Group o, de otra forma, deben ser aprobados por la empresa misma. El uso de accesorios no originales, o no aprobados, anula todas las garantías del producto. (GER) Die Produkte müssen obligatorisch mit Originalstromversorgung, Originalkabeln und Originalzubehör der Linea Light Group oder mit Teilen, die von der Linea Light Group ausdrücklich empfohlen sind, installiert werden. Die Verwendung von nicht originale oder nicht vom Hersteller empfohlenem Zubehör führt zu einem sofortigen Verfall vom Garantieanspruch für das Produkt.

SERIES | SERIES: PROLAMP 3.0

BRAND: i-L^{ED}

CODICI / CODES

CODE	Input [V]	Dimenensions [mm]	Power [W]	Weight [Kg]	Walk Over	Drive Over [Kg]	Safety Class	IP	CRI	Color Temp. [°K]	Energy Class	N° Light Source
82270	220-240	240x192x75	40	1.7	No	0	1	66	80	5000	E	1
82270	220-240	240x192x75	40	1.7	No	0	1	66	80	4000	E	1
82270	220-240	240x192x75	40	1.7	No	0	1	66	80	3000	E	1
82271	220-240	240x192x75	40	1.7	No	0	1	66	80	5000	E	1
82271	220-240	240x192x75	40	1.7	No	0	1	66	80	4000	E	1
82271	220-240	240x192x75	40	1.7	No	0	1	66	80	3000	E	1
82272	220-240	300x292x78	80	3.8	No	0	1	66	80	5000	E	1
82272	220-240	300x292x78	80	3.8	No	0	1	66	80	4000	E	1
82272	220-240	300x292x78	80	3.8	No	0	1	66	80	3000	E	1
82273	220-240	300x292x78	80	3.8	No	0	1	66	80	5000	E	1
82273	220-240	300x292x78	80	3.8	No	0	1	66	80	4000	E	1
82273	220-240	300x292x78	80	3.8	No	0	1	66	80	3000	E	1
84068	220-240	300x292x78	100	3.8	No	0	1	66	80	5000	E	1
84068	220-240	300x292x78	100	3.8	No	0	1	66	80	4000	E	1
84068	220-240	300x292x78	100	3.8	No	0	1	66	80	3000	E	1
84441	220-240	300x292x78	100	3.8	No	0	1	66	80	5000	E	1
84441	220-240	300x292x78	100	3.8	No	0	1	66	80	4000	E	1
84441	220-240	300x292x78	100	3.8	No	0	1	66	80	3000	E	1
82274	220-240	348x324x78	120	4.6	No	0	1	66	80	5000	E	1
82274	220-240	348x324x78	120	4.6	No	0	1	66	80	4000	E	1
82274	220-240	348x324x78	120	4.6	No	0	1	66	80	3000	E	1
82275	220-240	348x324x78	120	4.6	No	0	1	66	80	5000	E	1
82275	220-240	348x324x78	120	4.6	No	0	1	66	80	4000	E	1
82275	220-240	348x324x78	120	4.6	No	0	1	66	80	3000	E	1
84069	220-240	348x324x78	150	4.6	No	0	1	66	80	5000	E	1
84069	220-240	348x324x78	150	4.6	No	0	1	66	80	4000	E	1
84069	220-240	348x324x78	150	4.6	No	0	1	66	80	3000	E	1
84442	220-240	348x324x78	150	4.6	No	0	1	66	80	5000	E	1
84442	220-240	348x324x78	150	4.6	No	0	1	66	80	4000	E	1
84442	220-240	348x324x78	150	4.6	No	0	1	66	80	3000	E	1
82286	220-240	439x391x94	180	7.8	No	0	1	66	80	5000	E	1
82286	220-240	439x391x94	180	7.8	No	0	1	66	80	4000	E	1
82286	220-240	439x391x94	180	7.8	No	0	1	66	80	3000	E	1
82287	220-240	439x391x94	180	7.8	No	0	1	66	80	5000	E	1
82287	220-240	439x391x94	180	7.8	No	0	1	66	80	4000	E	1
82287	220-240	439x391x94	180	7.8	No	0	1	66	80	3000	E	1
84070	220-240	439x391x94	200	7.8	No	0	1	66	80	5000	E	1
84070	220-240	439x391x94	200	7.8	No	0	1	66	80	4000	E	1
84070	220-240	439x391x94	200	7.8	No	0	1	66	80	3000	E	1
84443	220-240	439x391x94	200	7.8	No	0	1	66	80	5000	E	1
84443	220-240	439x391x94	200	7.8	No	0	1	66	80	4000	E	1
84443	220-240	439x391x94	200	7.8	No	0	1	66	80	3000	E	1

ACCESSORI NON INLUSI | NOT INCLUDEL ACCESSORIES

GABBIA PROTETTIVA
PROTECTIVE GRID

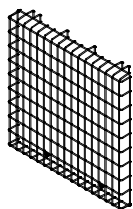

99391 (40W)
99392 (80-100W)
99574 (120-150W)
83035 (180-200W)

DALI Power Supply



99309
99310
C-E300002

Scene COM EVO



83146

OPTI Touch 4"



C-E700019 + 83009 (driver)

OPTI Touch 7"



C-E700020 + 83009 (driver)

DALI XC

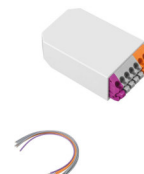

99311

SERIES | SERIES: PROLAMP 3.0

BRAND: i-LÈD

Aw AREA ESPOSTA AL VENTO
WIND EXPOSED AREA

DIMENSIONI | DIMENSIONS

82270
82271 DALI

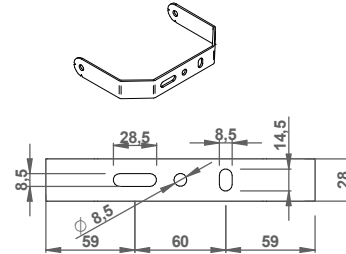
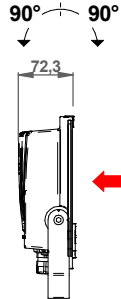
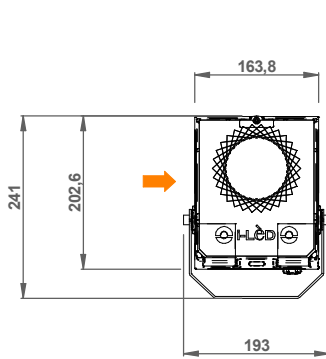

Aw = 0,015m²

Aw = 0,033m²

82272 (80W)
82273 (80W) DALI
84068 (100W)
84441(100W) DALI

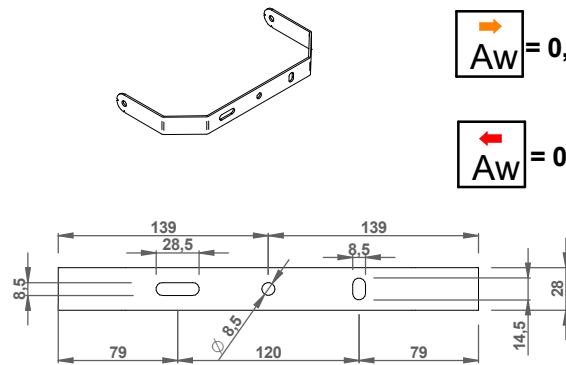
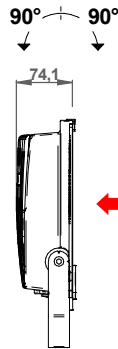
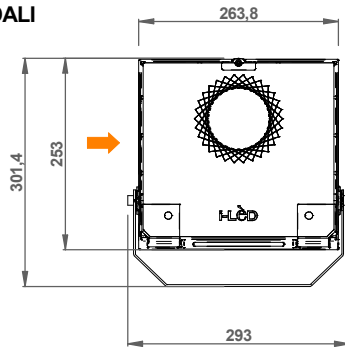

Aw = 0,02m²

Aw = 0,067m²

100W

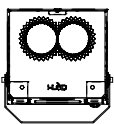

82274 (120W)
82275 (120W) DALI
84069 (150W)
84442 (150W) DALI

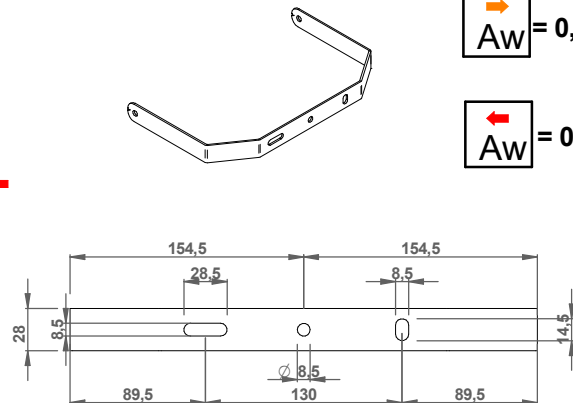
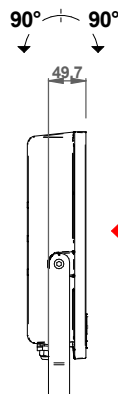
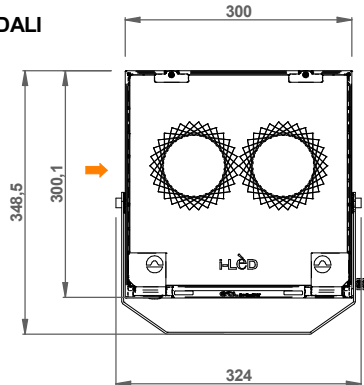

Aw = 0,023m²

Aw = 0,093m²

SERIES | SERIES: PROLAMP 3.0

BRAND: i-L^èD

Aw AREA ESPOSTA AL VENTO
WIND EXPOSED AREA

82286 (180W)
82287 (180W) DALI
84070 (200W)
84443 (200W) DALI

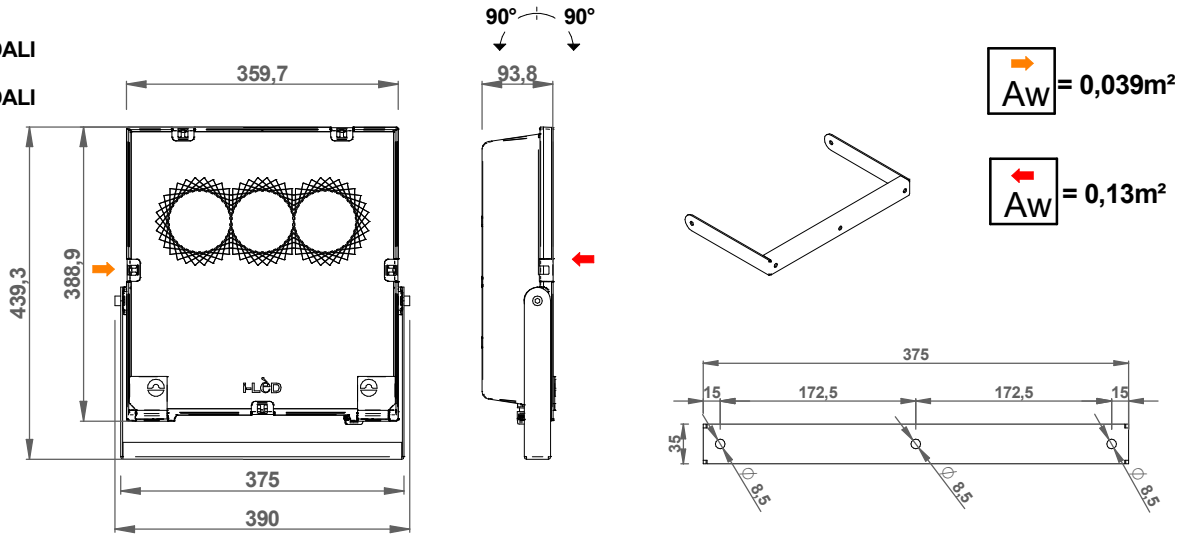

INSTALLAZIONE | INSTALLATION

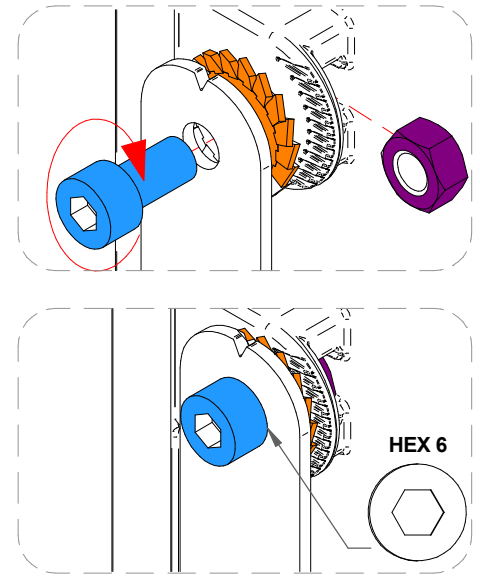
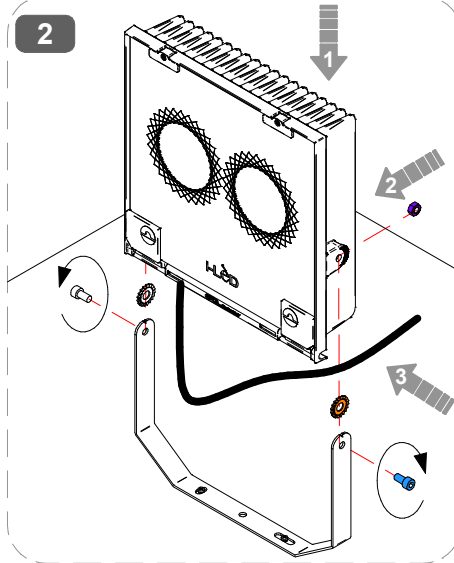
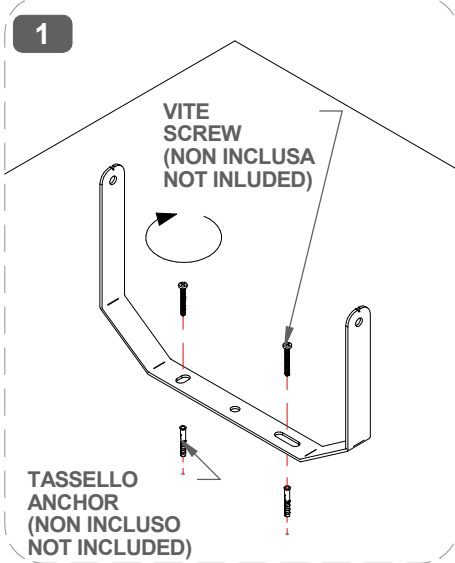

INSTALLAZIONI APPROVATE | ALLOWED INSTALLATIONS

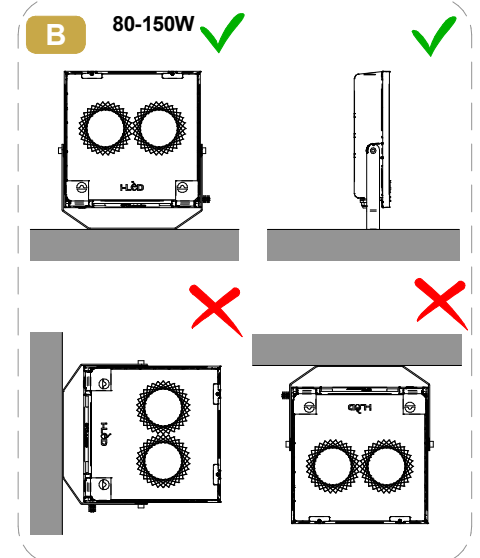
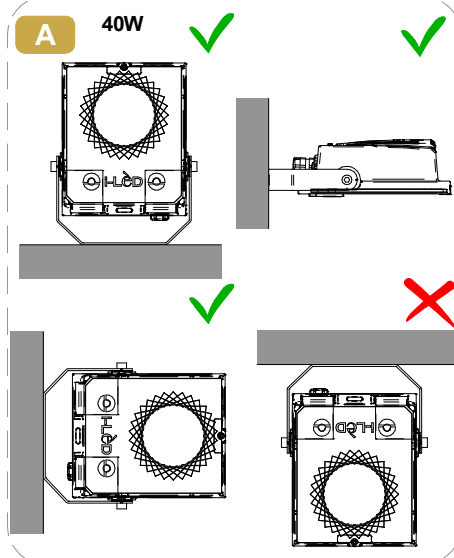
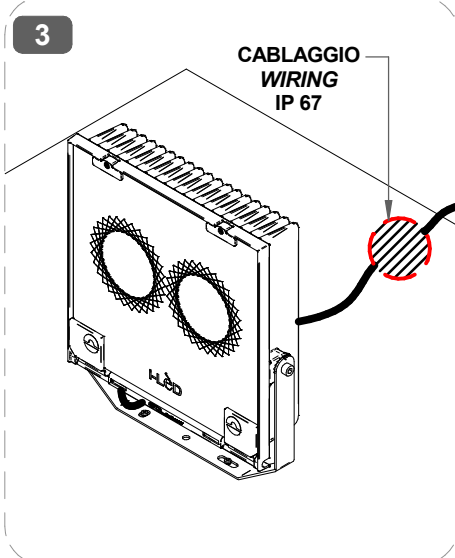

SERIES | SERIES: PROLAMP 3.0

BRAND: i-LèD

INSTALLAZIONE GABBIA | PROTECTIVE GRID INSTALLATIONS

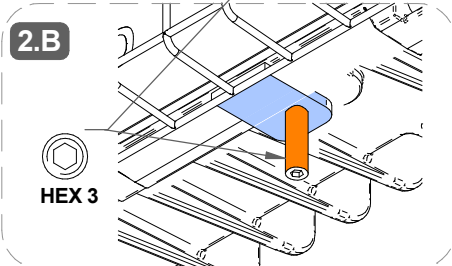
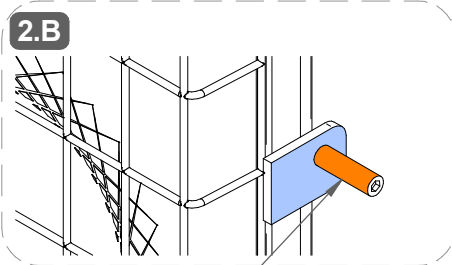
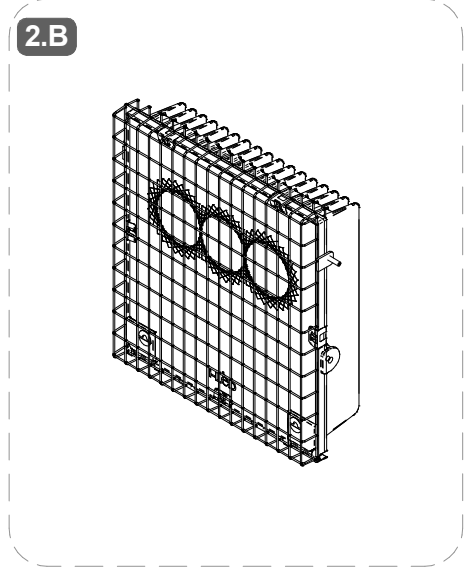
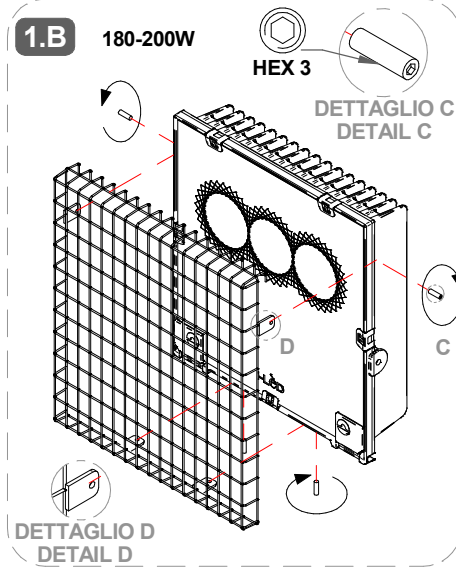
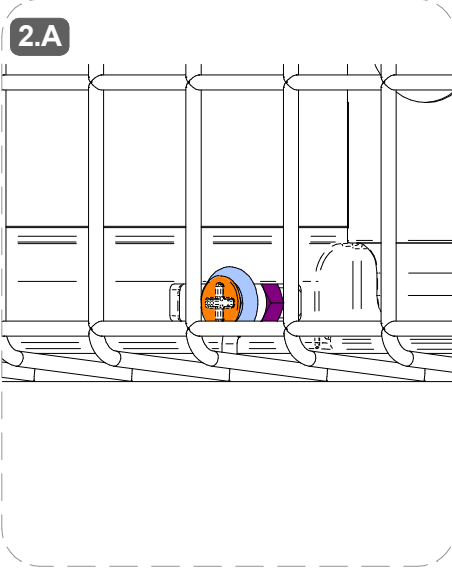
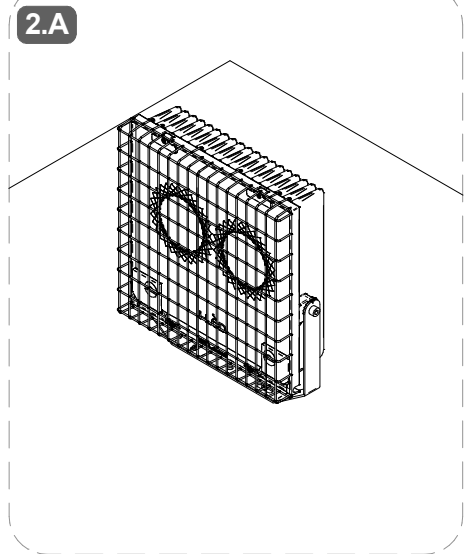
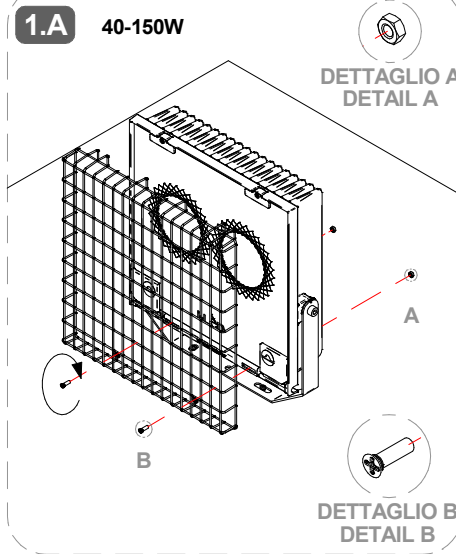
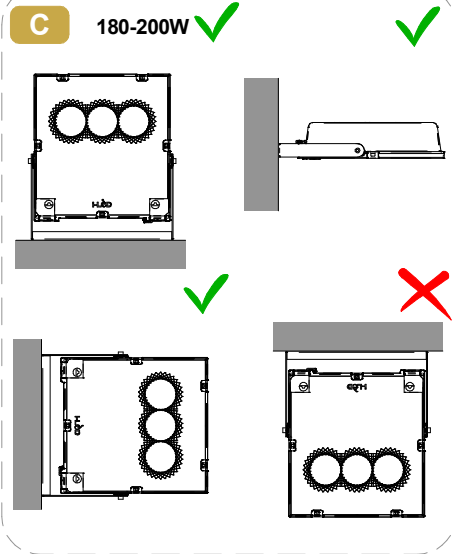

SERIES | SERIES: PROLAMP 3.0

BRAND: i-L^èD

MARRONE / BROWN = LINEA / LINE

AZZURRO / LIGHT BLUE = NEUTRO / NEUTRAL

GIALLO-VERDE / YELLOW-GREEN = TERRA / EARTH CPC | PE

CABLAGGIO / WIRING

1

TUTTE LE OPERAZIONI DI COLLEGAMENTO ALLA RETE ELETTRICA DEVONO ESSERE CONDOTTE IN MANCANZA DI TENSIONE

ALL THE WIRING OPERATION MUST BE PERFORMED WITH MCB IN OFF POSITION

2

SE IL PRODOTTO E' DEFINITO IN CLASSE 1, IL CONDUTTORE DI MESSA A TERRA DI PROTEZIONE DEVE ESSERE SEMPRE COLLEGATO

IF THE FITTING IS CLASS 1 RATED, THE CPC | EARTH | PE CONDUCTOR MUST BE CONNECTED

3

SE L'IMPIANTO E' STATO COMPLETATO ED E' IN SICUREZZA, PUO' ESSERE ALIMENTATO

WHEN THE CIRCUIT IS COMPLETED AND SAFE, MCB CAN BE SET IN ON POSITION

SI PREGA SEGUIRE LE BUONE PRATICHE DI DIMENSIONAMENTO E SEZIONAMENTO DELL'IMPIANTO ELETTRICO, TENENDO PRESENTE: LE CARATTERISTICHE DELL'INTERRUTTORE DIFFERENZIALE ED IL NUMERO DI ARTICOLI COLLEGATI ALLA LINEA ELETTRICA; QUESTO PER AGEVOLARE L'IDENTIFICAZIONE DI EVENTUALI ANOMALIE SULLA LINEA ELETTRICA

PLEASE FOLLOW THE BEST PRACTICES IN ELECTRICAL SYSTEM DESIGN, PAING ATTENTION TO THE RCCB SWITCH CHARACTERISTICS AND THE NUMBER OF FITTINGS CONNECTED TO THE ELETRICAL LINE; THIS HELPS TO IDENTIFY POSSIBLE ANOMALIES ON THE ELETRICAL LINE

AC

CORRENTE ALTERNATA
MAX. DISTANZA TRA DRIVER ED ULTIMO PRODOTTO | SEZIONE CAVO ALTERNATE CURRENT
DRIVER TO LAST LIGHT FITTING MAX DISTANCE | WIRE SECTION

SEZIONE SECTION [mm ²]	1	1.5	2.5
LUNGHEZZA LENGHT [m]	50	75	130

* Distanza massima dal driver all'ultimo articolo della linea a massimo carico.
Per lunghezze massime dei cavi effettive, fare riferimento a support@linealight.com
* Maximum distance between LED driver and last device at full load.
For effective maximum cable lengths, please refer to support@linealight.com

MCB

N° DI PRODOTTI PER MAGNETOTERMICO
N° OF LIGHT FITTINGS PER MCB

CODICE CODE	B10	B16	B20	C10	C16	C20
82270	22	36	44	37	59	74
82271	17	27	27	21	33	41
82272	12	20	25	20	33	41
82273	5	7	9	8	12	15
84068	5	8	10	8	14	17
84441	5	7	9	8	12	15
82274	4	7	9	7	11	14
82275	5	7	9	8	12	15
84069	2	4	6	4	8	10
84442	5	7	9	8	12	15
82286	4	7	9	7	11	14
82287	5	7	9	8	12	15
84070	2	3	4	3	6	7
84443	2	4	5	4	7	8

