

SERIES: XENIA\_W

BRAND: i-LèD

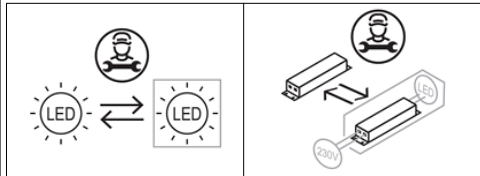
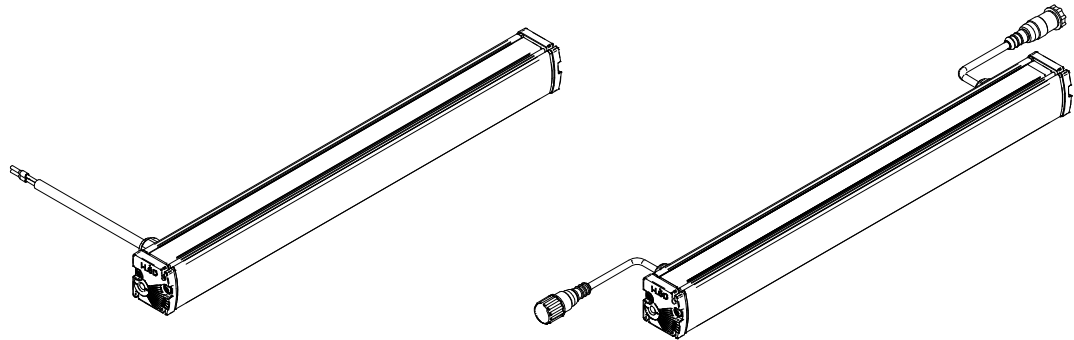

## Installazione / Manutenzione

L'articolo dovrà essere installato da personale qualificato, **seguendo le normative d'installazione vigenti del paese di appartenenza**;  
In caso di malfunzionamento o necessità di manutenzione dell'articolo contattare il servizio clienti Linea Light tramite la seguente mail: [support@linealight.com](mailto:support@linealight.com).

**SONO SEVERAMENTE VIETATE LE OPERAZIONI DI INSTALLAZIONE E MANUTENZIONE DELL'ARTICOLO MENTRE QUEST ULTIMO È IN FUNZIONE:  
!!! ATTENZIONE !!! DUARANTE IL FUNZIONAMENTO ALCUNE PARTI DELL'APPARECCHIO POSSONO RAGGIUNGERE TEMPERATURE ELEVATE.**

## Installation / Maintenance

The article must be installed by qualified personnel, **following the installation regulations in force in your country**;  
In the event of malfunction or need for maintenance of the article, contact Linea Light customer service via the following e-mail: [support@linealight.com](mailto:support@linealight.com).

**IT IS STRICTLY FORBIDDEN TO INSTALL AND MAINTAIN THE ARTICLE WHILE IT IS IN OPERATION; !!! WARNING !!! DURING OPERATION, CERTAIN PARTS OF THE APPLIANCE MAY REACH HIGH TEMPERATURES.**

**LINEA LIGHT declines any kind of responsibility** if the instructions provided in the following instruction manual and in the main manual present in the article's packaging are not followed.

## UTILIZZO CONFORME:

L'apparecchio è garantito esclusivamente se l'articolo in questione sia stato installato seguendo le istruzioni riportate in questo manuale di istruzioni e da quello generale presenti all'interno dell'imballaggio e scaricabili dal sito: [www.linealight.com](http://www.linealight.com); **In caso di mancata osservazione delle precedenti avvertenze, l'azienda LINEA LIGHT declinerà ogni tipologia di responsabilità.**

Un utilizzo scorretto dell'articolo può influire nella durata utile della lampada e/o potrebbe causarne un guasto precoce.  
Evitare la pulizia dell'apparecchio utilizzando agenti chimici aggressivi, è sufficiente passare l'articolo con uno straccio inumidito con acqua.  
Per ulteriori avvertenze e/o spiegazioni di eventuali simboli si prega di visionare il foglio istruzioni generale.

**CONSERVARE LE PRESENTI ISTRUZIONI PER FUTURI LAVORI DI INSTALLAZIONE/MANUTENZIONE.**

## COMPLIANT USE:

The luminaire is only guaranteed if the article in question has been installed in accordance with the instructions given in this instruction manual and the general manual found inside the packaging and downloadable from: [www.linealight.com](http://www.linealight.com); **In the event of failure to comply with the above warnings, LINEA LIGHT declines all liability.**

Incorrect use of the article may affect the service life of the lamp and/or cause it to fail prematurely.  
Avoid cleaning the fixture using harsh chemicals, simply wipe the item with a cloth dampened with water.  
For further warnings and/or explanations of possible symbols please refer to the general instruction sheet.

**KEEP THESE INSTRUCTIONS FOR FUTURE INSTALLATION/MAINTENANCE WORK.**

(ITA) - I prodotti devono essere installati tassativamente con alimentazioni, cablaggi e accessori originali del Gruppo Linea Light, o eventualmente approvati dall'azienda. L'utilizzo di accessori non originali, o non approvati, determina il decadimento di ogni garanzia sul prodotto. (ENG) - All power supply, wiring and accessories used for product installation shall be original Linea Light Group parts or approved by the company. The warranty will become void if non original or non approved parts are used. (FRA) - Les produits doivent impérativement être installés avec des alimentations, des câblages et des accessoires Linea Light Group, ou qui ont été approuvés par l'entreprise. L'utilisation d'accessoires non d'origine, ou non approuvés, entraîne la déchéance de toute garantie sur le produit. (ESP) - Los productos se han de instalar obligatoriamente con alimentaciones, cableados y accesorios originales de Linea Light Group o, de otra forma, deben ser aprobados por la empresa misma. El uso de accesorios no originales, o no aprobados, anula todas las garantías del producto. (GER) Die Produkte müssen obligatorisch mit Originalstromversorgung, Originalkabeln und Originalzubehör der Linea Light Group oder mit Teilen, die von der Linea Light Group ausdrücklich empfohlen sind, installiert werden. Die Verwendung von nicht originalelem oder nicht vom Hersteller empfohlenem Zubehör führt zu einem sofortigen Verfall vom Garantieanspruch für das Produkt.

**SERIES: XENIA\_W**
**BRAND: i-LÈD**
**MODELLI / MODELS**

CODE	Dimensions (LxWxH/ Ø x H mm)	POWER (W)	CLASS I / II		WEIGHT (Kg)	CLASS	IP	CRI	Energy class light source							No. light source
			INPUT (V)	FREQUENCY (Hz)					Temperature color LED (°K)							
			CLASS III						2200	2700	3000	4000	R	G	B	
		VOLTAGE (V)	CURRENT (mA)													
C00517	366X35X35	6,4	C.V. 24V	/		III	66	80	E	D	D	C				
C00518	630X35X35	11	C.V. 24V	/		III	66	80	E	D	D	C				
C00519	930X35X35	16,5	C.V. 24V	/		III	66	80	E	D	D	C				
C00520	1230X35X35	22	C.V. 24V	/		III	66	80	E	D	D	C				
C00521	1530X35X35	27,5	C.V. 24V	/		III	66	80	E	D	D	C				
C00522	366X35X35	7,2	190-250	50-60		II	66	80	E	D	D	C				
C00523	630X35X35	12,3	190-250	50-60		II	66	80	E	D	D	C				
C00524	930X35X35	18,5	190-250	50-60		II	66	80	E	D	D	C				
C00525	1230X35X35	24,6	190-250	50-60		II	66	80	E	D	D	C				
C00526	1530X35X35	30,8	190-250	50-60		II	66	80	E	D	D	C				
C00529	366X35X35	6,1	/	C.C. 630mA		III	66	80	F	D*	D*	D*				
C00530	630X35X35	12,1	/	C.C. 630mA		III	66	80	F	D*	D*	D*				
C00531	930X35X35	17,9	/	C.C. 630mA		III	66	80	F	D*	D*	D*				
C00532	1230X35X35	24,3	/	C.C. 630mA		III	66	80	F	D*	D*	D*				
C00534	366X35X35	7,8	190-250	50-60		II	66	80	F	D*	D*	D*				
C00535	630X35X35	14,2	190-250	50-60		II	66	80	F	D*	D*	D*				
C00536	930X35X35	20,4	190-250	50-60		II	66	80	F	D*	D*	D*				
C00537	1230X35X35	24,3	190-250	50-60		II	66	80	F	D*	D*	D*				
C00544	366X35X35	9	190-250	50-60		II	66	80	F	D	D	D				
C00545	630X35X35	17	190-250	50-60		II	66	80	F	D	D	D				
C00546	930X35X35	26,2	190-250	50-60		II	66	80	F	D	D	D				
C00547	1230X35X35	35,4	190-250	50-60		II	66	80	F	D	D	D				
C00548	1530X35X35	44	190-250	50-60		II	66	80	F	D	D	D				
C00550	630X35X35	17	190-250	50-60		II	66	80	F	D	D	D				
C00551	930X35X35	26,2	190-250	50-60		II	66	80	F	D	D	D				
C00552	1230X35X35	35,4	190-250	50-60		II	66	80	F	D	D	D				
C00553	1530X35X35	44	190-250	50-60		II	66	80	F	D	D	D				
C00527	535X35X35	13	190-250	50-60		II	66	80 (White)			D	C			*	
C00528	1182X35X35	24	190-250	50-60		II	66	80 (White)			D	C			*	
C00554	500X35X35	8,5	190-250	50-60		II	66	80 (White)			D	D			*	
C00555	1182X35X35	22,6	190-250	50-60		II	66	80 (White)			D	D			*	

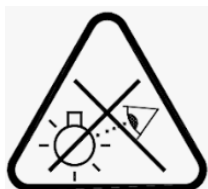
**Ta -20°C ÷ +50°C**
**\*NON FISSARE LA SORGENTE LUMINOSA.  
\*DO NOT FIX LIGHT SOURCE.**

SERIES: XENIA\_W

BRAND: i-LÈD

ACCESSORI PER INSTALLAZIONE  
NON INCLUSI

INSTALLATION ACCESSORIES  
NOT INCLUDED

B. 89045 Staffe 90mm  
B. 89045 90mm brackets



Confezione da 2 pezzi  
Qty. 2 pcs package

C. 89047 Staffe 300mm  
C. 89047 300mm brackets



Confezione da 2 pezzi  
Qty. 2 pcs package

D. C-F400006 Staffe basculanti  
D. C-F400006 Tilting brackets

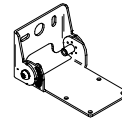

Confezione da 2 pezzi  
Qty. 2 pcs package

A. 98949 Staffe 46-67mm  
A. 98949 46-67mm brackets



Confezione da 2 pezzi  
Qty. 2 pcs package

B. 89046 Staffe 150mm  
B. 89046 150mm brackets

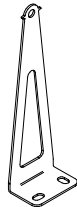

Confezione da 2 pezzi  
Qty. 2 pcs package

E. C-F400008 Mini staffe  
E. C-F400008 Mini brackets



Confezione da 2 pezzi  
Qty. 2 pcs package

PRE-INSTALLAZIONE / PRE-INSTALLATION

98949

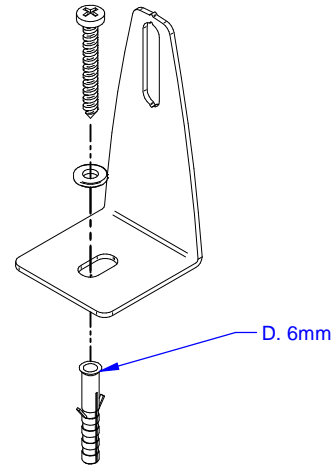
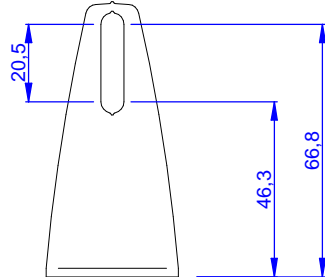
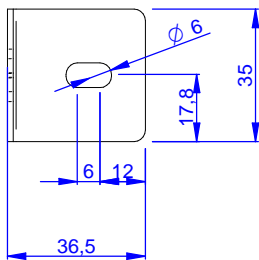

⊕  
PH2

89045 / 89046

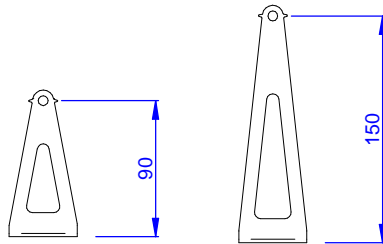
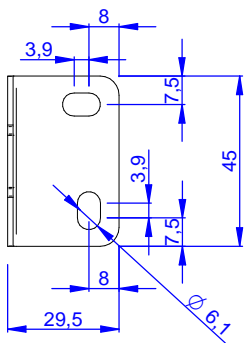

89045

89046

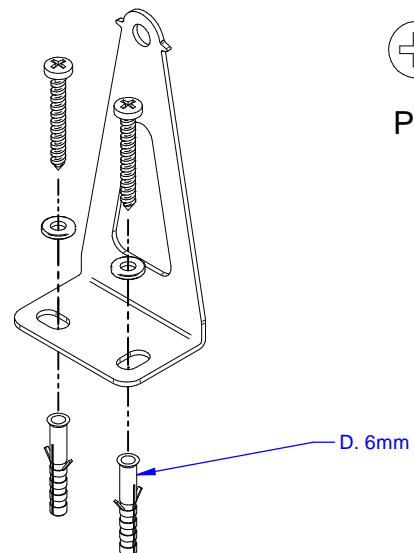

⊕  
PH2

89047

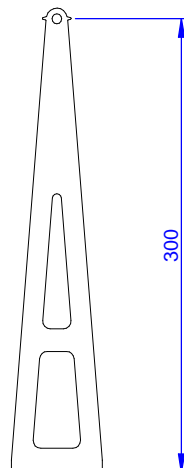
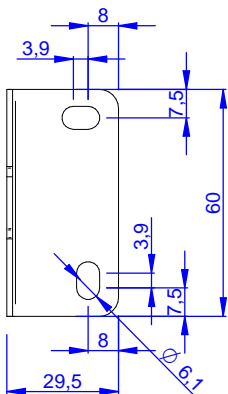

SERIES: XENIA\_W

BRAND: i-LÈD

C-F400008

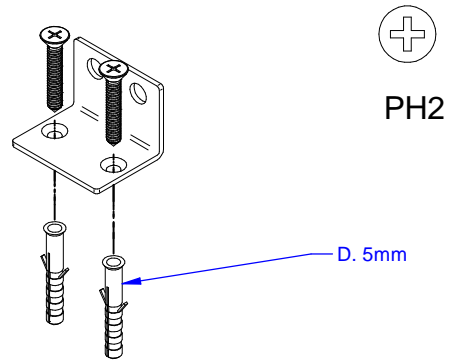
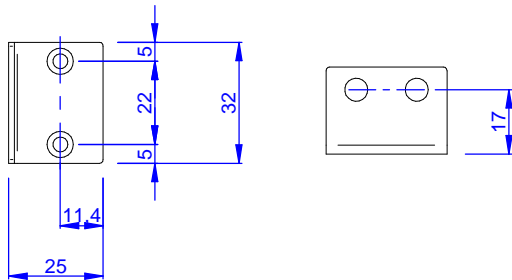

C-F400006

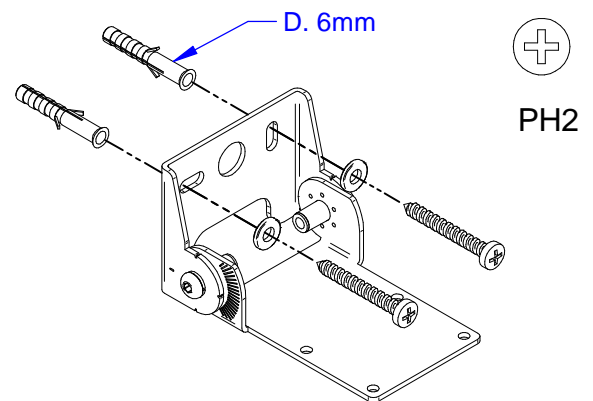
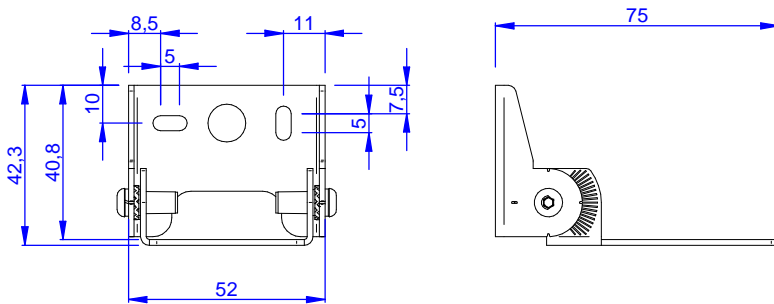

INSTALLAZIONE / INSTALLATION

98949

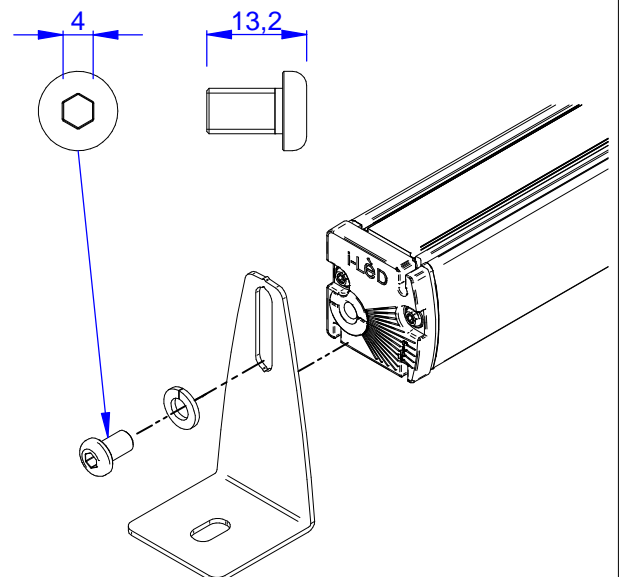
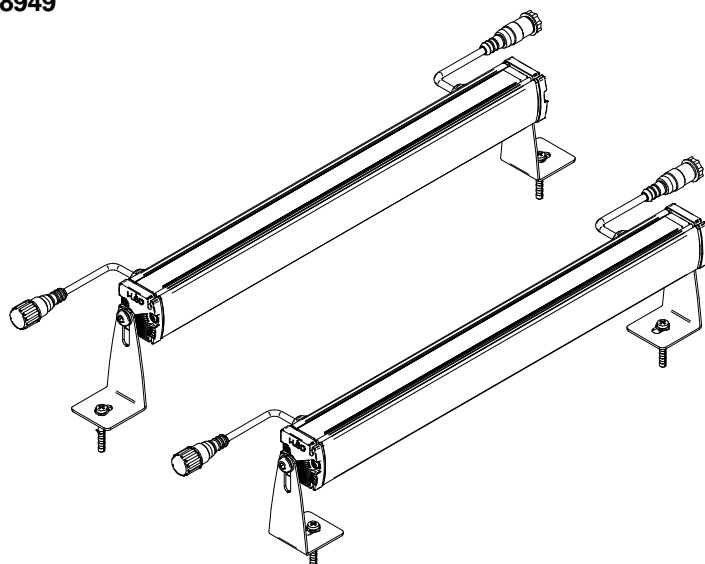

SERIES: XENIA\_W

BRAND: i-LèD

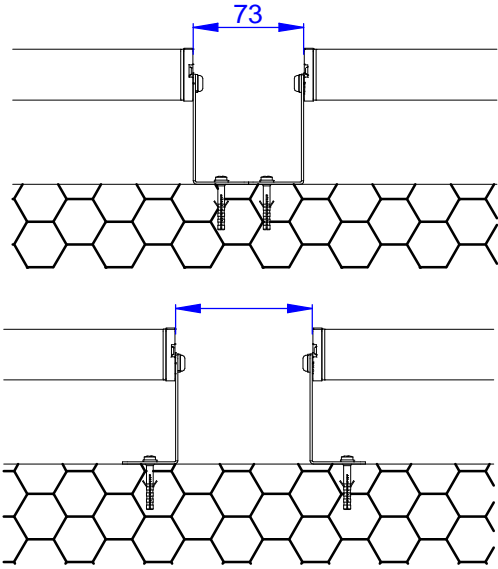

Lasciare lo spazio per l'inserimento della vite + utensile

Consider the screw lenght + tool dimensions

89045 / 89046 / 89047

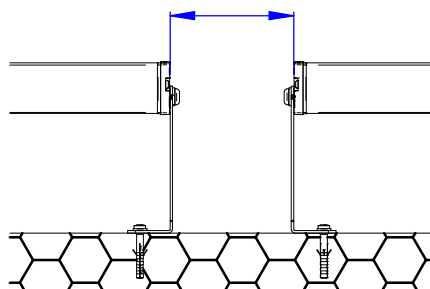
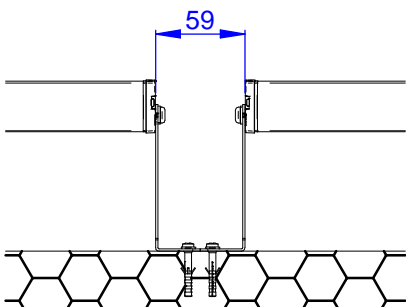
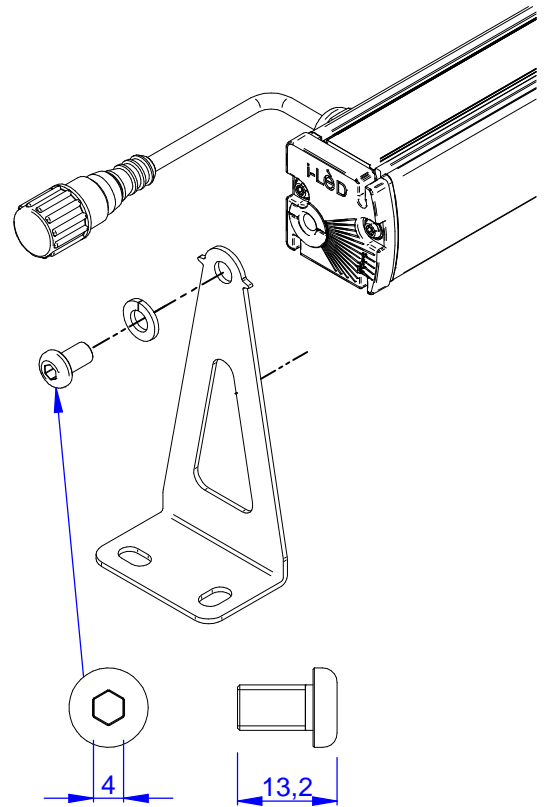
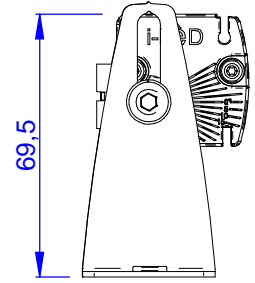
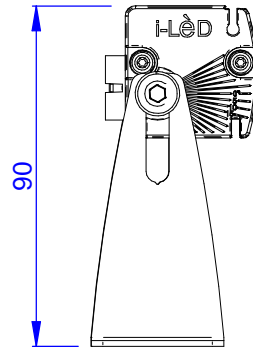
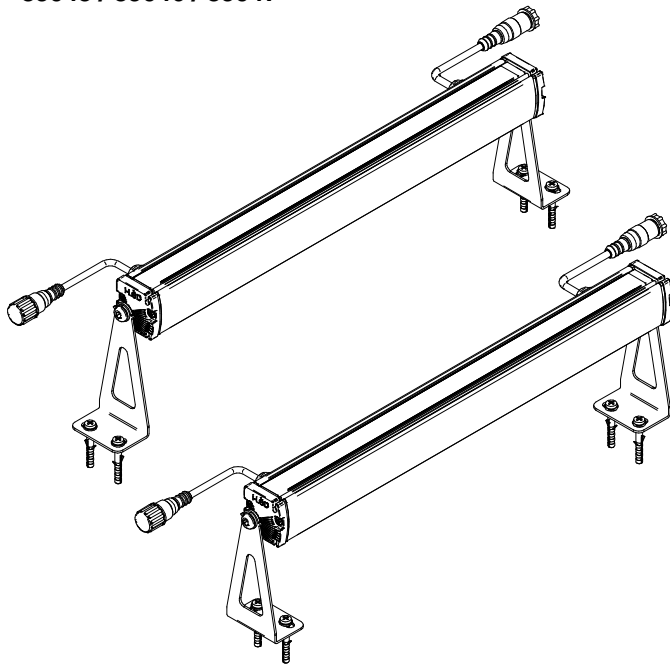

Lasciare lo spazio per l'inserimento della vite + utensile

Consider the screw lenght + tool dimensions

SERIES: XENIA\_W

BRAND: i-LèD

**C-F400006**

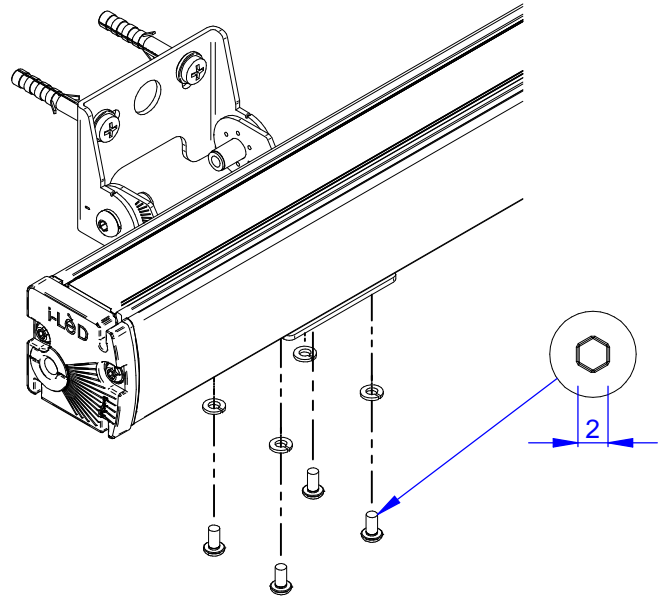
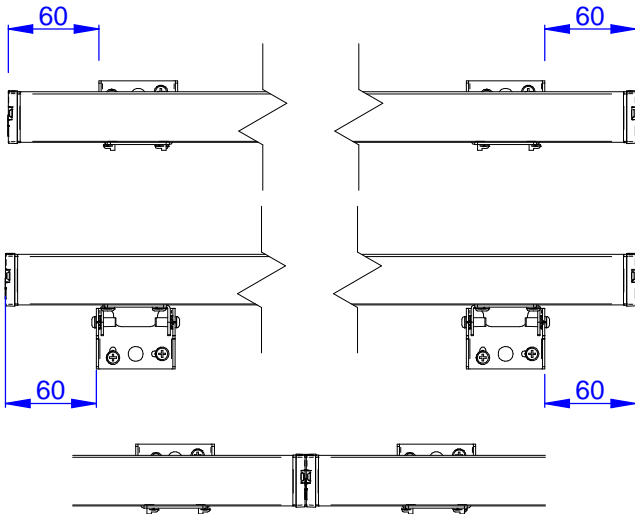

Lasciare uno spazio di qualche millimetro tra una barra e l'altra per permettere la basculazione.  
Leave a few millimeter gap between 2 fixtures to allow the tilting.

**C-F400008**

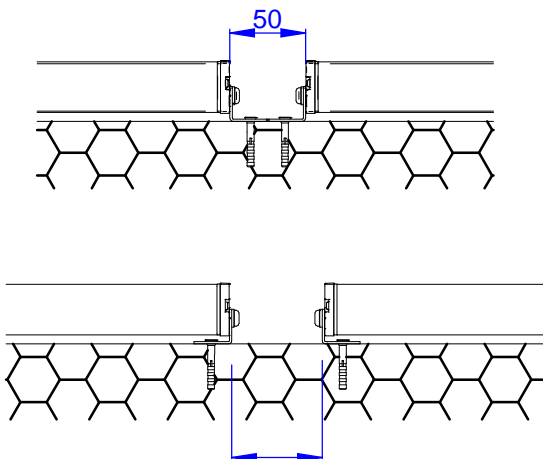
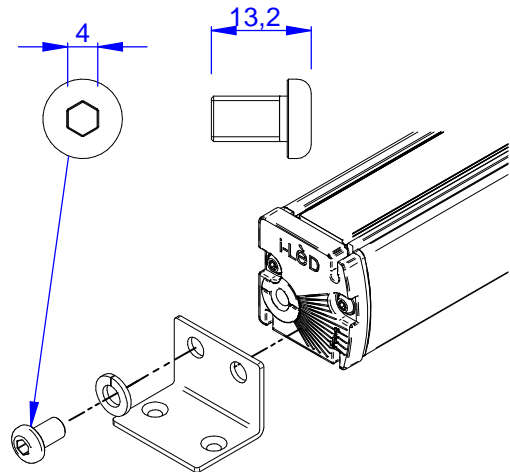
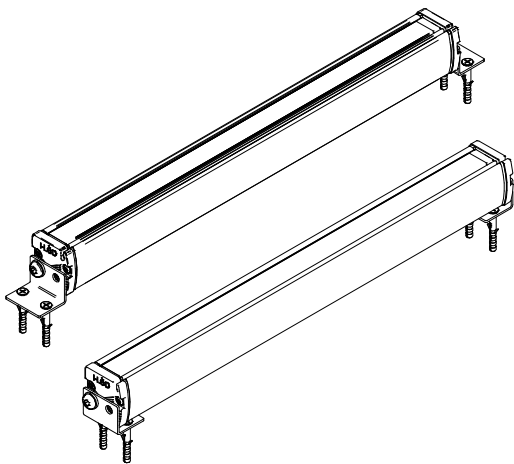

Lasciare lo spazio per l'inserimento della vite + utensile

Consider the screw length + tool dimensions

SERIES: XENIA\_W

BRAND: i-LèD

## ESEMPI DI INSTALLAZIONE INSTALLATION EXAMPLES

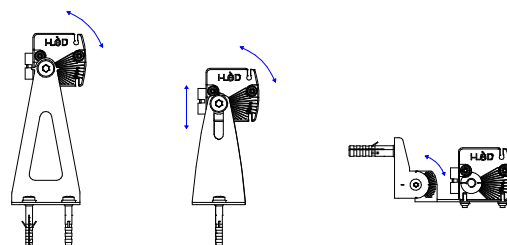
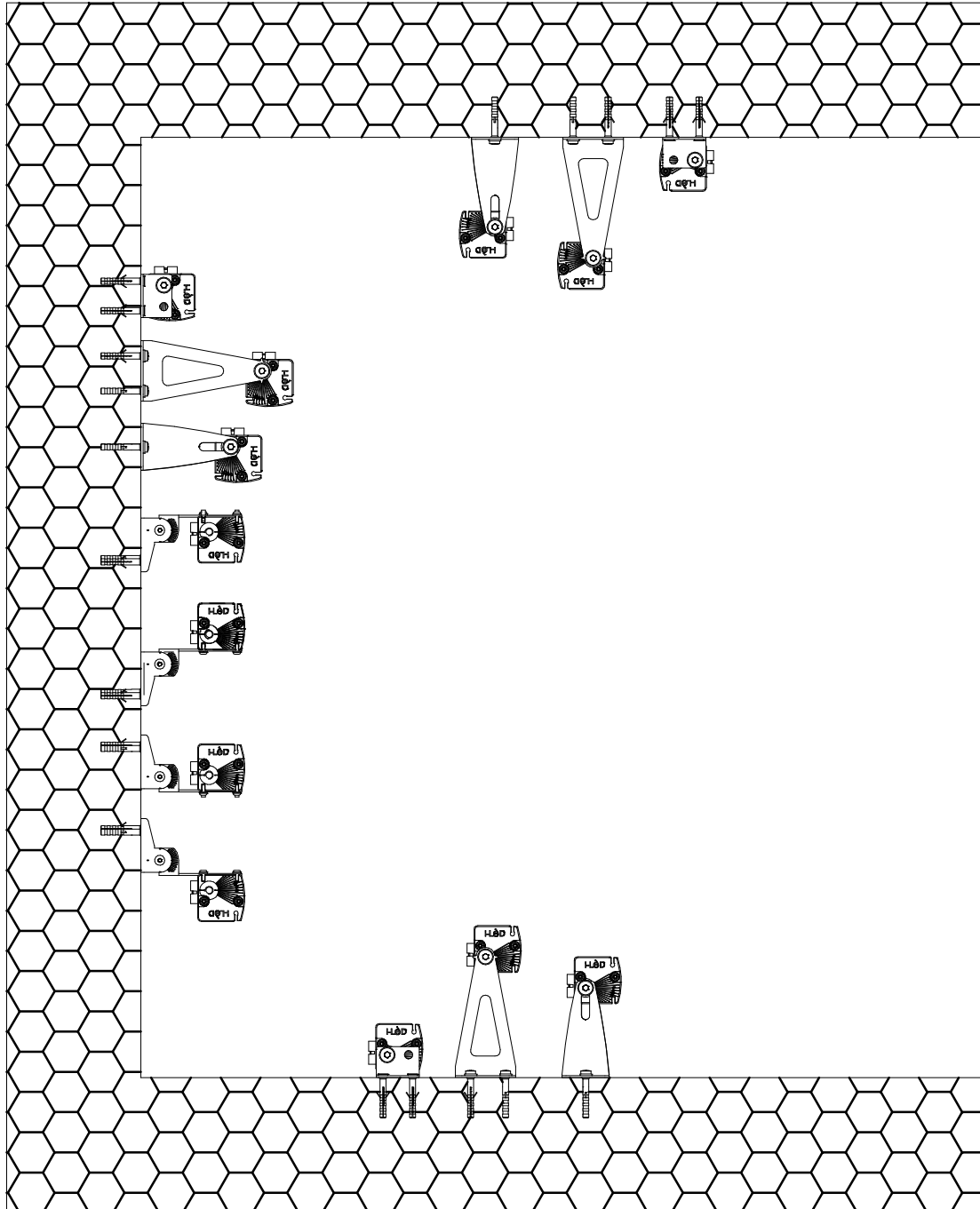

SERIES: XENIA\_W

BRAND: i-LÈD

CABLAGGIO / WIRING

Lunghezza totale linea cavi a massimo carico / Total cables length at maximum load:

SEZIONE/ section	1mm <sup>2</sup>	1,5mm <sup>2</sup>	2,5mm <sup>2</sup>
LUNGHEZZA/ length	35m	55m	90m

Evidenziato in giallo la sezione dei cavi iniziali.

Start cables section highlighted in yellow.

**(ITA)** - Collegare il filo NERO al NEGATIVO dell'alimentatore da 24Vdc. Collegare il filo ROSSO al POSITIVO dell'alimentatore da 24Vdc.

**(ENG)** - Connect BLACK wire to NEGATIVE of the 24Vdc power supply. Connect RED wire to POSITIVE of the 24Vdc power supply.

CAVO ROSSO / red cable = + POSITIVE  
 CAVO NERO / black cable = - NEGATIVE

### DETTAGLIO A IP JUNCTION BOX Parallel Connection

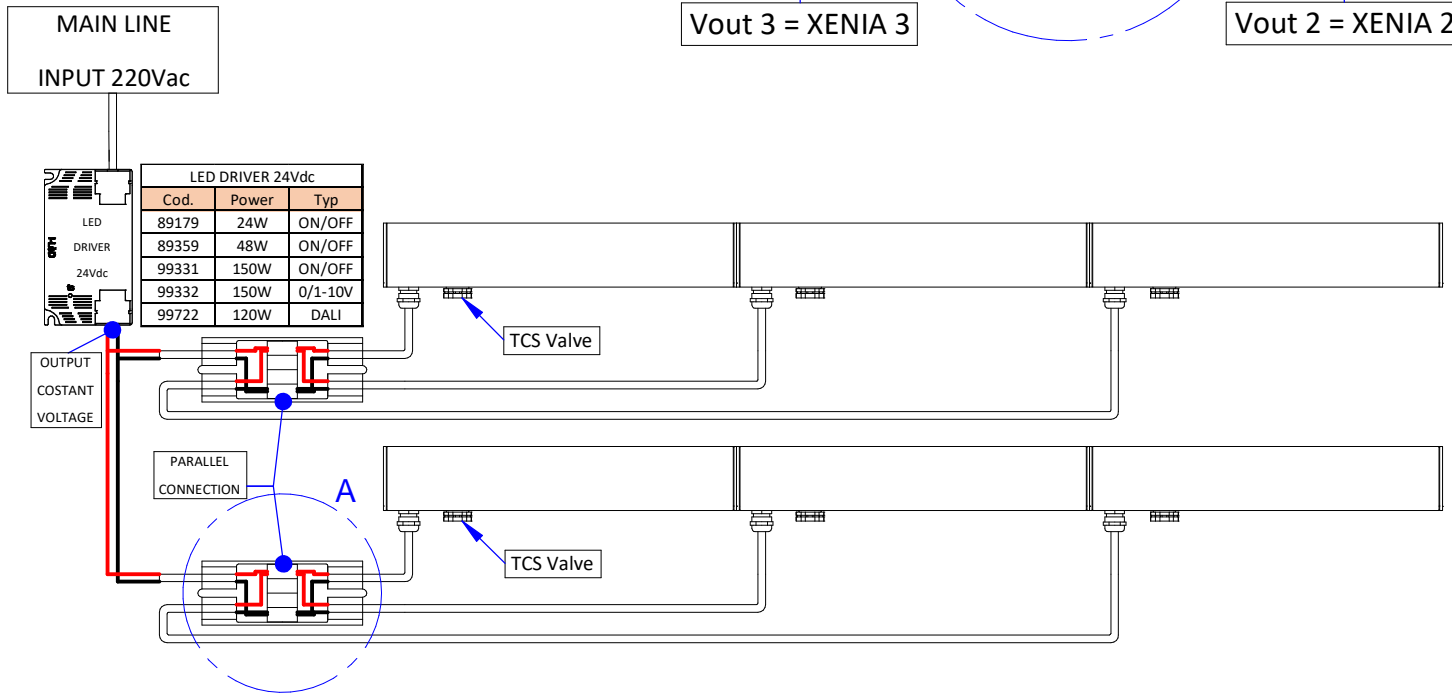
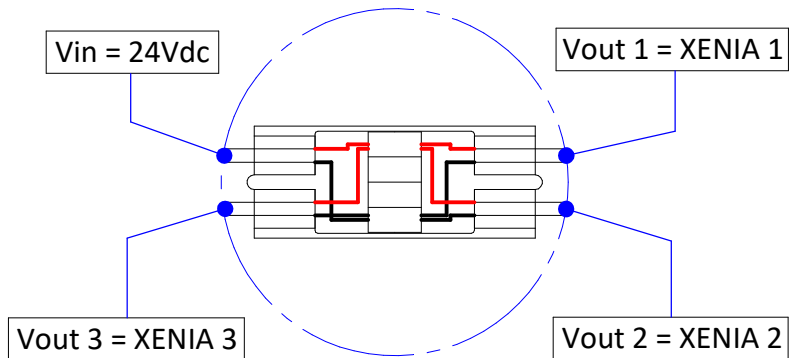

MOD.	COD.	LENGTH mm	MAX N° XENIA COLLEGABLE ON 89179	MAX N° XENIA COLLEGABLE ON 89359	MAX N° XENIA COLLEGABLE ON 99331	MAX N° XENIA COLLEGABLE ON 99332	MAX N° XENIA COLLEGABLE ON 99722
XENIA_W	C00517	366	3	7	23	23	18
	C00518	630	1	3	11	11	9
	C00519	930	1	2	7	7	6
	C00520	1230	/	1	5	5	4
	C00521	1530	/	1	4	4	3



SERIES: XENIA\_W

BRAND: i-LÈD

Lunghezza totale linea cavi a massimo carico / Total cables length at maximum load:

SEZIONE/ section	1mm <sup>2</sup>	1,5mm <sup>2</sup>	2,5mm <sup>2</sup>
LUNGHEZZA/ length	55m	80m	120m

Evidenziato in giallo la sezione dei cavi iniziali.

Start cables section highlighted in yellow.

(ITA) - Collegare il filo NERO al NEGATIVO dell'alimentatore. Collegare il filo ROSSO al POSITIVO dell'alimentatore.

(ENG) - Connect BLACK wire to NEGATIVE of the power supply. Connect RED wire to POSITIVE of power supply.

- CAVO ROSSO / red cable = + POSITIVE
- CAVO NERO / black cable = - NEGATIVE

### DETTAGLIO B IP JUNCTION BOX Series Connection

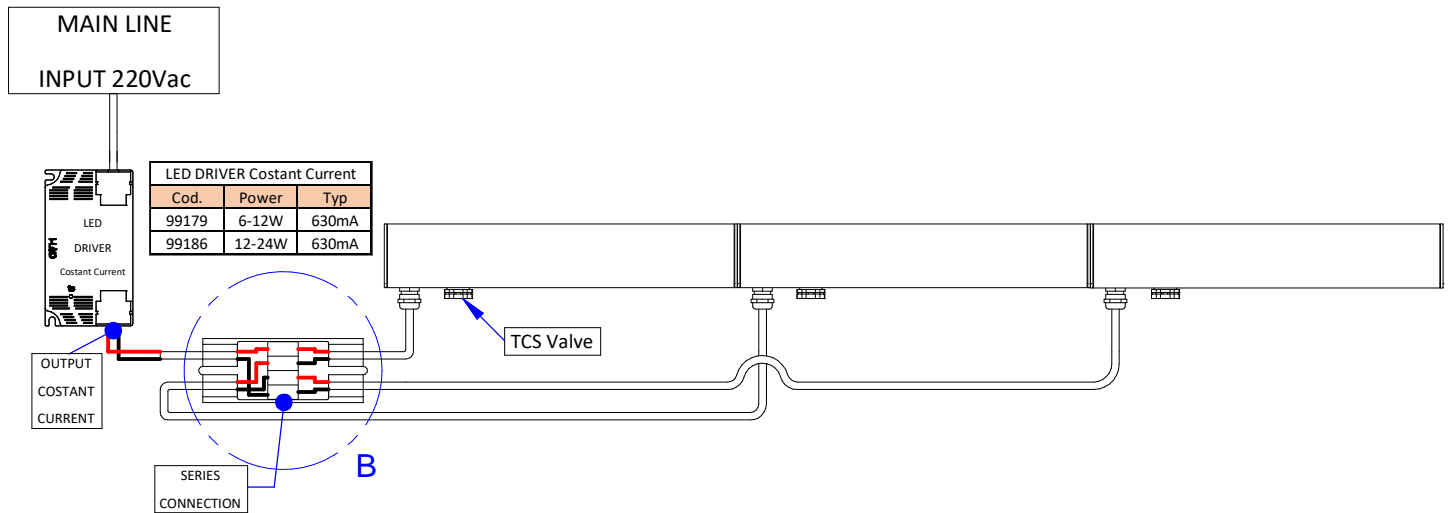
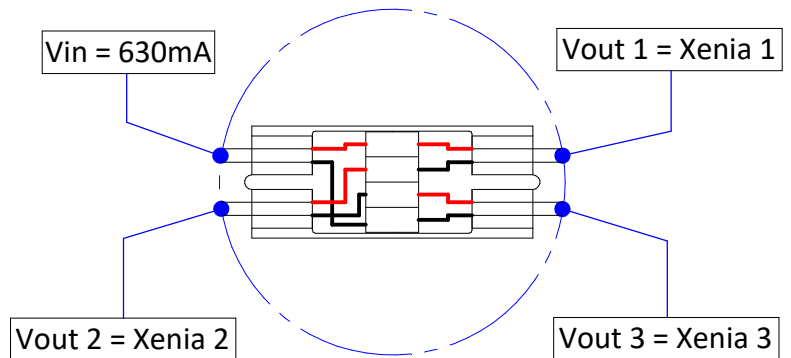

Cod.	Power	Typ
99179	6-12W	630mA
99186	12-24W	630mA

MOD.	COD.	LENGTH mm	N° XENIA COLLEGABLE ON 99179	N° XENIA COLLEGABLE ON 99186
XENIA_W	C00529	366	1-2	2-4
	C00530	630	1	1-2
	C00531	930	/	1
	C00532	1230	/	1

SERIES: XENIA\_W

BRAND: i-LÈD

Lunghezza totale linea cavi a massimo carico / Total cables length at maximum load:

SEZIONE/ section	1mm <sup>2</sup>	1,5mm <sup>2</sup>	2,5mm <sup>2</sup>
LUNGHEZZA/ length	50m	75m	130m

Evidenziato in giallo la sezione dei cavi i-Lèd: cavi iniziali (99216, 89190); estensioni (98437, 98149, 89188).

I-Lèd cables section highlighted in yellow: power cables (99216, 89190); extension (98437, 98149, 89188).

**(ITA)** - Collegare i fili BLU e NERO del 99216 o 89190 al NEUTRO della linea di alimentazione principale. Collegare i fili MARRONE e BIANCO del 99216 o 89190 alla FASE della linea d'alimentazione principale.

**(ENG)** - Connect BLUE and BLACK wires of 99216 or 89190 to the NEUTRAL main power line. Connect BROWN and WHITE wires of 99216 or 89190 to a PHASE main power line.

- CAVO BLU / blue cable = N (NEUTRAL)
- CAVO NERO / black cable = N (NEUTRAL)
- CAVO MARRONE / brown cable = L (PHASE)
- CAVO BIANCO / white cable = L (PHASE)

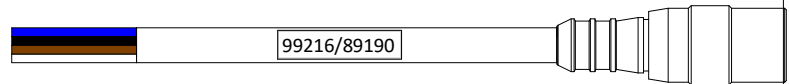

## POWER LINE: MAX 25 LINEAR METERS

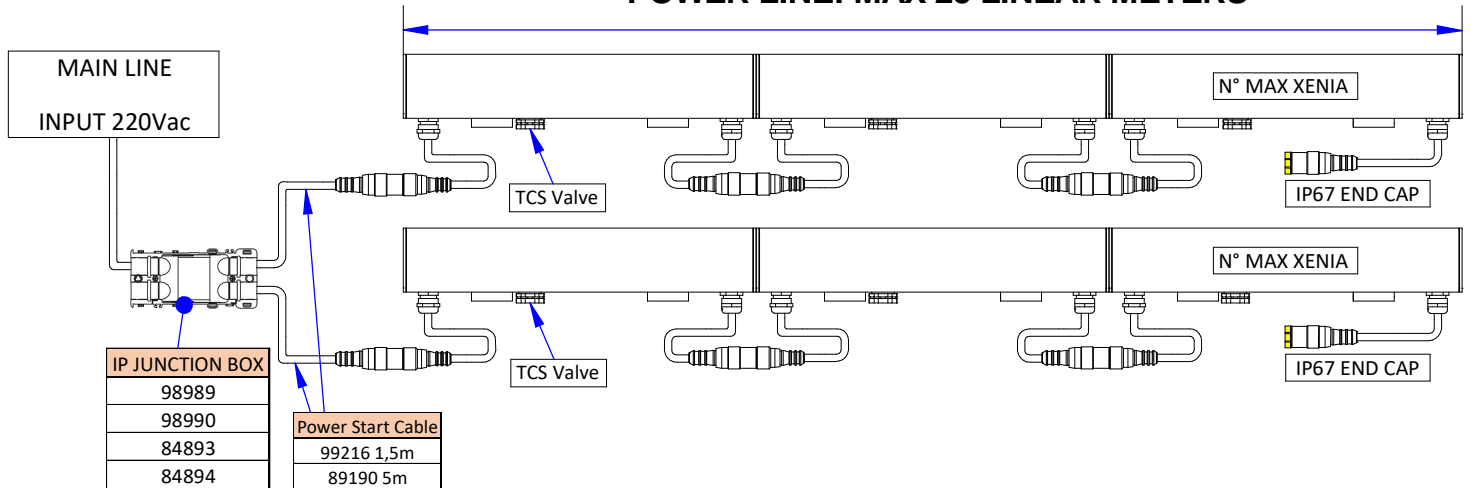

MOD.	COD.	LENGTH mm	MAX N° XENIA COLLEGABLE ON A POWER LINE	MAX XENIA LENGTH COLLEGABLE ON A POWER LINE
XENIA_W	C00522	366	68	25m
	C00523	630	39	
	C00524	930	26	
	C00525	1230	20	
	C00526	1530	16	
XENIA_W PRO	C00534	366	68	
	C00535	630	39	
	C00536	930	26	
	C00537	1230	20	
	C00544	366	68	
	C00545	630	39	
	C00546	930	26	
	C00547	1230	20	
	C00548	1530	16	

SERIES: XENIA\_W

BRAND: i-LèD

Lunghezza totale linea cavi a massimo carico / Total cables length at maximum load:

SEZIONE/ section	1mm <sup>2</sup>	1,5mm <sup>2</sup>	2,5mm <sup>2</sup>
LUNGHEZZA/ length	50m	75m	130m

Evidenziato in giallo la sezione dei cavi I-Lèd: cavi iniziali (C-W200020, C-W200021); estensioni (C-W200022, C-W200023, 83200).

I-Lèd cables section highlighted in yellow: power cables (C-W200020, C-W200021); extension (C-W200022, C-W200023, 83200).

**(ITA)** - Collegare i fili MARRONE e BLU di C-W200020 o C-W200021 rispettivamente a FASE e NEUTRO della linea di alimentazione principale. Collegare i fili BIANCO e NERO di C-W200020 o C-W200021 al bus DALI

- CAVO BLU / blue cable = N (NEUTRAL)
- CAVO MARRONE / brown cable = L (PHASE)
- CAVO BIANCO / white cable = DALI A
- CAVO NERO / black cable = DALI B

**(ENG)** - Connect BROWN and BLUE wires of C-W200020 or C-W200021 respectively to LIVE and NEUTRAL of the mains. Connect WHITE and BLACK wires of C-W200020 or C-W200021 to the DALI bus.

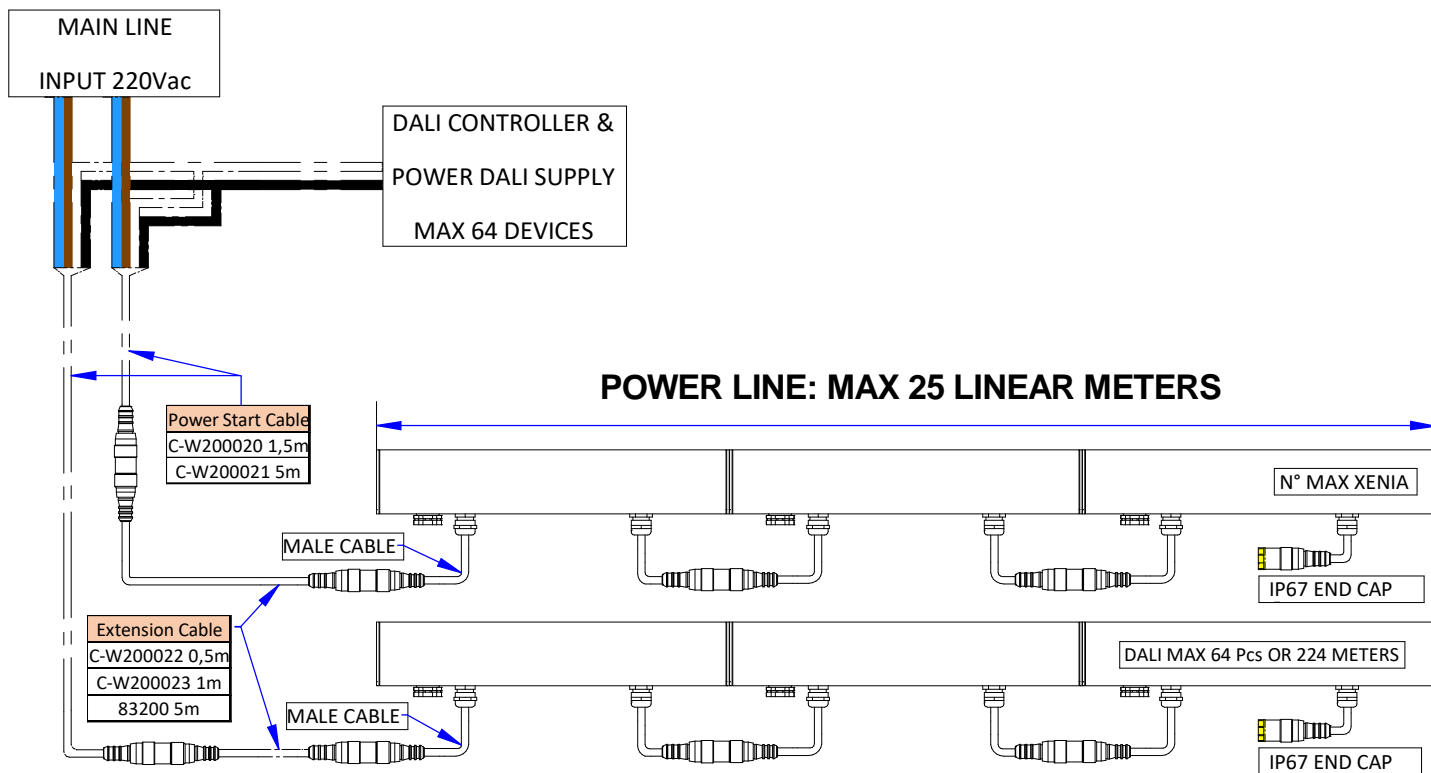
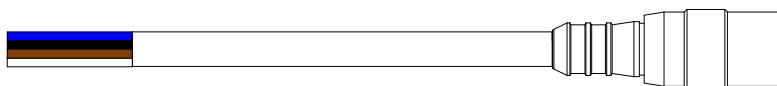

MOD.	COD.	LENGTH mm	MAX N° XENIA COLLEGABLE ON A POWER LINE	MAX LENGTH COLLEGABLE ON A POWER LINE	MAX N° XENIA COLLEGABLE ON A DALI LINE	MAX DALI LINE LENGHT
XENIA_W PRO	C00550	630	39	25m	64	224m
	C00551	930	26			
	C00552	1230	20			
	C00553	1530	16			

SERIES: XENIA\_W

BRAND: i-LèD

Lunghezza totale linea cavi a massimo carico / Total cables length at maximum load:

SEZIONE/ section	1mm <sup>2</sup>	1,5mm <sup>2</sup>	2,5mm <sup>2</sup>
LUNGHEZZA/ length	50m	75m	130m

Evidenziato in giallo la sezione dei cavi I-Lèd: cavi iniziali (99216, 89190); estensioni (98437, 98149, 89188).

I-Lèd cables section highlighted in yellow: power cables (99216, 89190); extension (98437, 98149, 89188).

(ITA) - Schema di collegamento per cavi di alimentazione C-W200013 e C-W200014

(ENG) - Wirind diagram for power cable C-W200013 and C-W200014

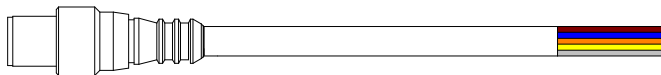

- CAVO BLU / blue cable = N (NEUTRAL)
- CAVO MARRONE / brown cable = L (PHASE)
- CAVO GIALLO / yellow cable = DMX -
- CAVO ARANCIONE / orange cable = DMX +
- CALZA / shield = DMX GND

(ITA) - Schema di collegamento per splitter C-W200018 e C-W200019

(ENG) - Wirind diagram for splitter C-W200018 and C-W200019

- CAVO BLU / blue cable = N (NEUTRAL)
- CAVO MARRONE / brown cable = L (PHASE)
- CAVO BIANCO / white cable = - DMX
- CAVO ROSSO / red cable = + DMX
- CALZA / shield = GND

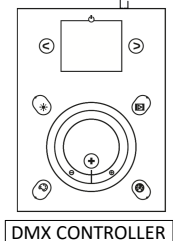
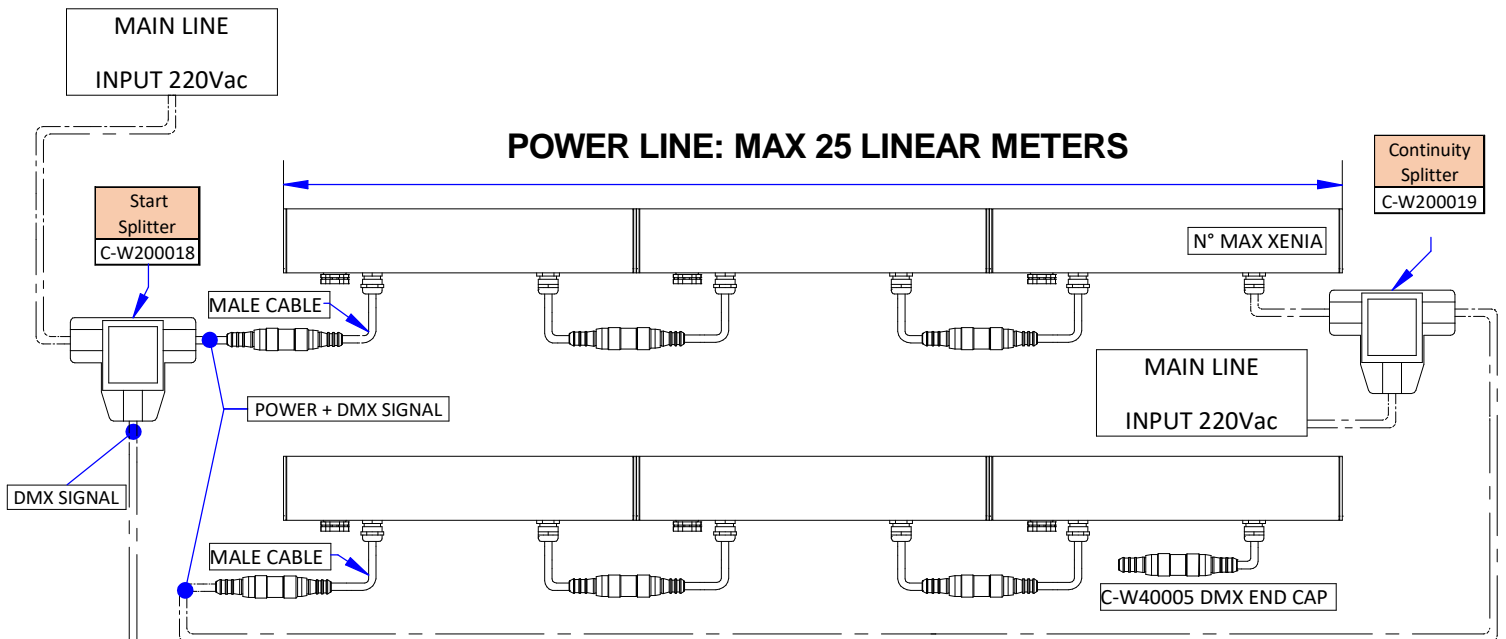

MOD.	TYPE	COD.	LENGTH mm	MAX N° XENIA COLLEGABLE ON A POWER LINE	MAX LENGTH COLLEGABLE ON A POWER LINE	MAX N° XENIA COLLEGABLE ON A DMX LINE	MAX DMX LINE LENGHT
XENIA_W	DMX-RDM	C00527	535	46	25m	32	300m
		C00528	1182	21			
XENIA_W PRO	DMX-RDM	C00554	500	50			
		C00555	1182	21			

SERIES: XENIA\_W

BRAND: i-LèD

**ACCESSORIO ANTI-ABBAGLIAMENTO**

**ANTI-GLARE ACCESSORY**

XENIA\_W / XENIA\_PRO

98782 - 366mm

98783 - 630mm

98784 - 930mm

98785 - 1230mm

99788 - 1530mm

XENIA\_W PRO RGBW

98951 - 500mm

XENIA\_W RGBW

98953 - 535mm

XENIA\_W / XENIA\_W PRO RGBW

98952 - 1182mm

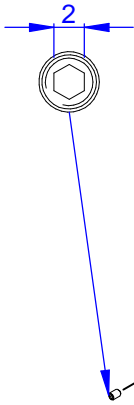
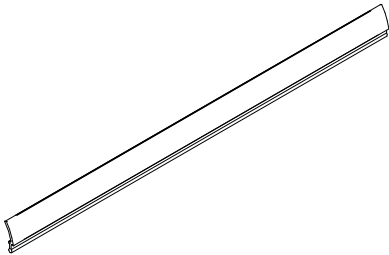

Per l'inserimento dell'accessorio anti-abbagliamento è sufficiente rimuovere uno dei due grani posti sui tappi dell'articolo  
*To install the anti-glare accessory it is necessary to remove only one of the two grub screws placed on the caps of the fixture*

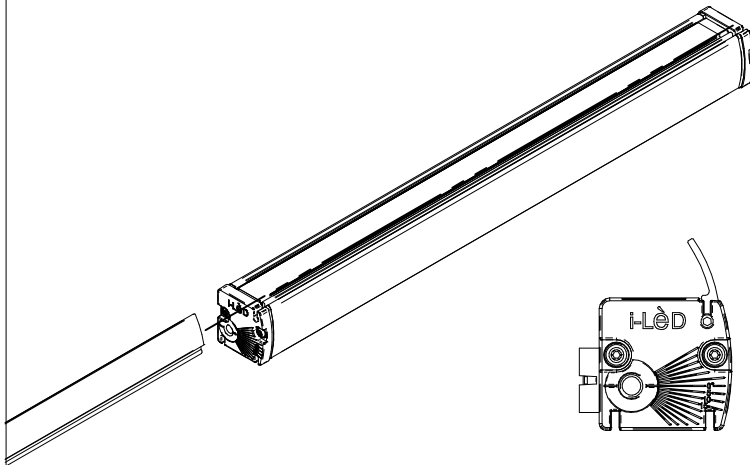

Inserire l'accessorio come indicato in figura  
*Insert the accessory as shown in the picture*

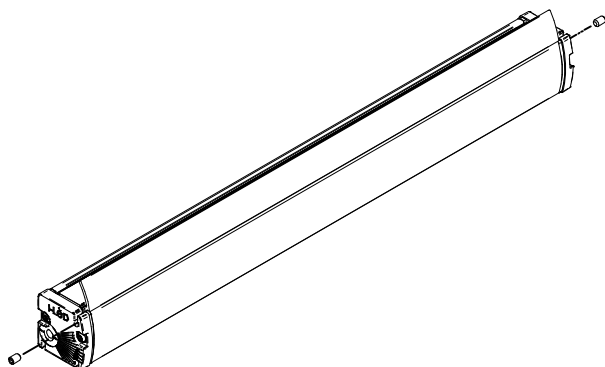

Reinserire il grano rimosso in precedenza. E' possibile agire su entrambi i grani per centrare correttamente l'accessorio sulla barra.  
*Install the previously removed grub screw. Act on both grub screws to properly center the anti-glare accessory on the fixture.*

SERIES: XENIA\_W

BRAND: i-LED

## Cables

### 24V DC / 190-250V AC | Cavi di alimentazione



**BB 99216** Conn. F.4 pin M12 (L 1,5 m)  
**BB 89190** Conn. F.4 pin M12 (L 5 m)  
**suitable for:** Xenia

### 190-250V AC + DMX | Cavi di alimentazione



**BB C-W200013** Conn. F.5 pin M12 (L 1,5 m)  
**BB C-W200014** Conn. F.5 pin M12 (L 5 m)  
**suitable for:** Xenia RGBW DMX/RDM

### 24V DC / 190-250V AC | Cavi di estensione



**BB 98437** Conn. M. + F. 4 pin M12 (L 1 m)  
**BB 98149** Conn. M. + F. 4 pin M12 (L 5 m)  
**BB 89188** Conn. M. + F. 4 pin M12 (L 10 m)  
**suitable for:** Xenia

### 190-250V AC + DMX | Cavi di estensione



**BB C-W200015** Conn. M. + F. 5 pin M12 (L 0,5 m)  
**BB C-W200016** Conn. M. + F. 5 pin M12 (L 1,5 m)  
**BB C-W200017** Conn. M. + F. 5 pin M12 (L 5 m)  
**suitable for:** Xenia RGBW DMX/RDM

### 190-250V AC + DALI | Cavi di alimentazione



**BB C-W200020** Conn. F.4 pin M12 (L 1,5 m)  
**BB C-W200021** Conn. F.4 pin M12 (L 5 m)  
**suitable for:** Xenia DALI

### 190-250V AC + DALI | Cavi di estensione



**BB C-W200022** Conn. M.+F 4 pin M12 (L 0,5 m)  
**BB C-W200023** Conn. M.+F 4 pin M12 (L 1,5 m)  
**BB 83200** Conn. M.+F 4 pin M12 (L 5 m)  
**suitable for:** Xenia DALI

### 190-250V AC + DMX | Splitter



**BB C-W200018** Start splitter  
**BB C-W200019** Continuity splitter  
**suitable for:** Xenia RGBW DMX/RDM

Pag. 972



**BB C-W400005** DMX line closure adapter  
**suitable for:** Xenia

Pag. 972

Xenia RGBW

① 2x1 mm<sup>2</sup> (for power supply)

② 2x0,25 mm<sup>2</sup> (for DMX) +shield

③ ALLinONE F

2x1 mm<sup>2</sup> +  
2x0,2 mm<sup>2</sup> +shield

**C-W200018**

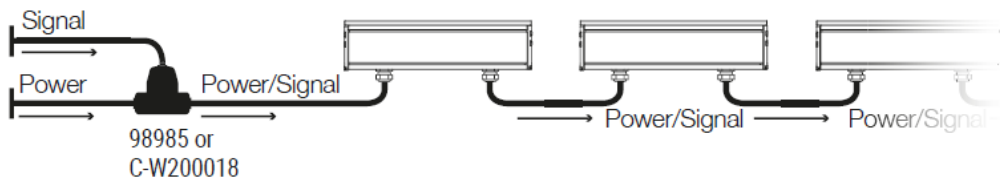

Xenia RGBW

① ALLinONE M  
2x1 mm<sup>2</sup> + 2x0,2 mm<sup>2</sup> +shiel

② 2x1 mm<sup>2</sup> (for power supply)

③ ALLinONE F

2x1 mm<sup>2</sup> +  
2 x 0,2 mm<sup>2</sup> +shield

**C-W200019**

