

Code	Length	Type
C00137WHMDI	2,5m	2700K
C00137WHWDI	2,5m	3000K
C00137WHNDI	2,5m	4000K

Code	Length	Type
C00138WHMDI	5m	2700K
C00138WHWDI	5m	3000K
C00138WHNDI	5m	4000K

Code	Length	Type
C00139WHMDI	10m	2700K
C00139WHWDI	10m	3000K
C00139WHNDI	10m	4000K

1

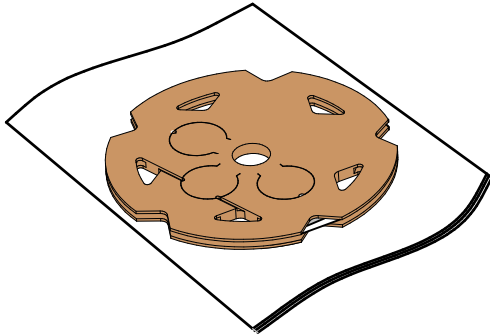

2

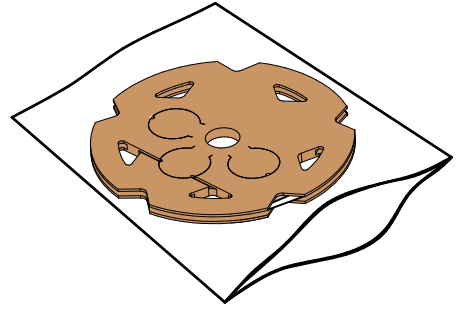

3

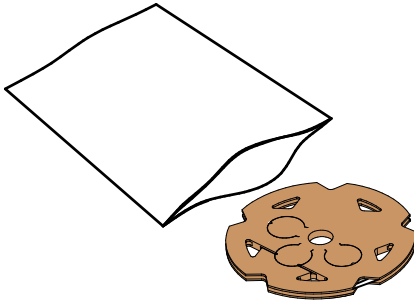

4



5

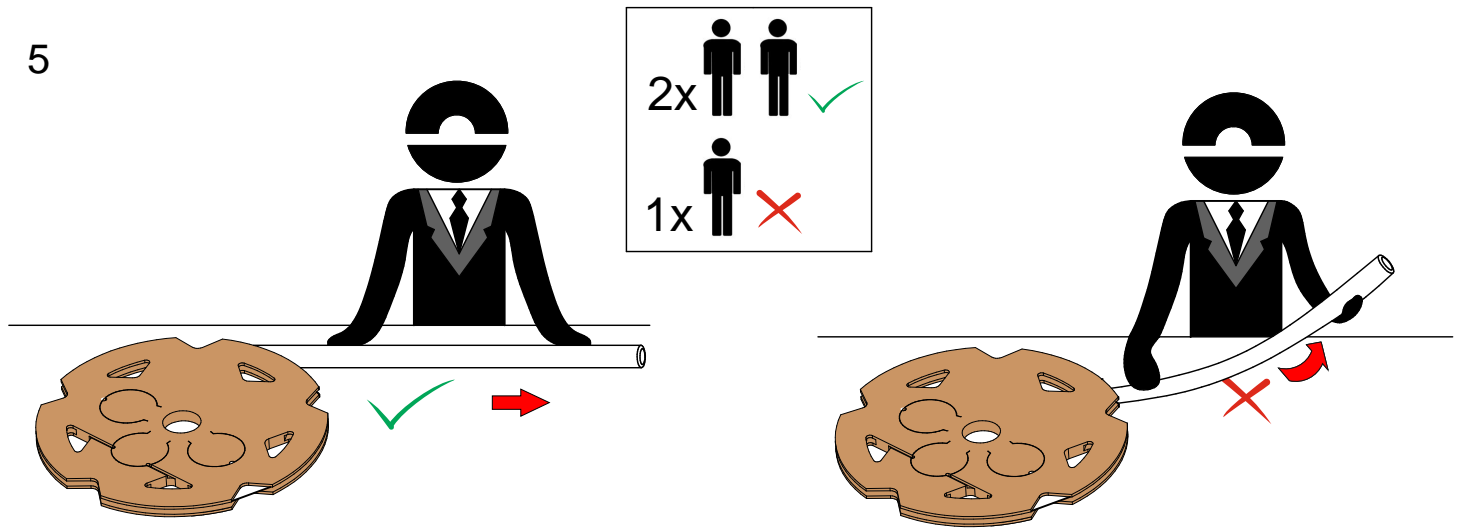

6

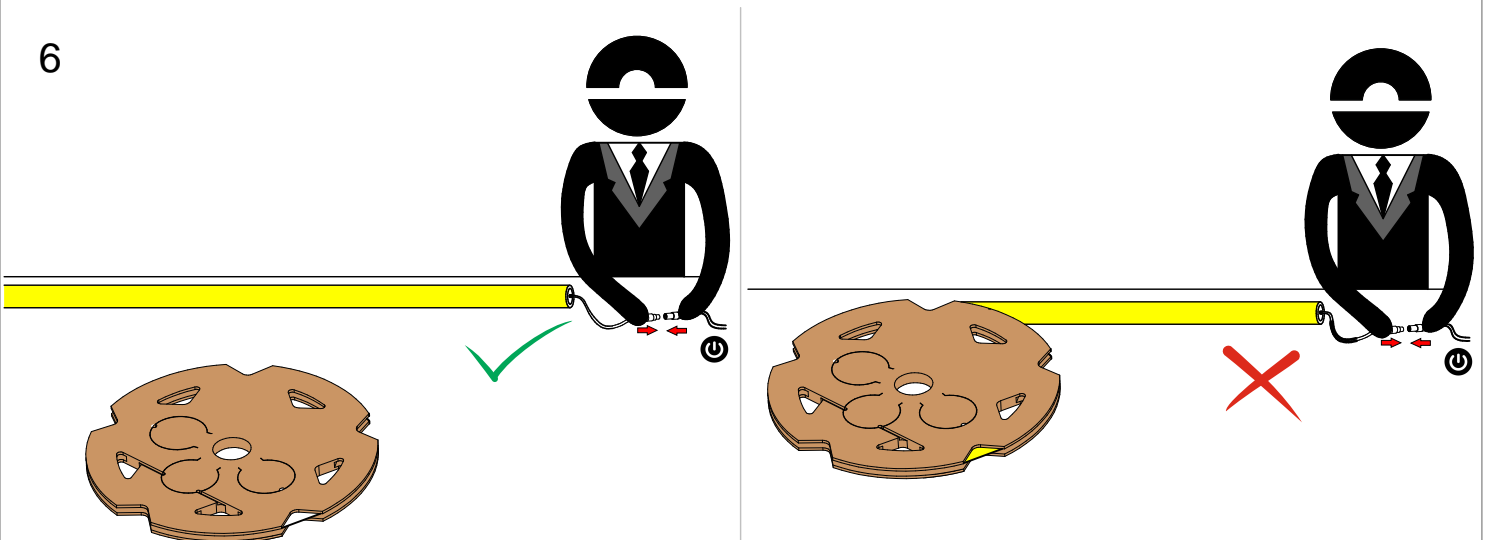

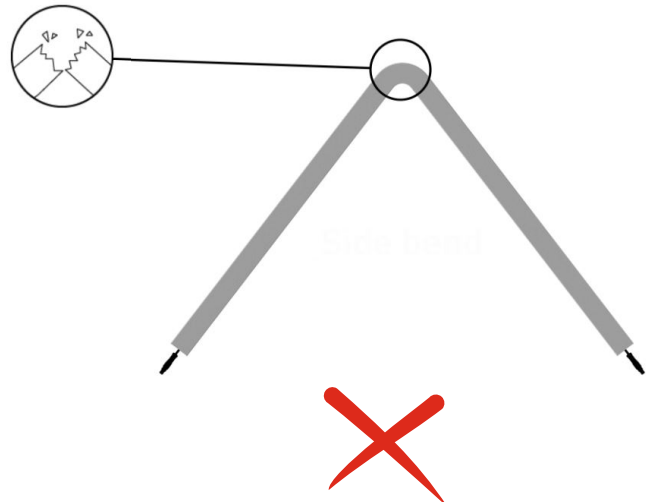
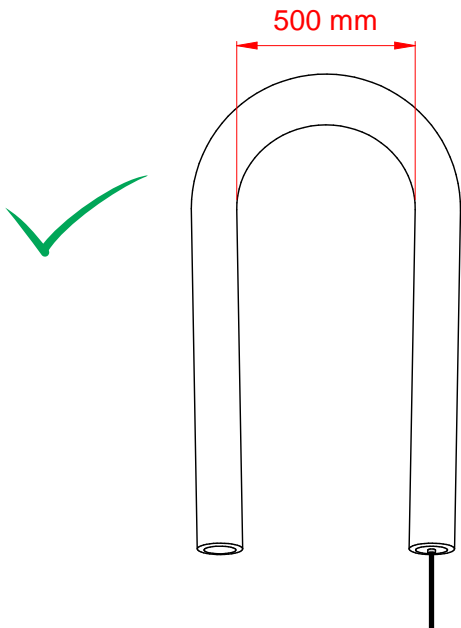
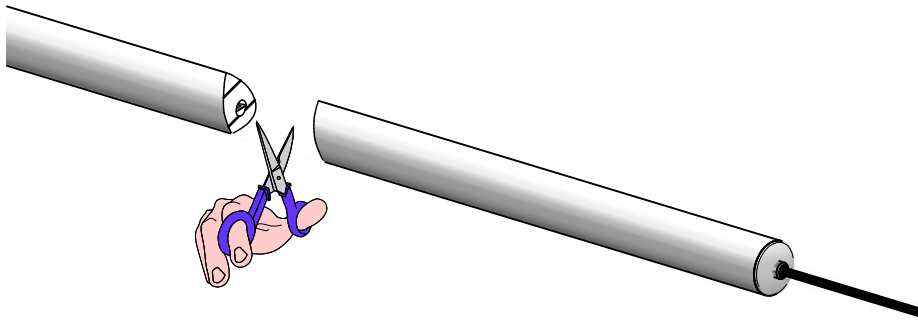
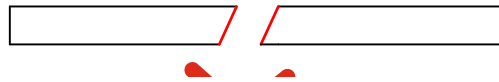
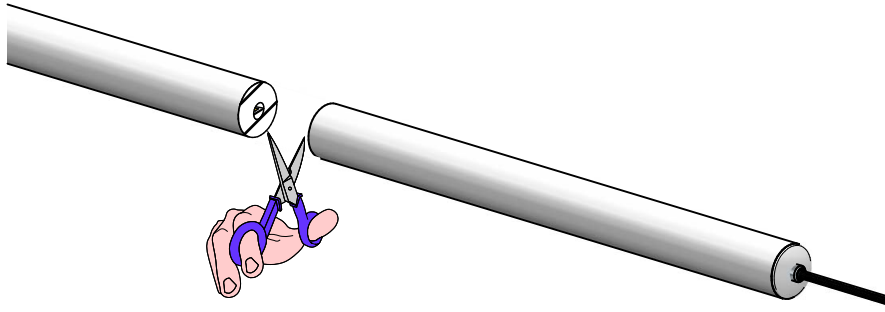
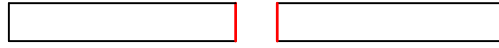
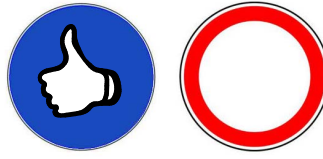

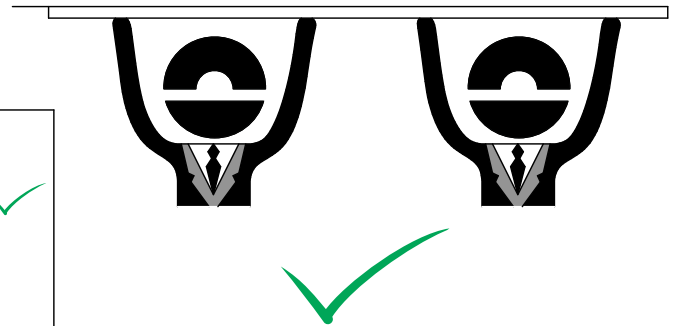
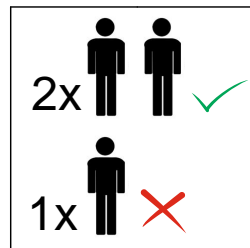
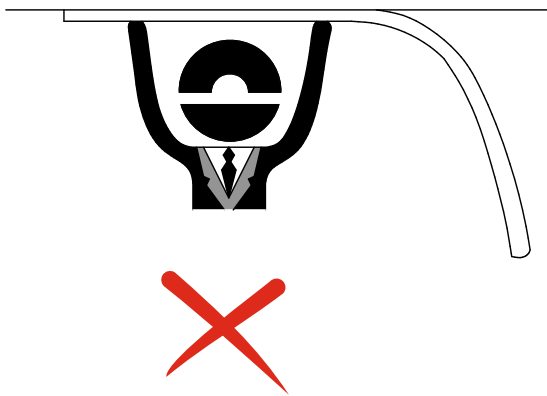
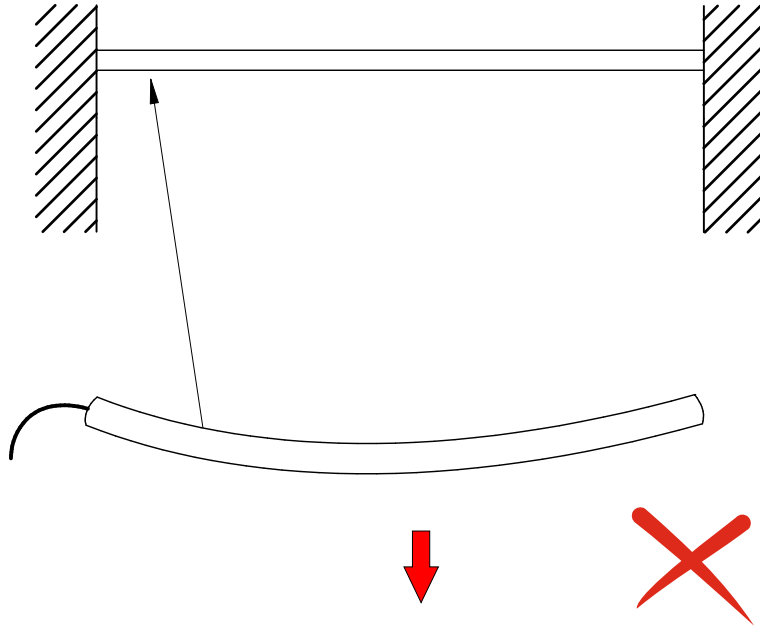
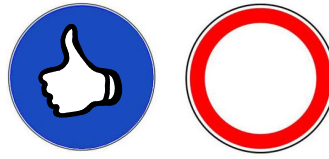

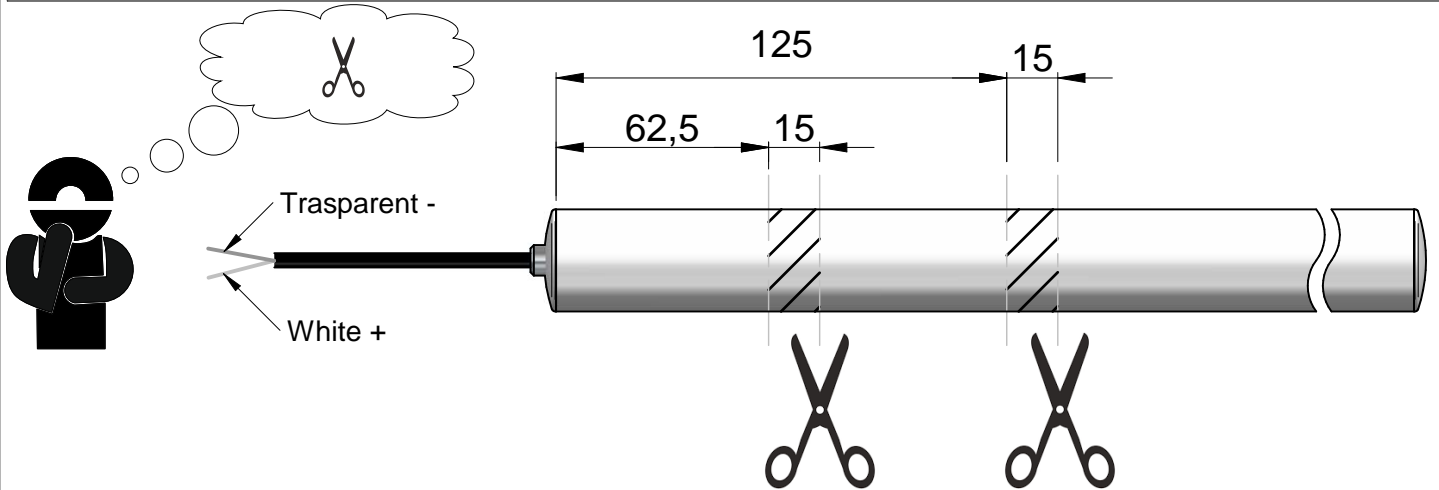

C-K400076
Kit not included

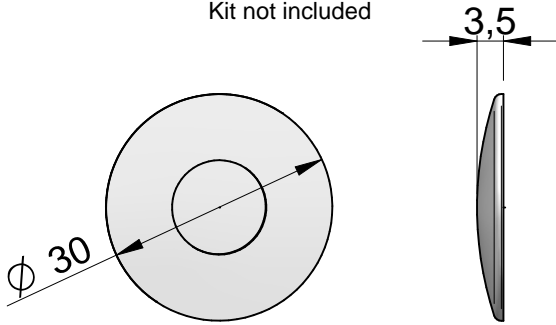

1

Kit not included
C-K400080

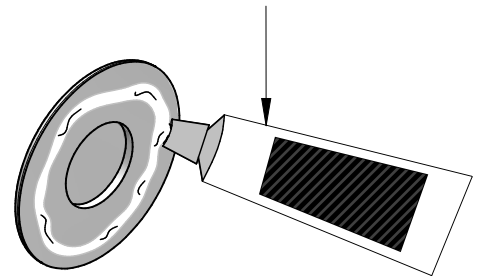

2

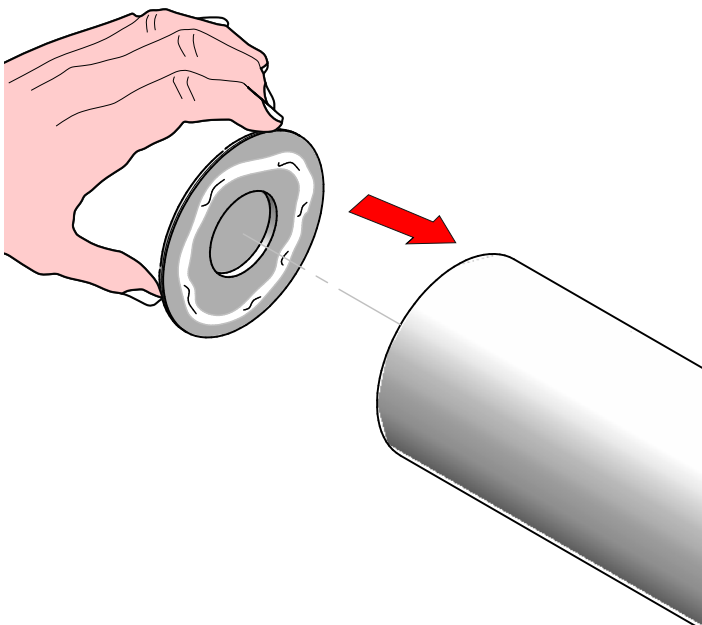

3

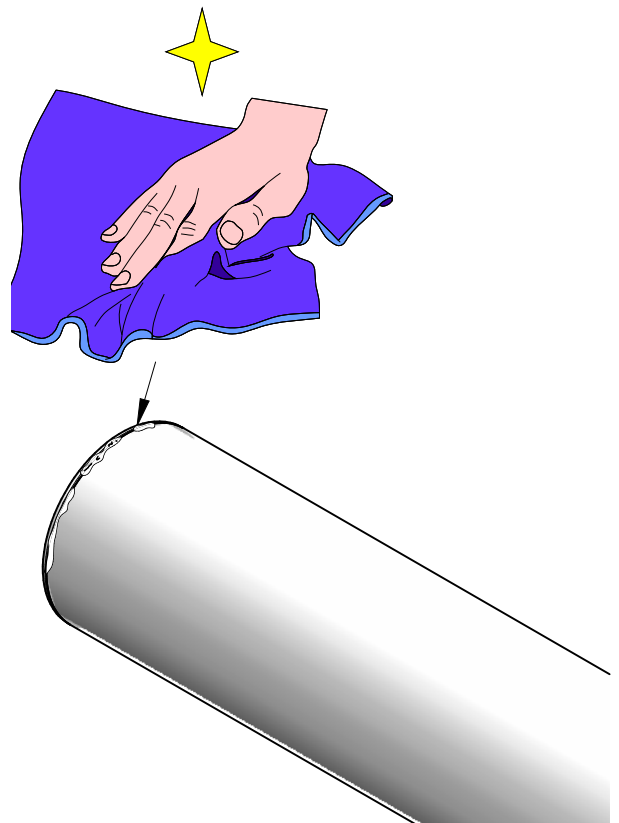

RUBBER O30
rev:0

C-K400077
Kit not included

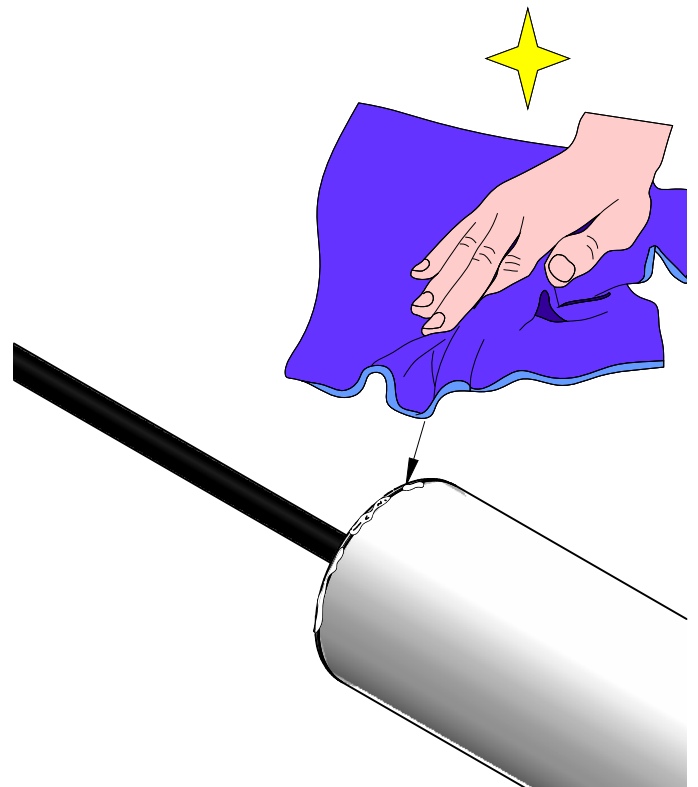
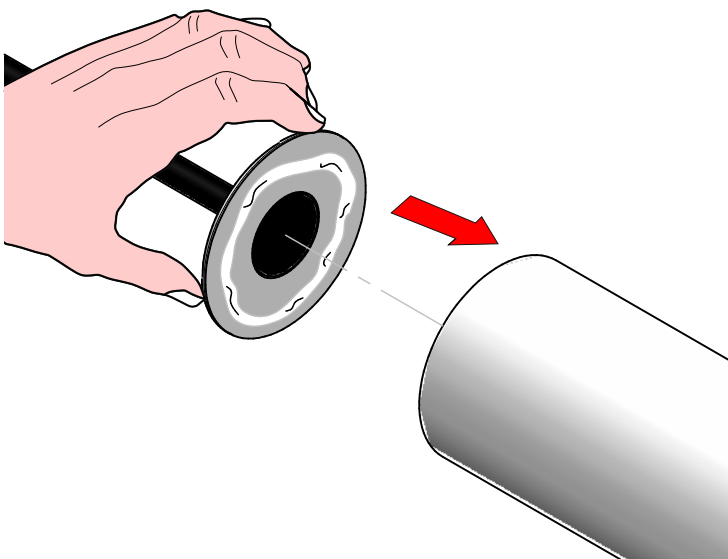
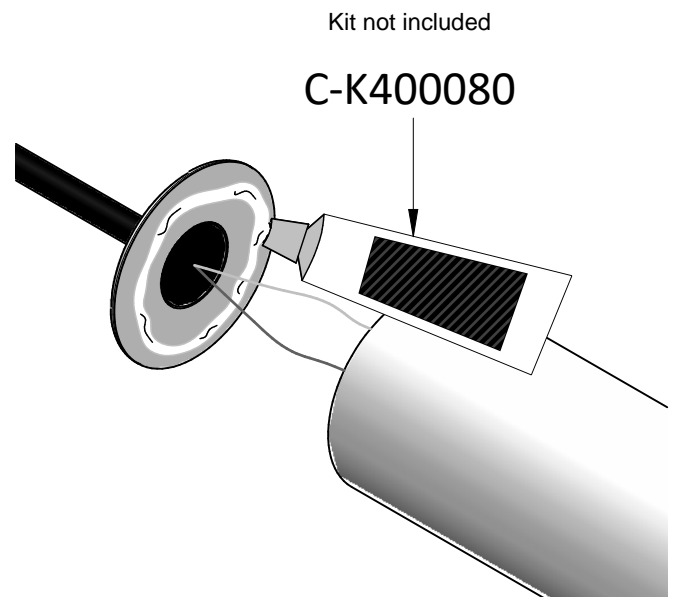
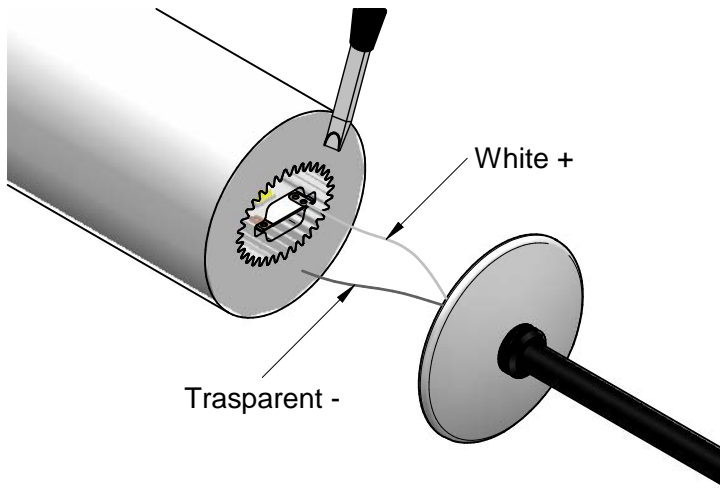
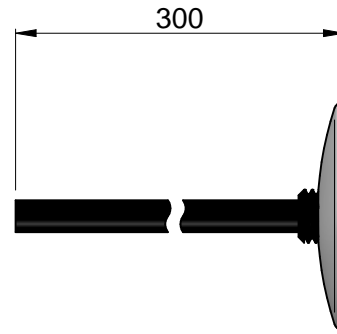
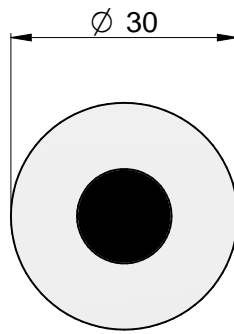

Posizionare il cellofan e
tenderla per tenere saldo il tappo,
finchè la colla si asciugherà

Place the cellophane and
pull it to hold the cap firmly in place,
until the glue dries

Legen Sie das Zellophan ein und
ziehen Sie daran, um die Kappe fest zu halten,
bis der Kleber trocknet

Placez la cellophane et tirez-la pour maintenir
le bouchon fermement en place.
Tirez dessus pour maintenir le
bouchon fermement en place,
jusqu'à ce que la colle sèche

Rimuovere il cellofan dopo
8 ORE di asciugatura

Remove cellophane after
8 hour of drying

Entfernen Sie das Zellophan nach
8 STUNDEN Trocknungszeit

Retirer la cellophane après
8 HEURES de séchage

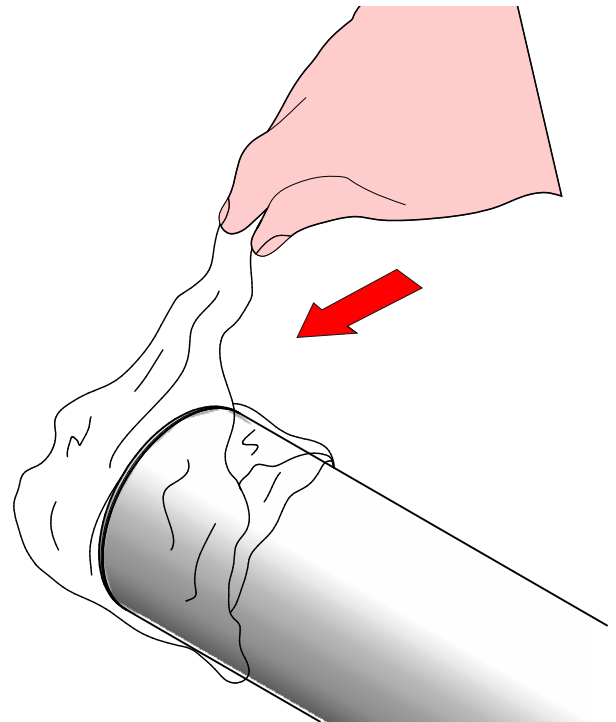
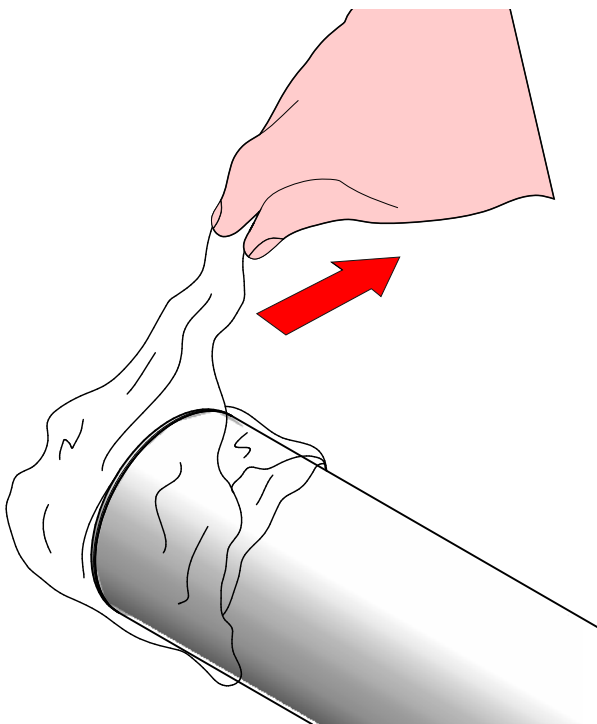

Cellophane not included

Single color

	Xmm	L1 max	L2 max
	0,75	35m	5m
	0,75	20m	10m
	1,5	50m	5m
	1,5	40m	10m
	2,5	50m	5m
	2,5	40m	10m

$$L2 = L3 + L4$$

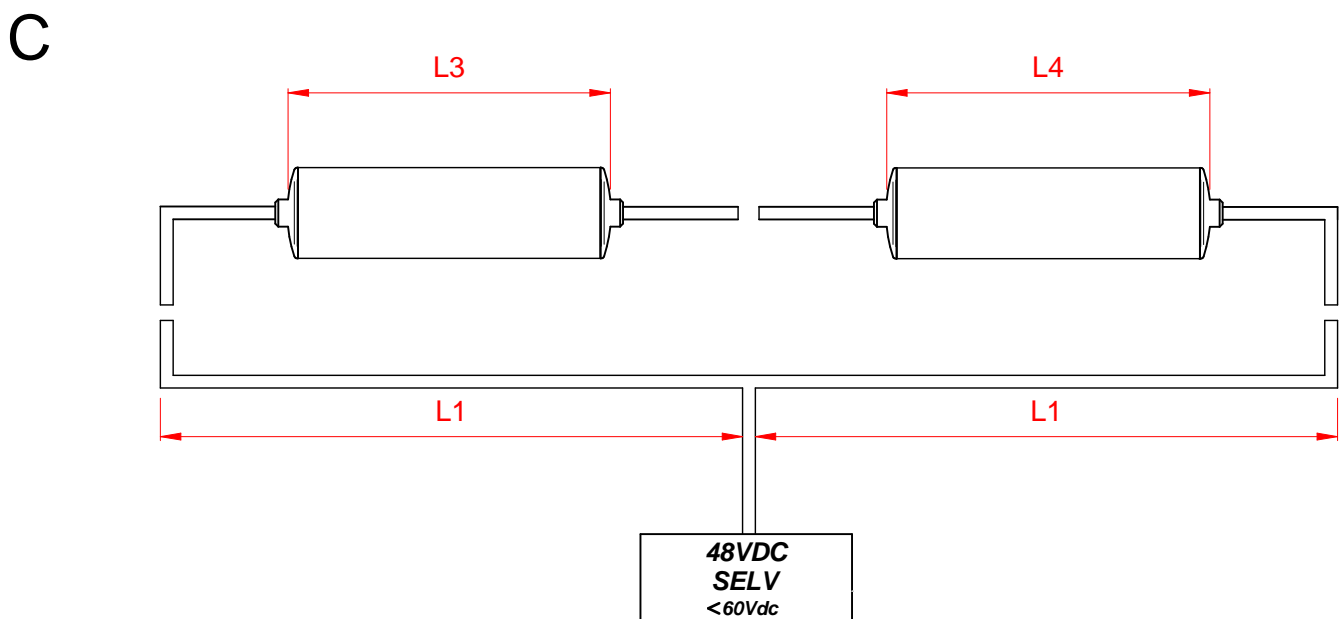
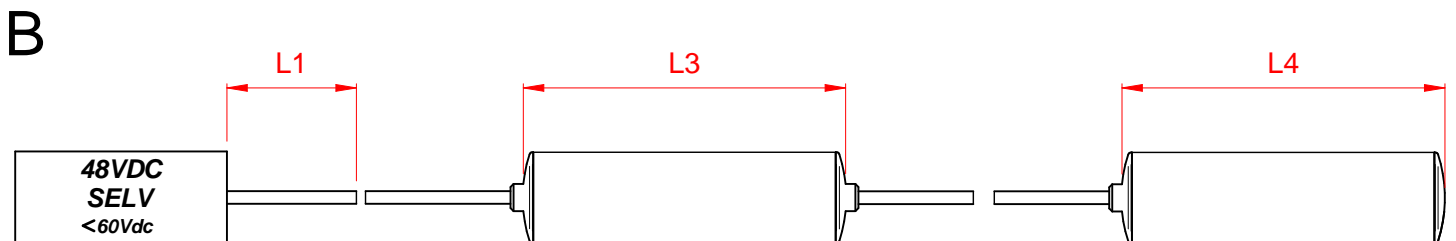
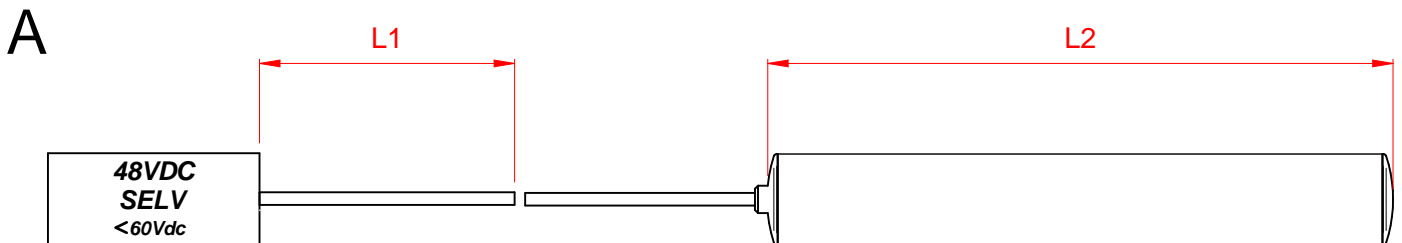

ISTRUZIONI PER IL LAVAGGIO DELL'APPARECCHIO D'ILLUMINAZIONE
LUMINAIRE CARE INSTRUCTIONS
ISTRUCCIONES PARA LIMPIAR LA LUMINARA
INSTRUCTIONS POUR LE LAVAGE DE L'APPAREIL D'ECLAIRAGE
ANLEITUNG ZUR REINIGUNG DES BELEUCHTUNGSGERATS

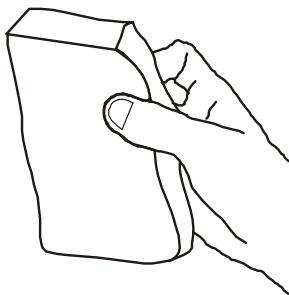
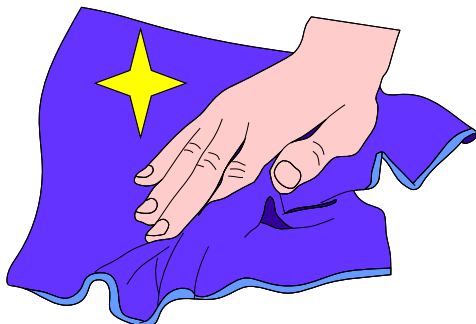

IT - ATTENZIONE!!!

Lavare la superficie del diffusore luce con panno umido, utilizzando solo acqua e sapone neutro.

EN - WARNING!!!

Wipe clean with a cloth dampened in water with neutral detergent.

ES - ATENCION!!!

Limpie la superficie del difusor con un pano humedecido con agua y jabon neutro.

FR - ATTENTION!!!

Laver la surface du diffuseur de lumiere a l'aide d'un chiffon humide et en utilisant seulement de l'eau et du savon neutre.

DE - ACHTUNG!!!

Die oberfläche vom lampenschirm mit einem feuchten lappen reinigen. De lappen mit wasser und neutralseife befeuchten.

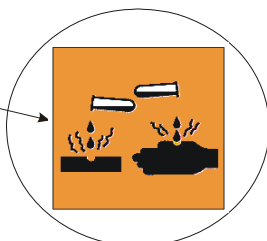
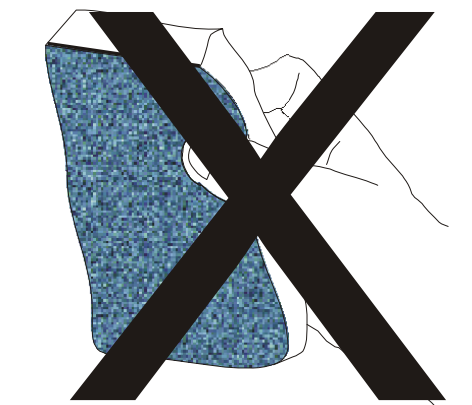

IT - ATTENZIONE!!!

Non utilizzare panni abrasivi e/o solventi.

EN - WARNING!!!

Avoiding the use of chemical solvents and/or abrasive cloths.

ES - ATENCION!!!

No utilizar panos abrasivos y solventes.

FR - ATTENTION!!!

Ne pas utiliser de chiffons abrasifs ou de dissolvants.

DE - ACHTUNG!!!

Abschleifende tuche und/oder losungsmittel nicht benutzen.