

Code	Rubber length	Cable length	Type
C00129WHADI	1m	5m	2200K
C00129WHMDI	1m	5m	2700K
C00129WHWDI	1m	5m	3000K
C00129WHTDI	1m	5m	3500K
C00129WHNDI	1m	5m	4000K
C00129WHVDI	1m	5m	RGBW

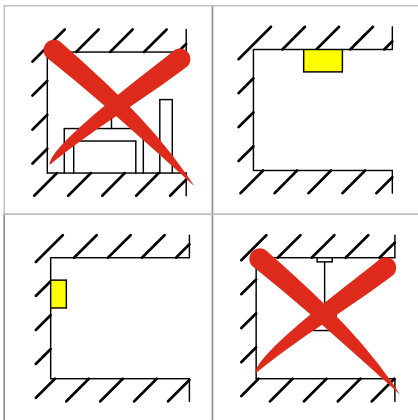

Code	Rubber length	Cable length	Type
C00130WHADI	5m	10m	2200K
C00130WHMDI	5m	10m	2700K
C00130WHWDI	5m	10m	3000K
C00130WHTDI	5m	10m	3500K
C00130WHNDI	5m	10m	4000K
C00130WHVDI	5m	10m	RGBW

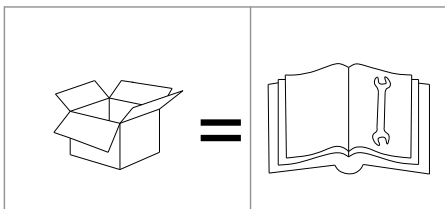

Code	Rubber length	Cable length	Type
C00131WHADI	10m	10m	2200K
C00131WHMDI	10m	10m	2700K
C00131WHWDI	10m	10m	3000K
C00131WHTDI	10m	10m	3500K
C00131WHNDI	10m	10m	4000K

1

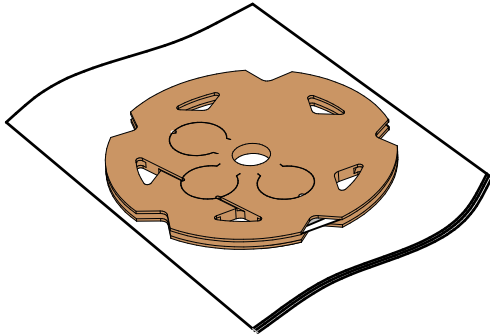

2

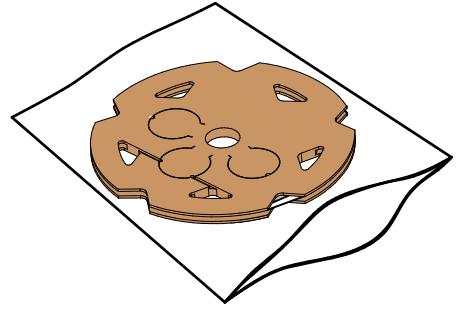

3

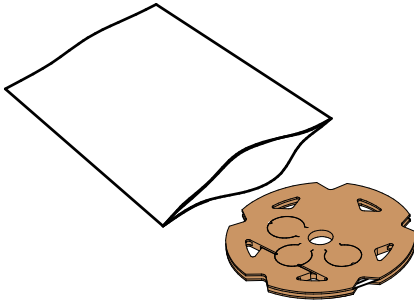

4



5

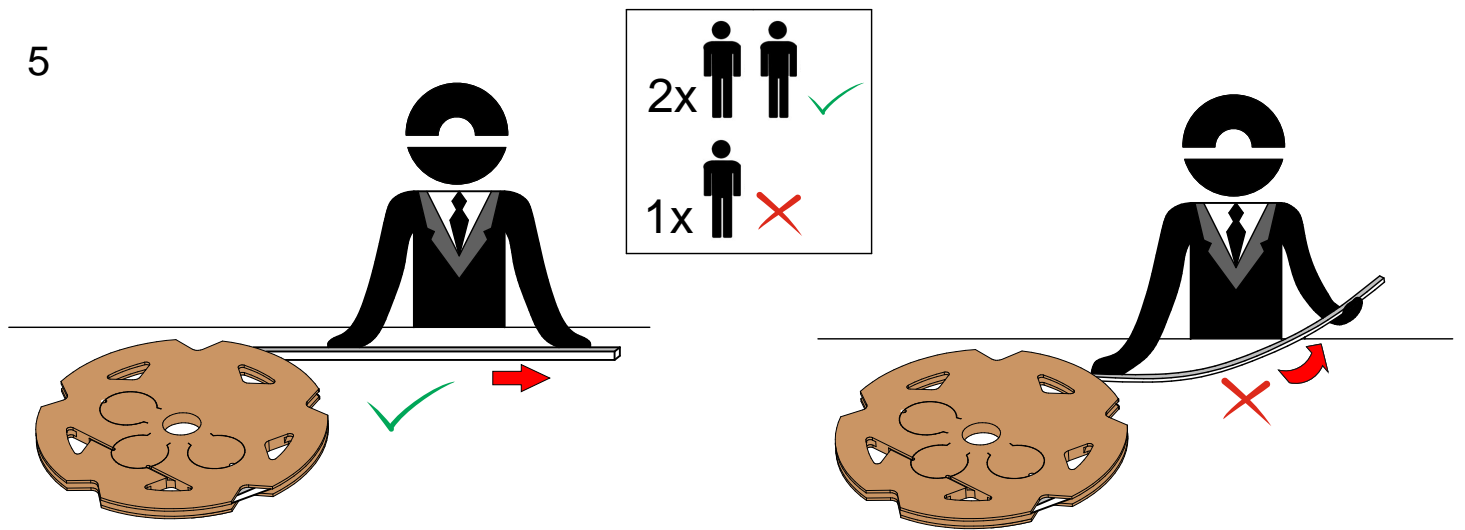

6

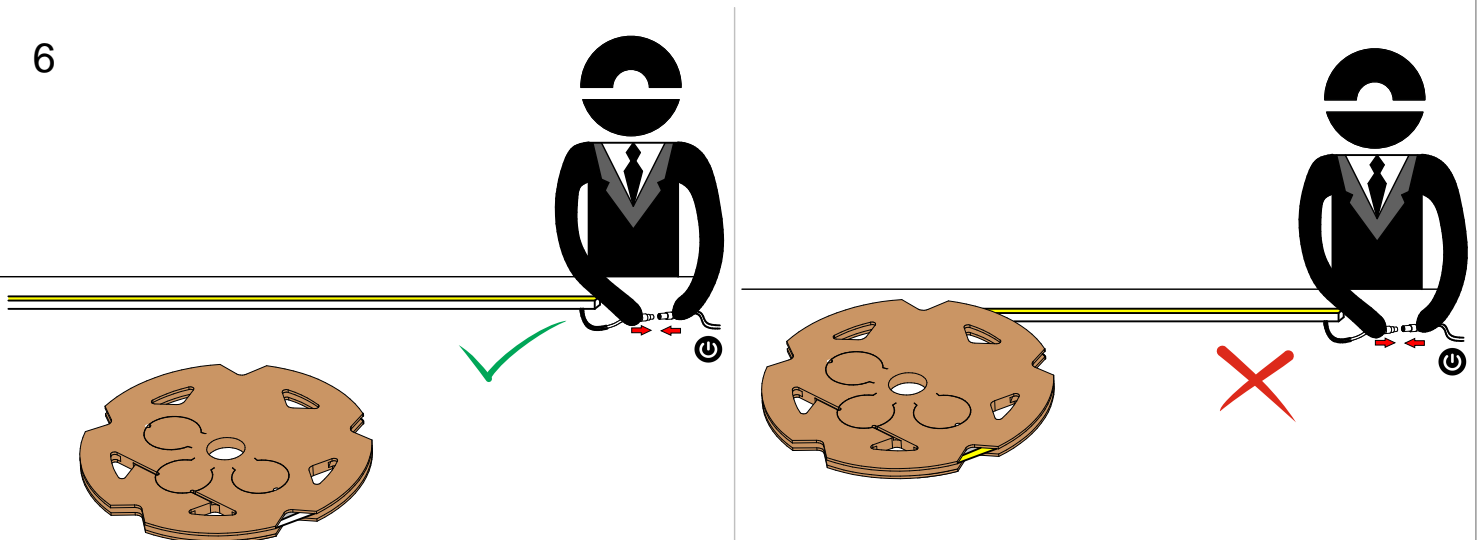

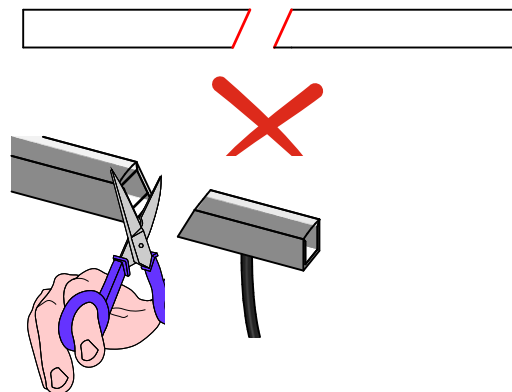

-Non è possibile eseguire il taglio sulla Rubber,
questa azione può compromettere la garanzia dell'articolo

-Cutting on the Rubber is not possible,
this action may compromise the guarantee of the article

-Das Schneiden auf dem Gummi ist nicht möglich,
diese Aktion kann die Garantie des Artikels beeinträchtigen

-Il n'est pas possible de couper le caoutchouc,
cette action peut compromettre la garantie de l'article

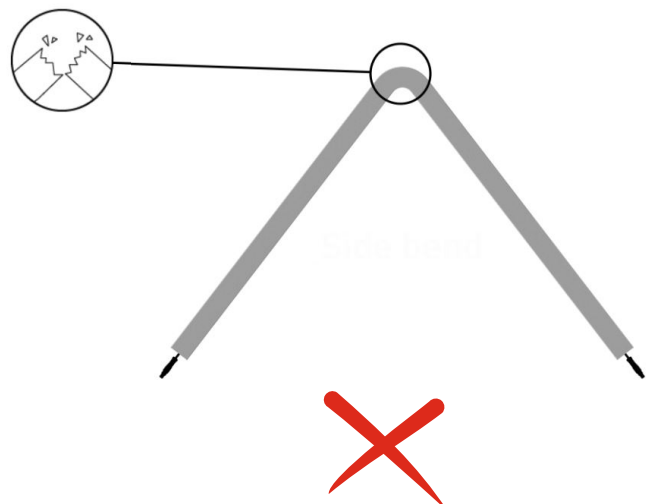
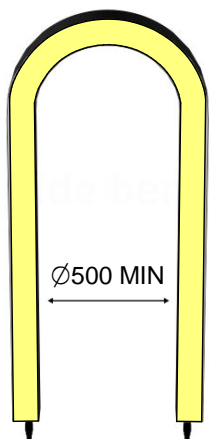

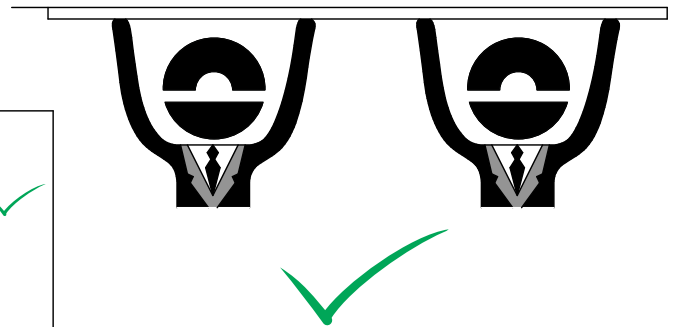
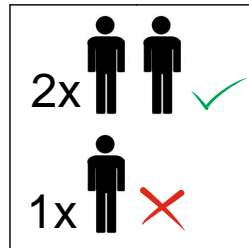
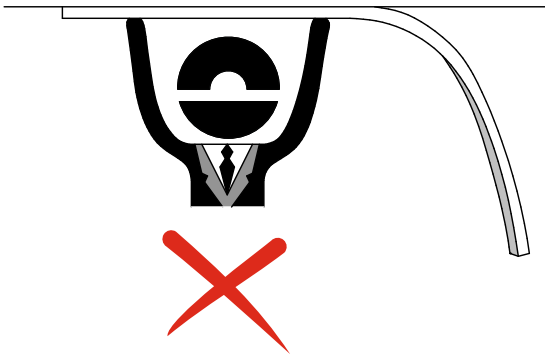
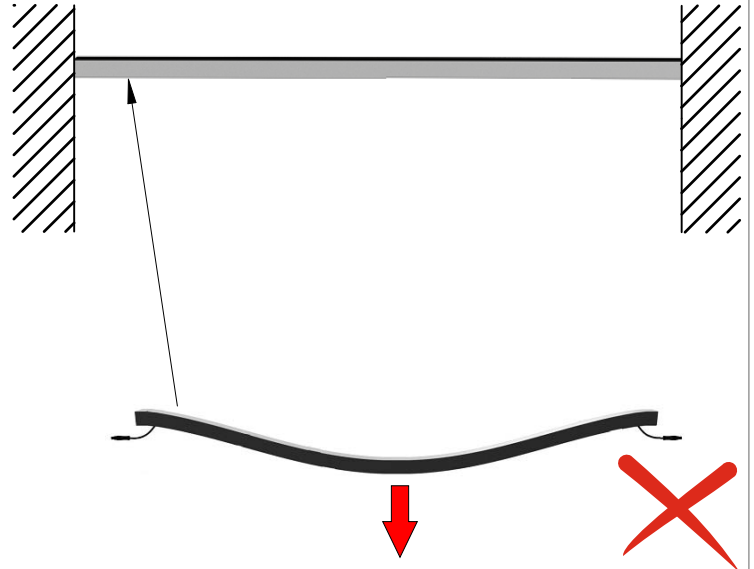
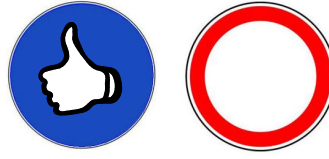

$X \leq 3 \text{ m}$

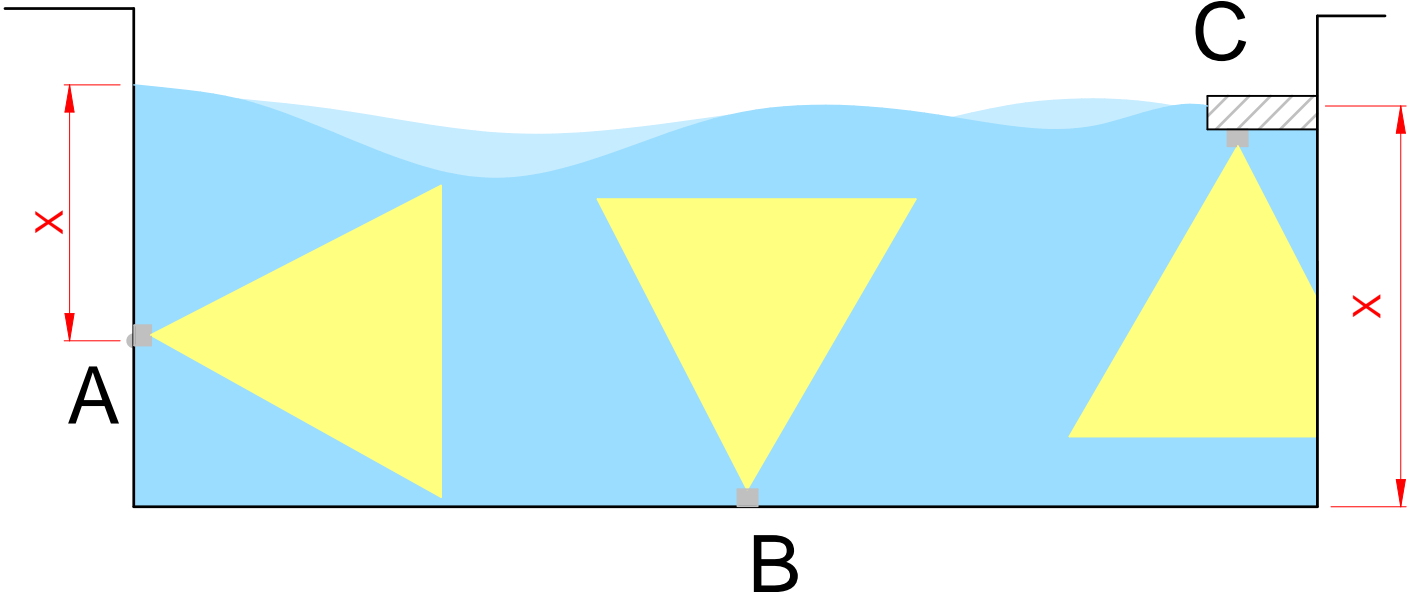

Single color

	Xmm	L1 max	L2 max
	0,75	10m	5m
	1,5	30m	5m
	2,5	30m	5m

$$L2 = L3 + L4$$

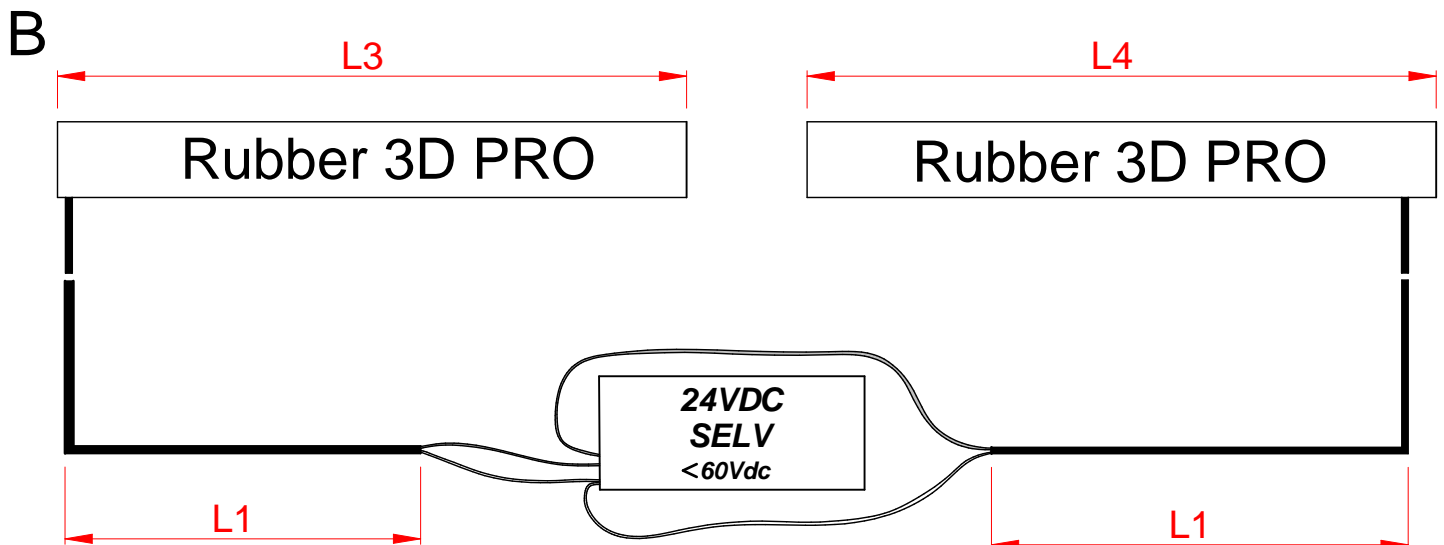
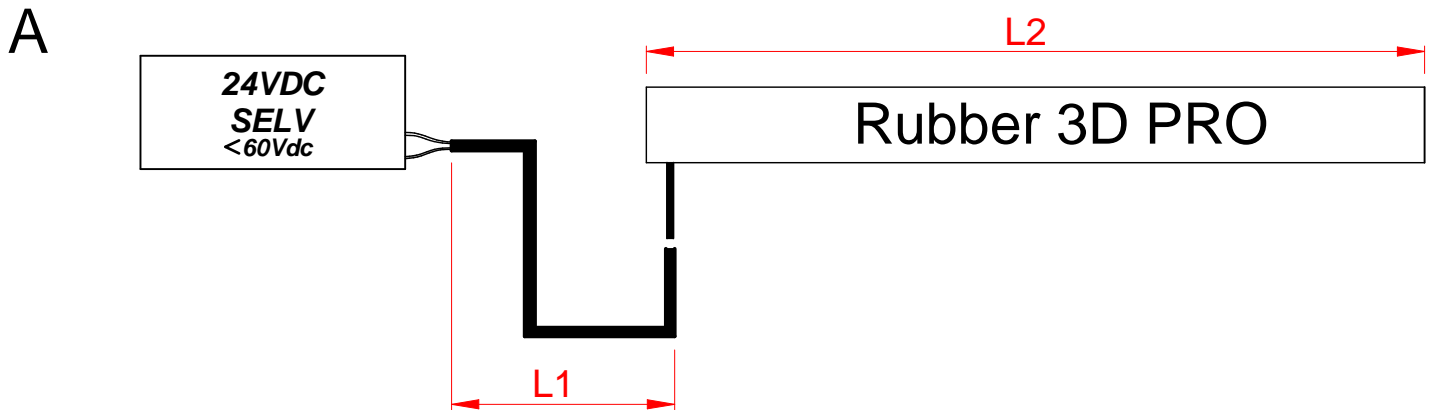

-Per le Rubber da 10m usare alimentatore con voltaggio regolabile e settare il voltaggio a 26V. Usare solo il cavo incluso delle Rubber

-For 10m Rubber use power supply with adjustable voltage and set the voltage to 26V. Use only the included cable of the Rubber

-Für 10m Rubber verwenden Sie ein Netzteil mit einstellbarer Spannung und stellen Sie die Spannung auf 26 V ein.

Verwenden Sie nur das mitgelieferte Gummikabel

-Pour le Rubber 10m, utilisez une alimentation avec une tension réglable et régler la tension sur 26V. N'utiliser que le câble en caoutchouc fourni.

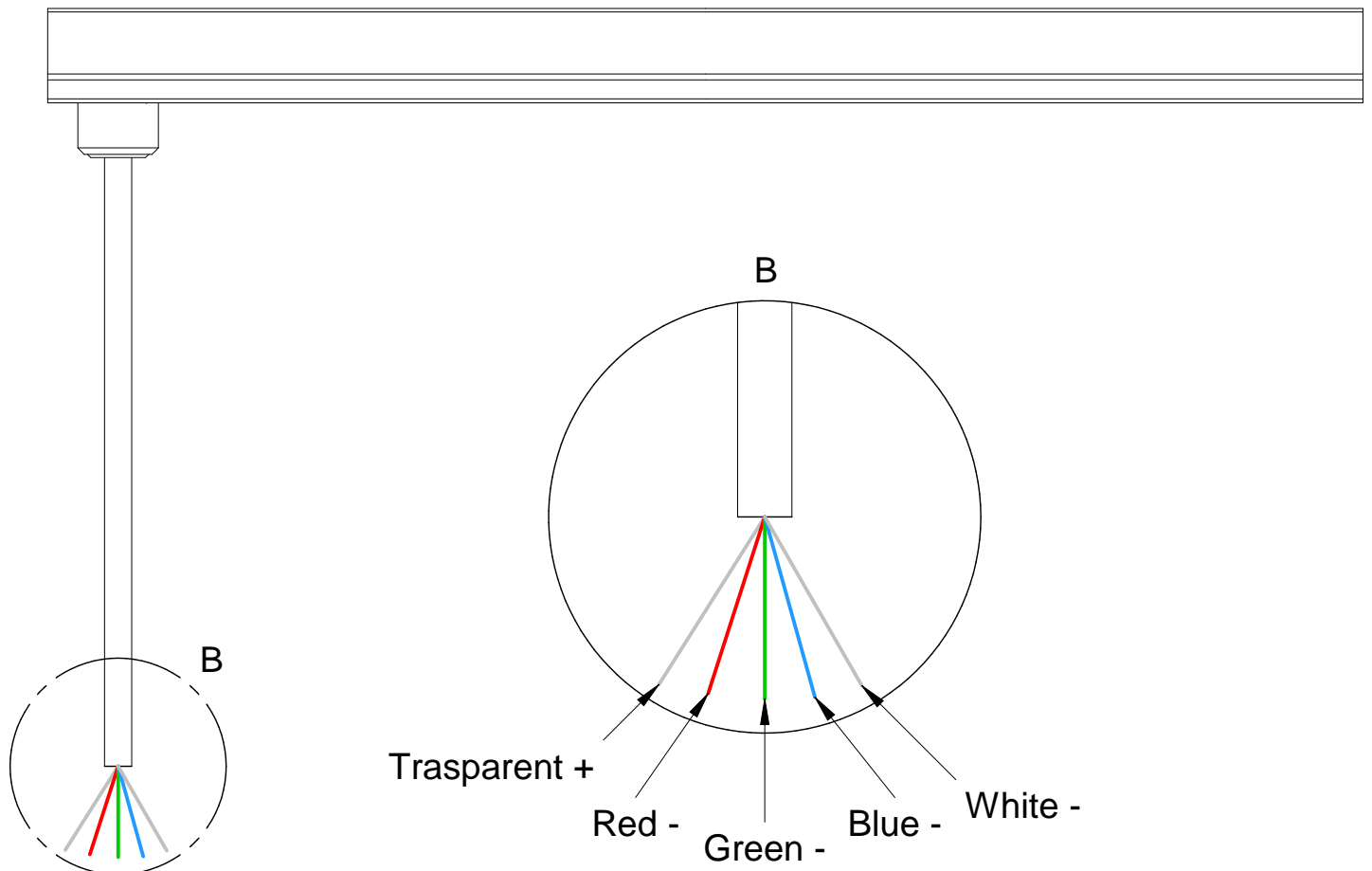
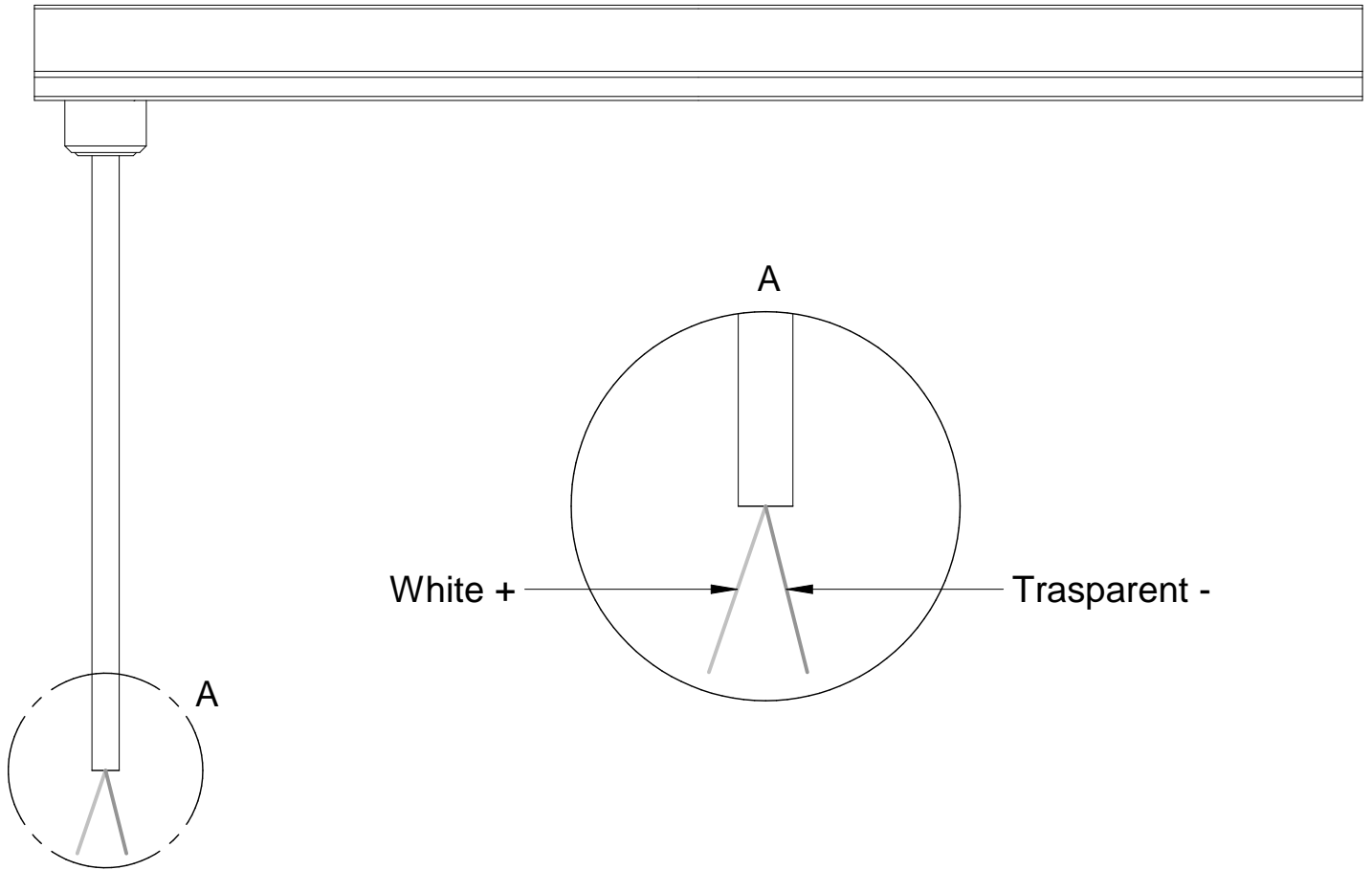

RGBW

	Xmm	L1 max	L2 max
	0,75	10m	5m
	1,5	20m	5m
	2,5	30m	5m

$$L2 = L3 + L4$$

A

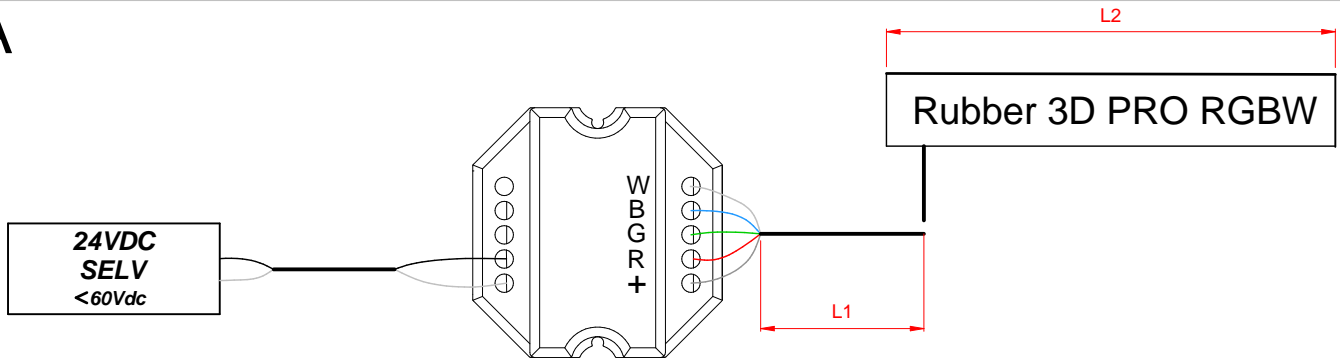

B

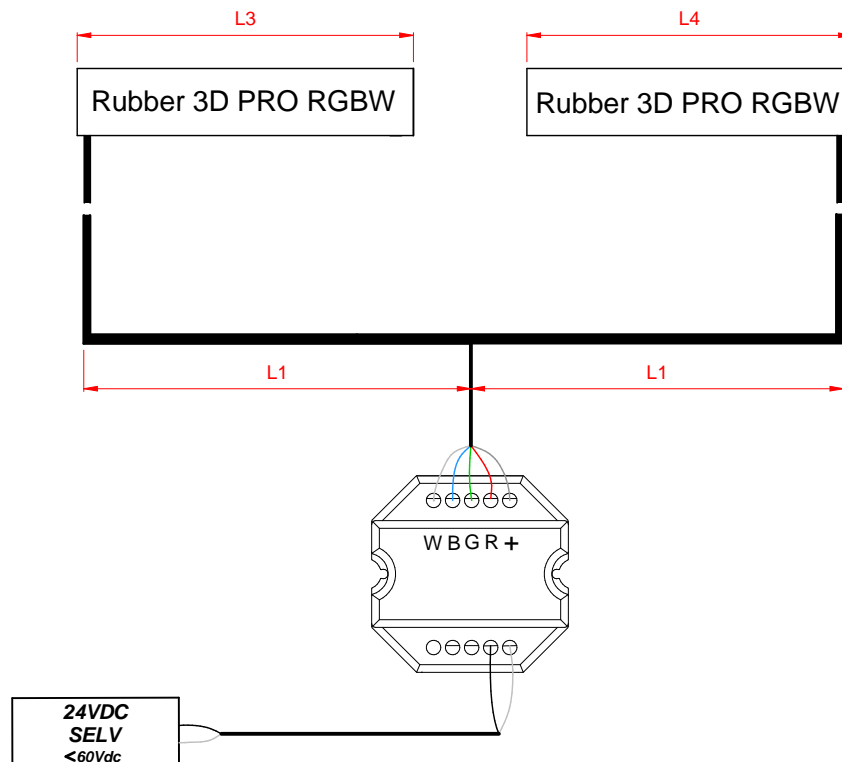

ISTRUZIONI PER IL LAVAGGIO DELL'APPARECCHIO D'ILLUMINAZIONE
LUMINAIRE CARE INSTRUCTIONS
ISTRUCCIONES PARA LIMPIAR LA LUMINARA
INSTRUCTIONS POUR LE LAVAGE DE L'APPAREIL D'ECLAIRAGE
ANLEITUNG ZUR REINIGUNG DES BELEUCHTUNGSGERATS

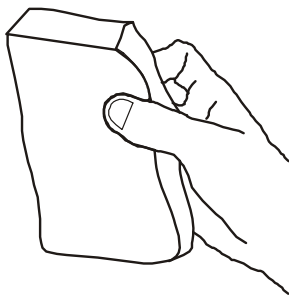
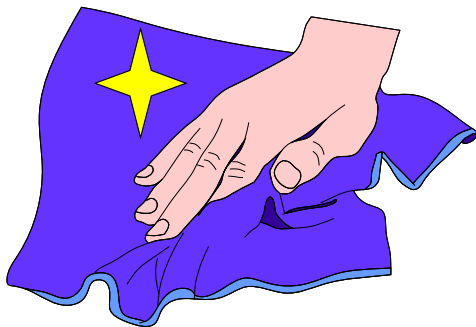

IT - ATTENZIONE!!!

Lavare la superficie del diffusore luce con panno umido, utilizzando solo acqua e sapone neutro.

EN - WARNING!!!

Wipe clean with a cloth dampened in water with neutral detergent.

ES - ATENCION!!!

Limpie la superficie del difusor con un pano humedecido con agua y jabon neutro.

FR - ATTENTION!!!

Laver la surface du diffuseur de lumiere a l'aide d'un chiffon humide et en utilisant seulement de l'eau et du savon neutre.

DE - ACHTUNG!!!

Die oberfläche vom lampenschirm mit einem feuchten lappen reinigen. De lappen mit wasser und neutralseife befeuchten.

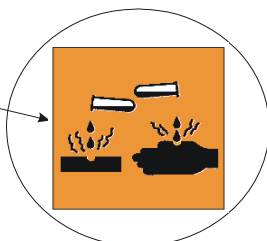
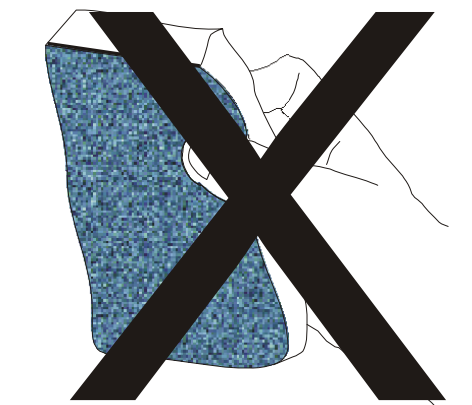

IT - ATTENZIONE!!!

Non utilizzare panni abrasivi e/o solventi.

EN - WARNING!!!

Avoiding the use of chemical solvents and/or abrasive cloths.

ES - ATENCION!!!

No utilizar panos abrasivos y solventes.

FR - ATTENTION!!!

Ne pas utiliser de chiffons abrasifs ou de dissolvants.

DE - ACHTUNG!!!

Abschleifende tuche und/oder losungsmittel nicht benutzen.