

SERIES: Modus\_MC

BRAND: i-LÈD

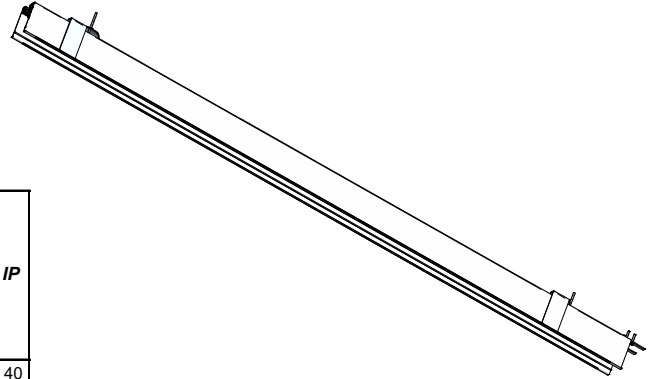
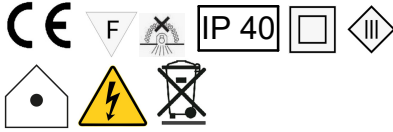

### CODICI / CODES

CODICE CODE	TIPO TYPE	Dimensions (LxWxH / Ø x H mm)	POWER (W)	CLASS I / II		WEIGHT (Kg)	CLASS	IP
				INPUT (V)	FREQ. (Hz)			
				CLASS III				
				VOLTAGE (V)	CURRENT (mA)			
C00166	MASTER	1200 x 48,5 x 57	96	220-240	50/60	1.8	1	40
C00167	MASTER	1500 x 48,5 x 57	96	220-240	50/60	2.2	1	40
C00168	MASTER	2400 x 48,5 x 57	150	220-240	50/60	3.1	1	40
C00169	MASTER	3000 x 48,5 x 57	150	220-240	50/60	3.7	1	40
C00170	SLAVE	1200 x 48,5 x 57	-	24V CV	-	1.8	3	40
C00171	SLAVE	1500 x 48,5 x 57	-	24V CV	-	2.2	3	40
C00172	SLAVE	2400 x 48,5 x 57	-	24V CV	-	3.1	3	40
C00173	SLAVE	3000 x 48,5 x 57	-	24V CV	-	3.7	3	40

Ta -20°C ÷ +50°C

### Installazione / Manutenzione

L'articolo dovrà essere installato da personale qualificato, **seguendo le normative d'installazione vigenti del paese di appartenenza**;  
In caso di malfunzionamento o necessità di manutenzione dell'articolo contattare il servizio clienti Linea Light tramite la seguente mail: [support@linealight.com](mailto:support@linealight.com).

**SONO SEVERAMENTE VIETATE LE OPERAZIONI DI INSTALLAZIONE E MANUTENZIONE DELL'ARTICOLO MENTRE QUEST ULTIMO È IN FUNZIONE;  
!!! ATTENZIONE !!! DUARANTE IL FUNZIONAMENTO ALCUNE PARTI DELL'APPARECCHIO POSSONO RAGGIUNGERE TEMPERATURE ELEVATE.**

### Installation / Maintenance

The article must be installed by qualified personnel, **following the installation regulations in force in your country**;  
In the event of malfunction or need for maintenance of the article, contact Linea Light customer service via the following e-mail: [support@linealight.com](mailto:support@linealight.com).

**IT IS STRICTLY FORBIDDEN TO INSTALL AND MAINTAIN THE ARTICLE WHILE IT IS IN OPERATION; !!! WARNING !!! DURING OPERATION, CERTAIN PARTS OF THE APPLIANCE MAY REACH HIGH TEMPERATURES.**

**LINEA LIGHT declines any kind of responsibility** if the instructions provided in the following instruction manual and in the main manual present in the article's packaging are not followed.

### UTILIZZO CONFORME:

L'apparecchio è garantito esclusivamente se l'articolo in questione sia stato installato seguendo le istruzioni riportate in questo manuale di istruzioni e da quello generale presenti all'interno dell'imbollo e scaricabili dal sito: [www.linealight.com](http://www.linealight.com); **In caso di mancata osservazione delle precedenti avvertenze, l'azienda LINEA LIGHT declinerà ogni tipologia di responsabilità.**

Un utilizzo scorretto dell'articolo può influire nella durata utile della lampada e/o potrebbe causarne un guasto precoce.  
Evitare la pulizia dell'apparecchio utilizzando agenti chimici aggressivi, è sufficiente passare l'articolo con uno straccio inumidito con acqua.  
Per ulteriori avvertenze e/o spiegazioni di eventuali simboli si prega di visionare il foglio istruzioni generale.

**CONSERVARE LE PRESENTI ISTRUZIONI PER FUTURI LAVORI DI INSTALLAZIONE/MANUTENZIONE.**

### COMPLIANT USE:

The luminaire is only guaranteed if the article in question has been installed in accordance with the instructions given in this instruction manual and the general manual found inside the packaging and downloadable from: [www.linealight.com](http://www.linealight.com); **In the event of failure to comply with the above warnings, LINEA LIGHT declines all liability.**

Incorrect use of the fixture may affect the service life of the lamp and/or cause it to fail prematurely.  
Avoid cleaning the fixture using harsh chemicals, simply wipe the item with a cloth dampened with water.  
For further warnings and/or explanations of possible symbols please refer to the general instruction sheet.

**KEEP THESE INSTRUCTIONS FOR FUTURE INSTALLATION/MAINTENANCE WORK.**

(ITA) - I prodotti devono essere installati tassativamente con alimentazioni, cablaggi e accessori originali del Gruppo Linea Light, o eventualmente approvati dall'azienda. L'utilizzo di accessori non originali, o non approvati, determina il decadimento di ogni garanzia sul prodotto. (ENG) - All power supply, wiring and accessories used for product installation shall be original Linea Light Group parts or approved by the company. The warranty will become void if non original or non approved parts are used. (FRA) - Les produits doivent impérativement être installés avec des alimentations, des câblages et des accessoires Linea Light Group, ou qui ont été approuvés par l'entreprise. L'utilisation d'accessoires non d'origine, ou non approuvés, entraîne la déchéance de toute garantie sur le produit. (ESP) - Los productos se han de instalar obligatoriamente con alimentaciones, cableados y accesorios originales de Linea Light Group o, de otra forma, deben ser aprobados por la empresa misma. El uso de accesorios no originales, o no aprobados, anula todas las garantías del producto. (GER) Die Produkte müssen obligatorisch mit Originalstromversorgung, Originalkabeln und Originalzubehör der Linea Light Group oder mit Teilen, die von der Linea Light Group ausdrücklich empfohlen sind, installiert werden. Die Verwendung von nicht originale oder nicht vom Hersteller empfohlenem Zubehör führt zu einem sofortigen Verfall vom Garantieanspruch für das Produkt.

SERIES: Modus\_MC  
BRAND: i-LèD

ACCESSORI NON INCLUSI  
ACCESSORIES NOT INCLUDED

A. GIUNTO AD L  
A. L- SHAPED JOINT

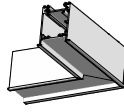

C-K400026  
C-K400027

B. GIUNTO A T  
B. T- SHAPED JOINT

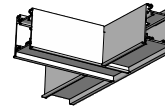

C-K400036  
C-K400037

C. GIUNTO AD X  
C. X SHAPED JOINT

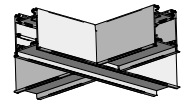

C-K400030  
C-K400031

D. TAPPI DI CHIUSURA  
D. END CAPS



C-K400056  
C-K400057

E. MICROPRISMATICO  
E. MICROPRISMATIC



83722  
83746  
83760  
83723  
83747  
83761  
83724  
83748  
83762

F. OPTUS EX  
F. OPTUS EX

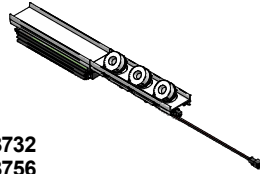

83732  
83756

G. PROIETTORI  
G. PROJECTORS

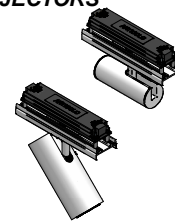

83731  
83755  
83730  
83754

H. CELL\_WW  
H. CELL\_WW



83721  
83745

I. CELL  
I. CELL



83720  
83744

L. SENSORE QUALITA' DELL'ARIA  
L. AIR QUALITY SENSOR

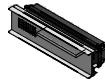

C-E900004  
C-E900005

M.SENSORE LUMINOSITA' PRESENZA  
M. PIR LIGHT SENSOR

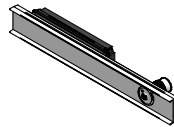

C-E900002  
C-E900001

N. TAMPONAMENTO  
N. FILL ELEMENT

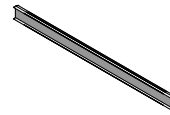

83725  
83749  
83729  
83753  
83726  
83750  
83727  
83751  
83728  
83752

## DIMENSIONI / DIMENSIONS

C00166  
C00170

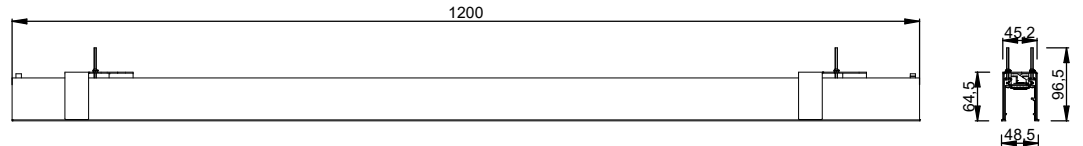

C00167  
C00171

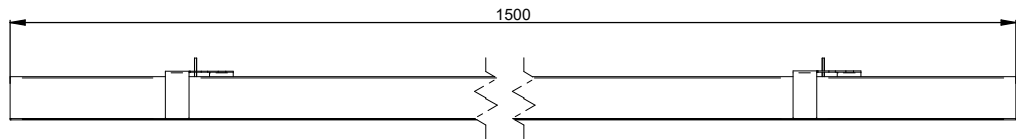

C00168  
C00172

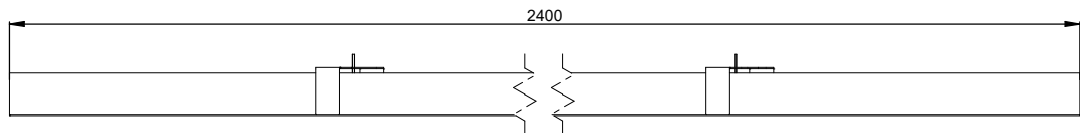

C00169  
C00173

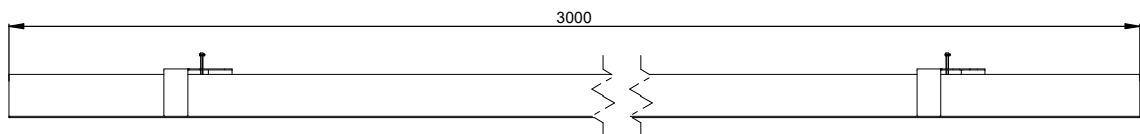

SERIES: Modus\_MC

BRAND: i-LèD

**PRE-INSTALLAZIONE / PRE-INSTALLATION**

ESEGUIRE I FORI DI INSTALLAZIONE DEL PRODOTTO SEGUENDO LE MISURE RIPORTATE NELLA TABELLA  
MAKE THE INSTALLATION HOLES FOLLOWING THE BELOW LISTED DIMENSIONS

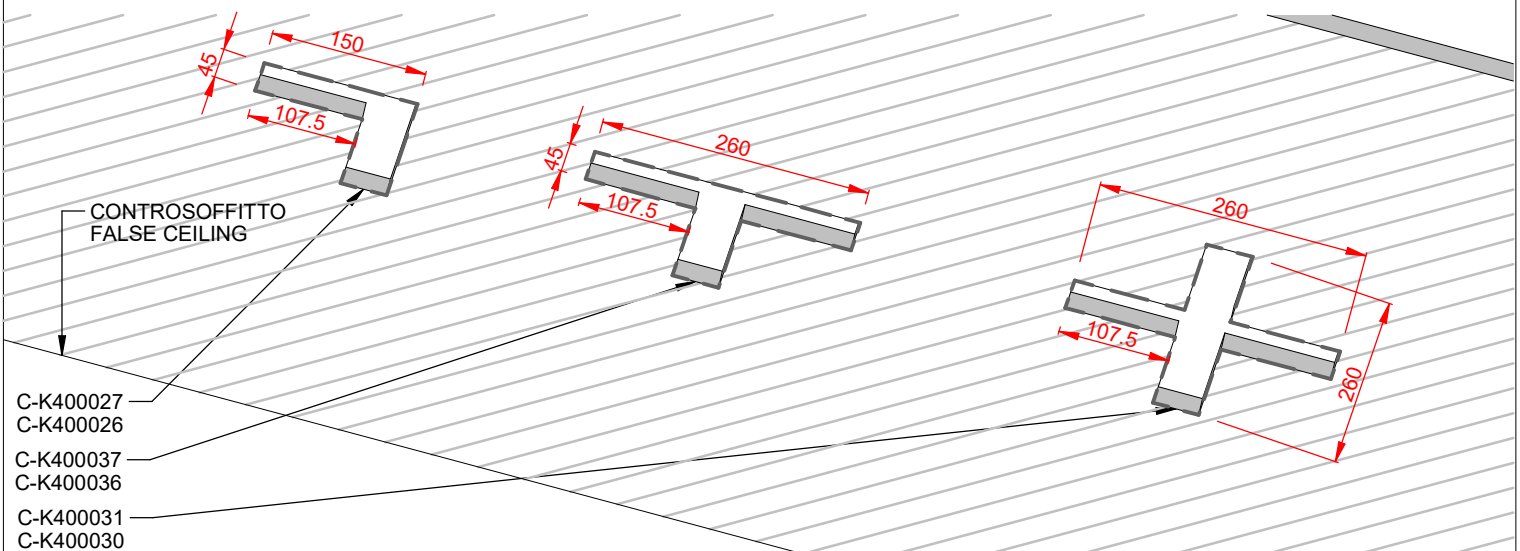
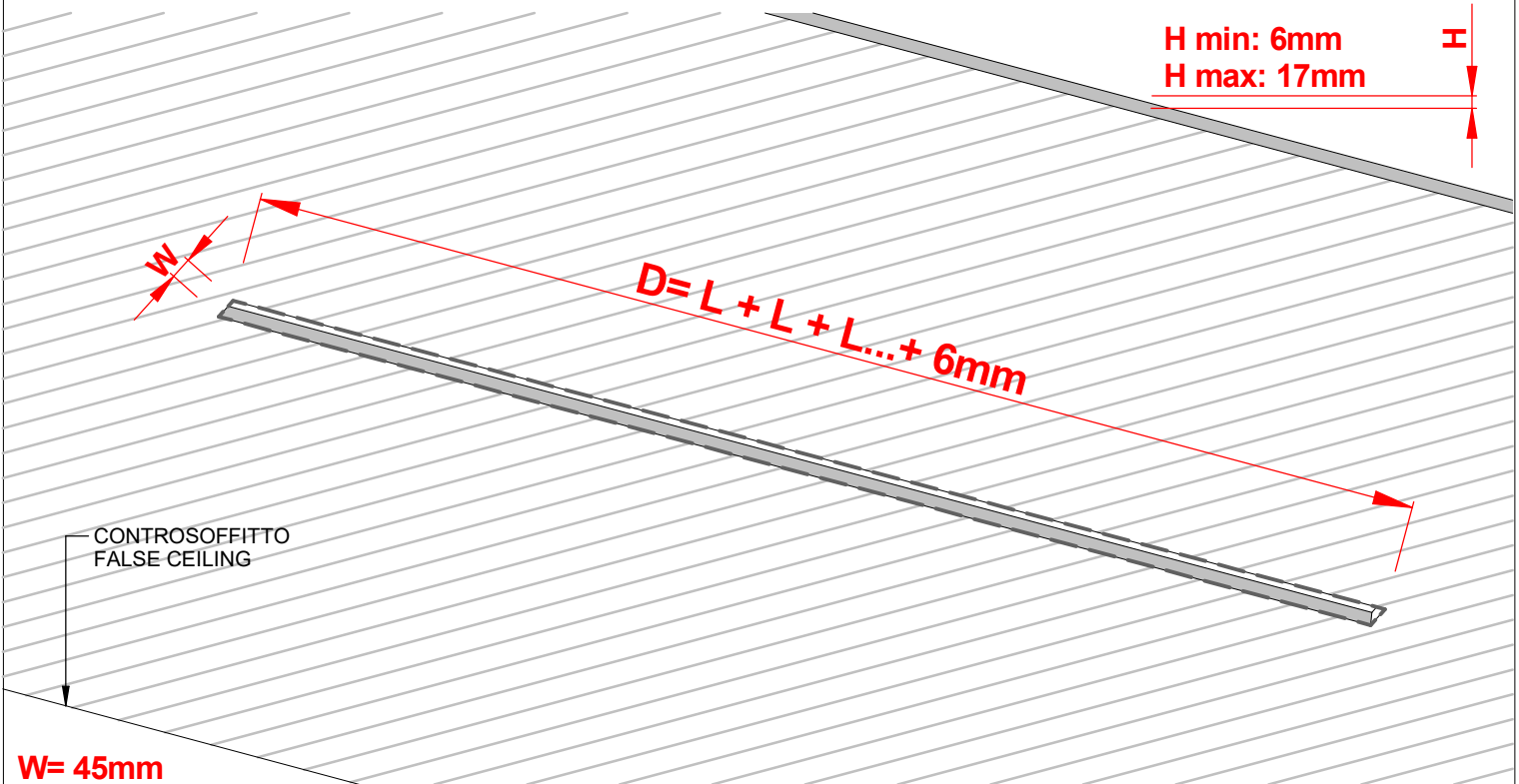

**D = LUNGHEZZA PRODOTTI (L) + 2 x TAPPI DI CHIUSURA (6mm)**

**D = PRODUCTS LENGHT (L) + 2 x END-CAPS (6mm)**

CODICE REF.	LUNGHEZZA (L) LENGHT (L)	TAPPI END CAPS	SPESORE WIDTH
----------------	-----------------------------	-------------------	------------------

C00166	1200mm	C-K400056	3mm
C00170	1200mm	C-K400057	3mm
C00167	1500mm		
C00171	1500mm		
C00168	2400mm		
C00172	2400mm		
C00169	3000mm		
C00173	3000mm		

SERIES: Modus\_MC

BRAND: i-LÈD

INSTALLAZIONE / INSTALLATION

- 1** INSERIRE IL PRODOTTO CON LE STAFFE DI FISSAGGIO ADESE AL PROFILO DI ALLUMINIO ,DOPO AVER FISSATO I TAPPI DI CHIUSURA  
FIT THE PRODUCT INSIDE THE HOLE. THE FIXING BRACKETS NEEDS TO BE CLOSED AGAINST THE ALUMINIUM PROFILE, MIND THE END CAPS

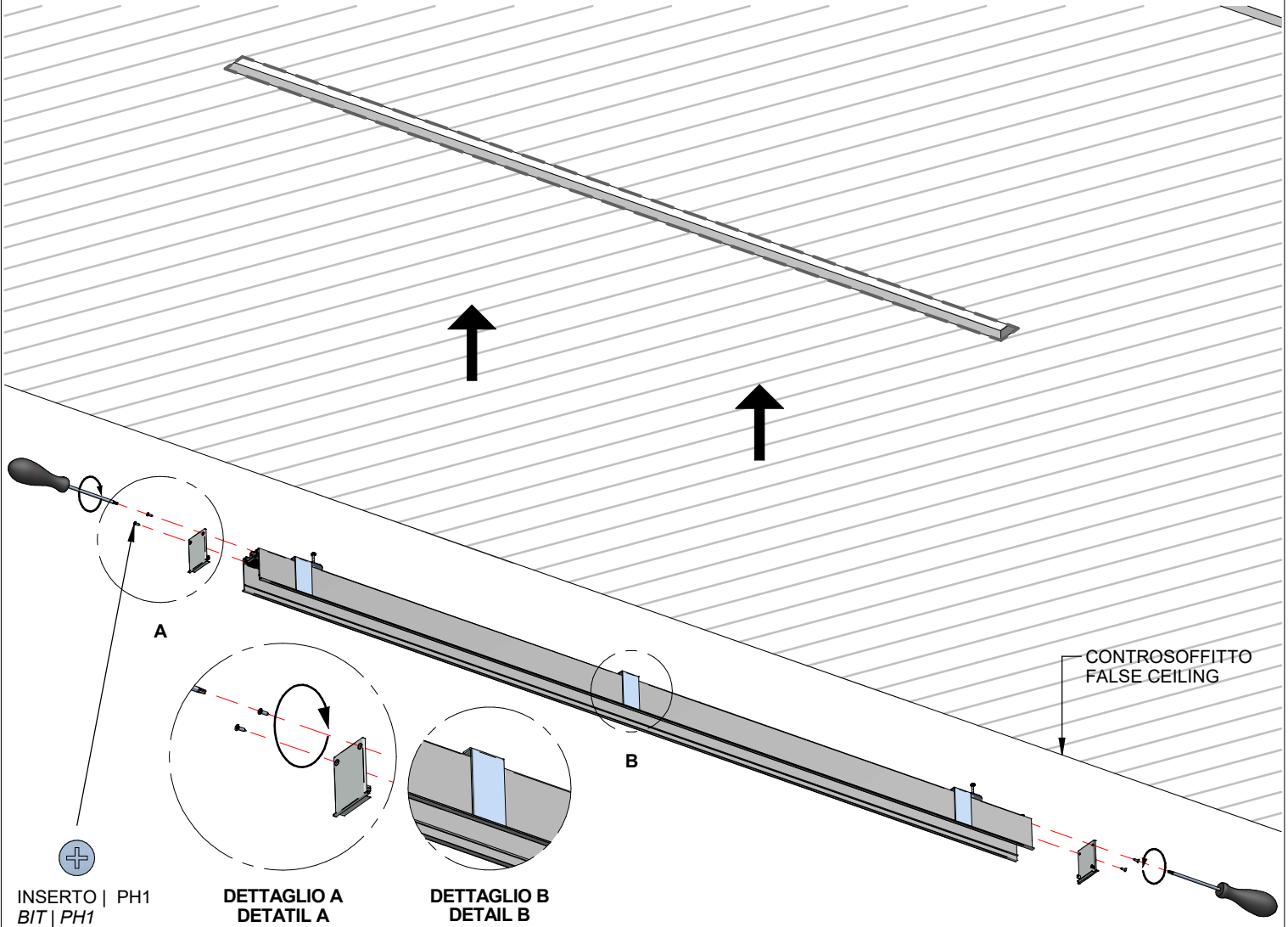

INSERTO | PH1  
BIT | PH1

DETTAGLIO A  
DETATIL A

DETTAGLIO B  
DETAIL B

- 2** INDIVIDUARE LE VITI DI SERRAGGIO DELLE STAFFE ED AVVITARE FINCHE IL PROFILO NON SARA' SALDAMENTE ANCORATO AD  
CONTROSOFFITTO  
LOCATE THE BRACKET'S SCREWS, TURN THEM CLOCKWISE UNTIL THE PROFILE IS LOCKED ON TO THE FALSE CEILING

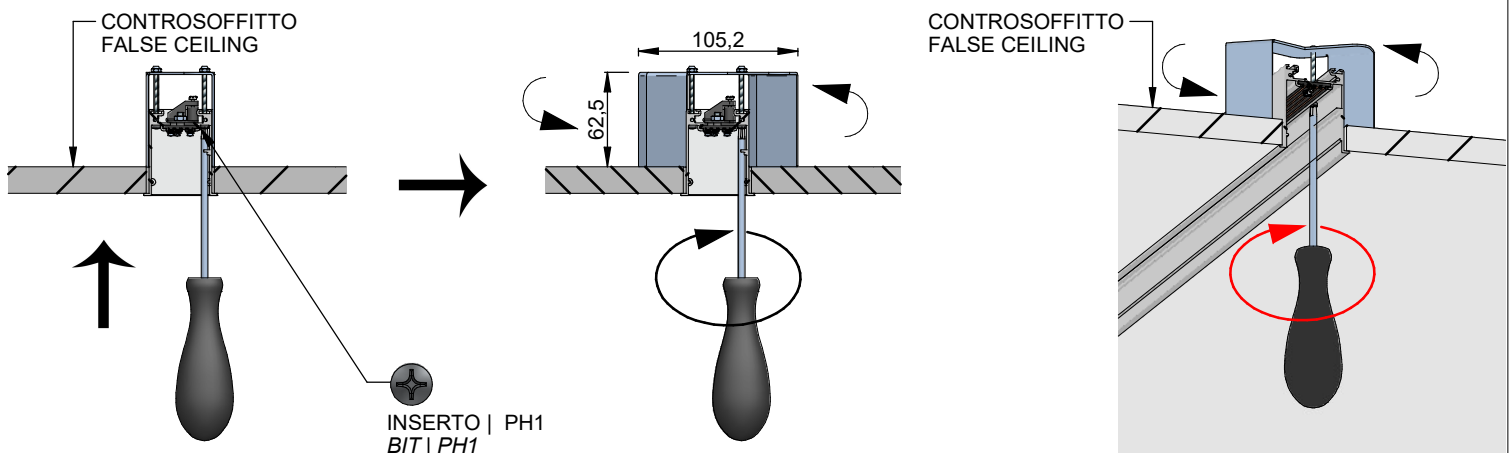

INSERTO | PH1  
BIT | PH1

SERIES: Modus\_MC

BRAND: i-LèD

VISTA DALL'ALTO DOPO L'INSTALLAZIONE  
TOP VIEW AFTER THE INSTALLATION

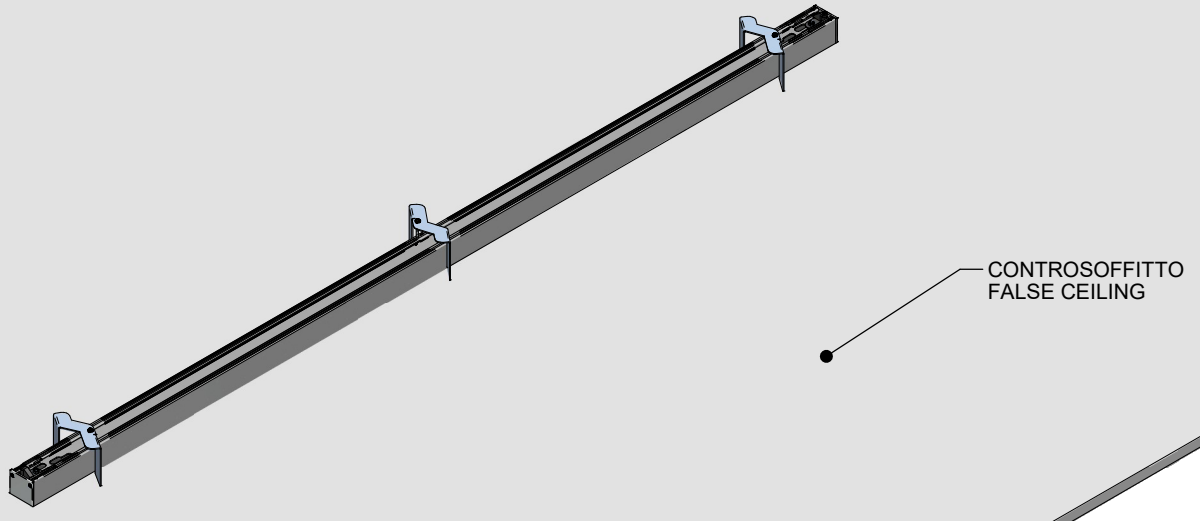

**3** ASSEMBLAGGIO DI COMPONENTI MASTER E SLAVE. INSERIRE LE DUE STAFFE NEL MODULO SLAVE. SERRARE CON LE VITI  
MASTER AND SLAVE ASSEMBLY. INSERT THE MASTER'S TWO BRACKETS INTO THE SLAVE. TIGHTEN THE PROVIDED SCREWS

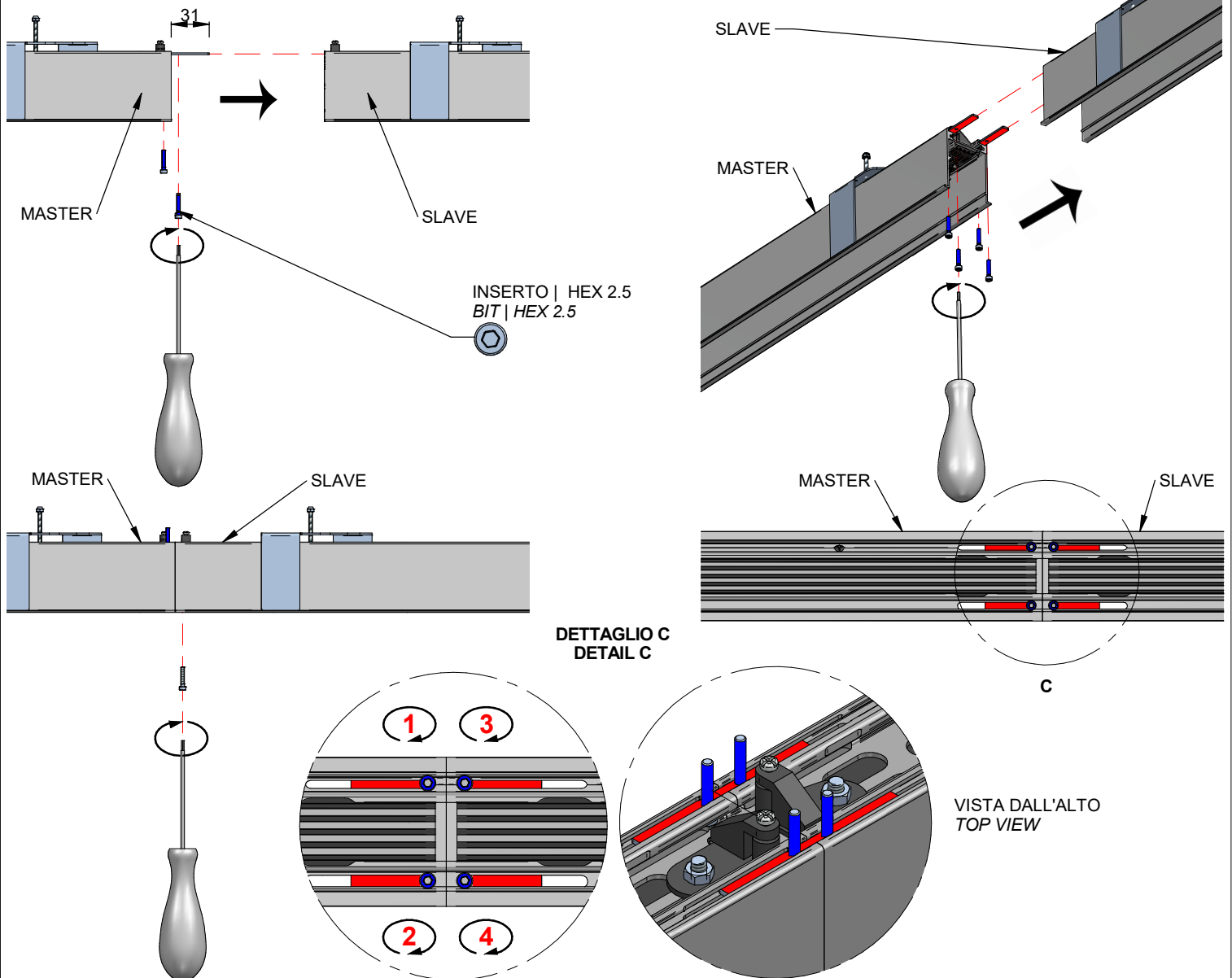

SERIES: Modus\_MC

BRAND: i-LèD

**4** ASSEMBLAGGIO COMPONENTIA T, L ED X. INSERIRE LE DUE STAFFE NEL MODULO. SERRARE CON LE VITI  
T, L ED X PARTS ASSEMBLY. INSERT THE TWO BRACKETS INTO THE PROFILE. TIGHTEN THE PROVIDED SCREWS

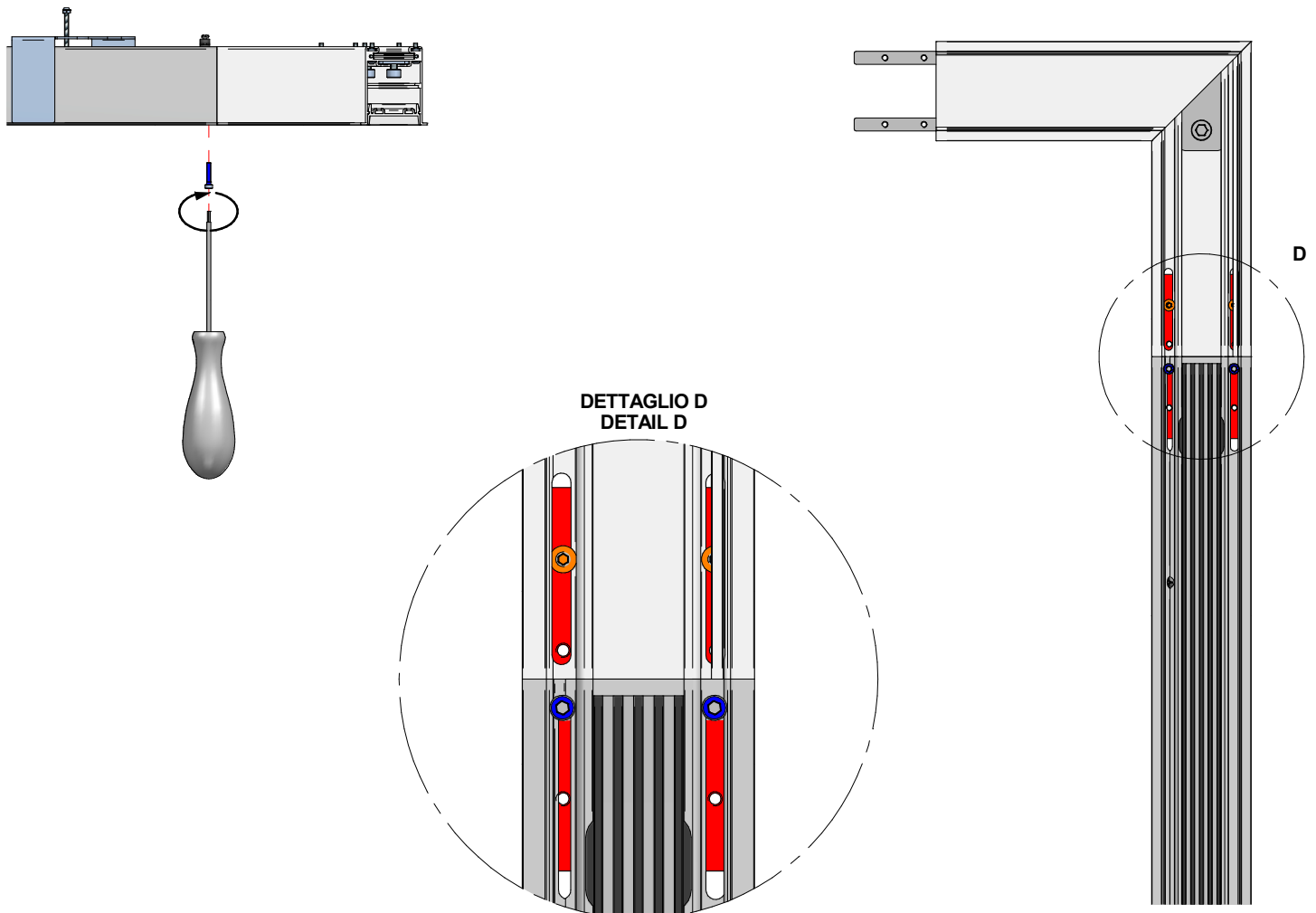
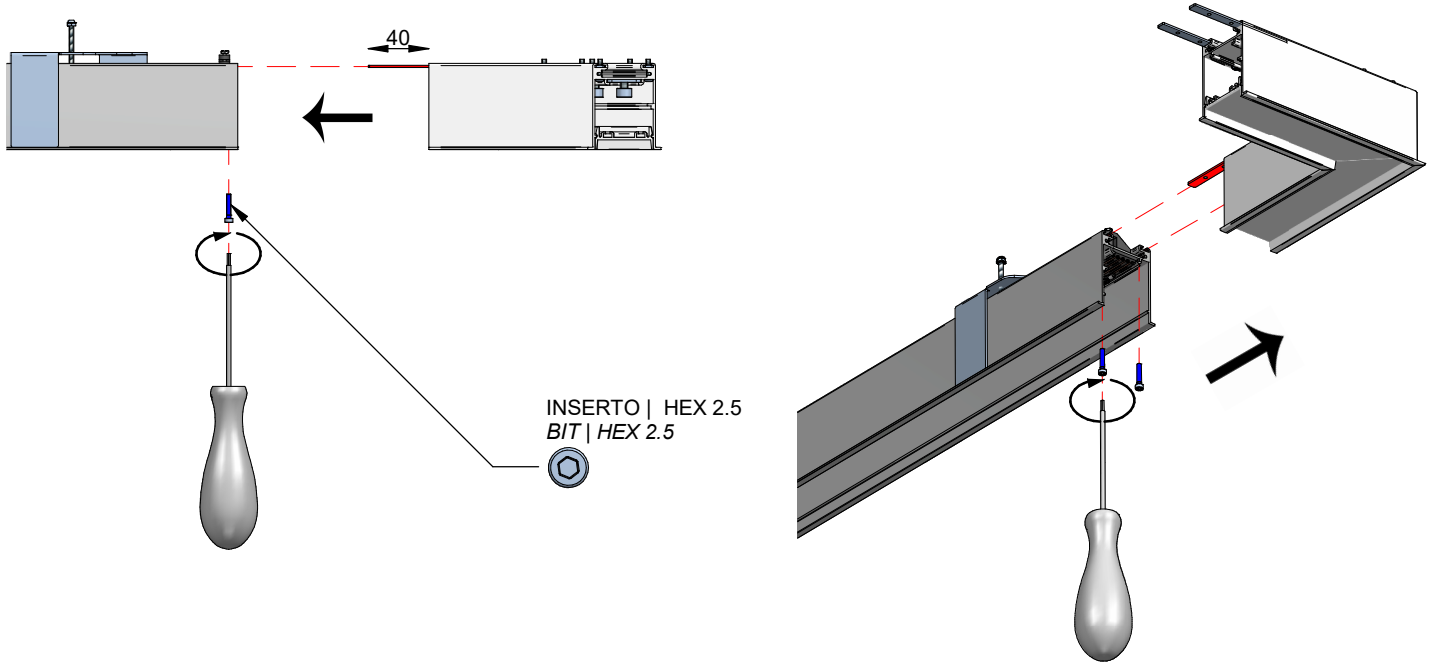

SERIES: Modus\_MC

BRAND: i-LèD

**5** COLLEGARE IL MODULO MASTER AL MODULO SLAVE SEGUENDO LA COMBINAZIONE COLORI DESCRITTA. COLLEGARE LA TENSIONE DI RETE AL DRIVER DEL MODULO MASTER  
CONNECT THE MASTER MODULE TO THE SLAVE MODULE FOLLOWING THE COLOR COMBINATION DESCRIBED. CONNECT THE MAINS VOLTAGE TO THE MASTER MODULE DRIVER

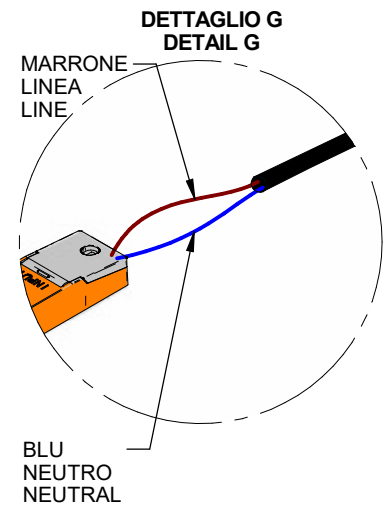
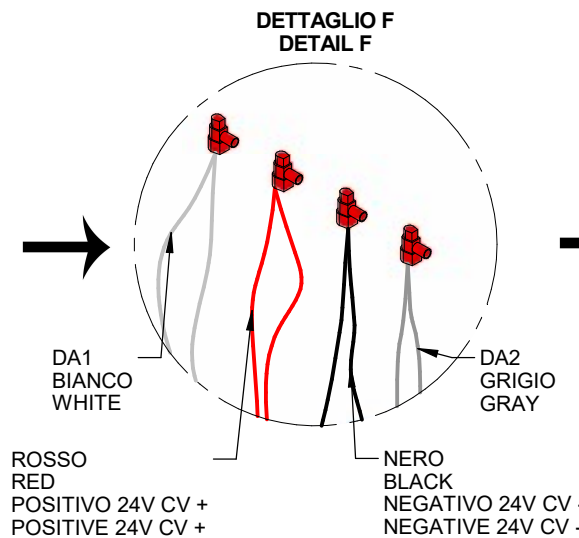
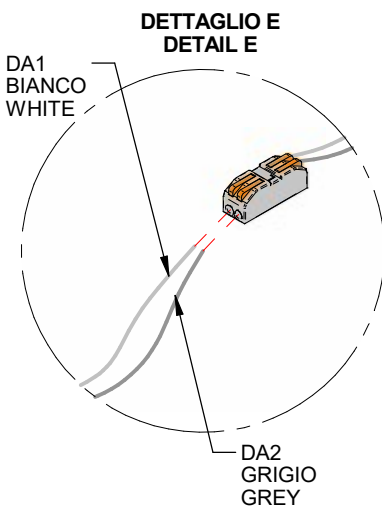
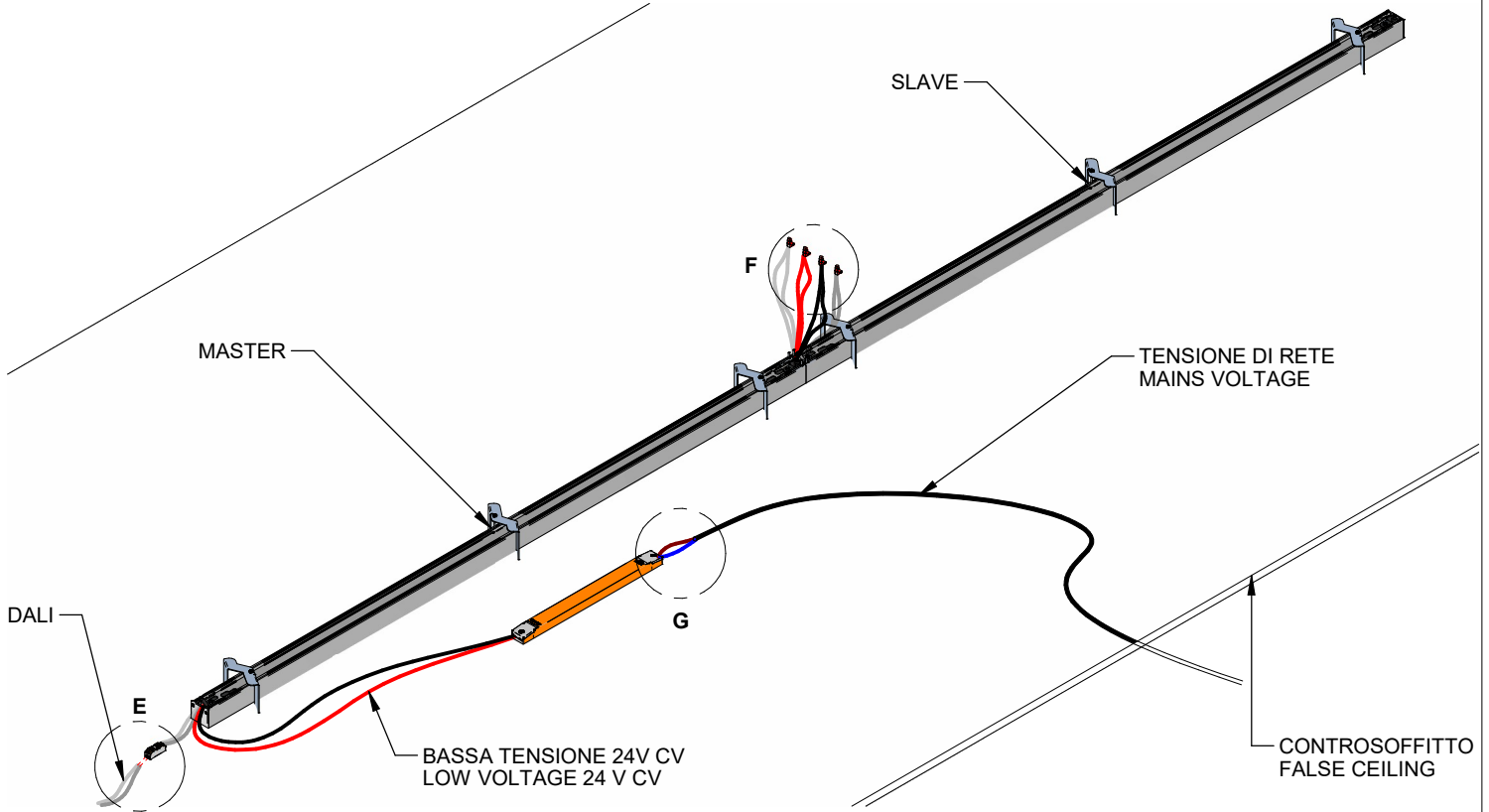

**LEGENDA COLORI  
COLOR CODING**

- BLU / BLUE | NEUTRO | NEUTRAL
- MARRONE / BROWN | LINEA | LINE
- BIANCO / WHITE | DA1
- GRIGIO / GREY | DA2
- ROSSO / RED | POSITIVO 24V CV + / POSITIVE 24V CV +
- NERO / BLACK | NEGATIVO 24V CV - / NEGATIVE 24V CV -

**NOTA IMPORTANTE  
IMPORTANT NOTE**

SE IL CORPO ILLUMINATE VUOLE ESSERE UTILIZZATO IN MODALITA ON/OFF, NON COLLEGARE IL BUS DALI. RIFERIMENTO DETTAGLIO "E"

IF THE LIGHT FIXTURE NEEDS TO BE USED IN ON/OFF MODE, DO NOT WIRE THE DALI BUS. REFER TO DETAIL "E"

SERIES: Modus\_MC

BRAND: i-LèD

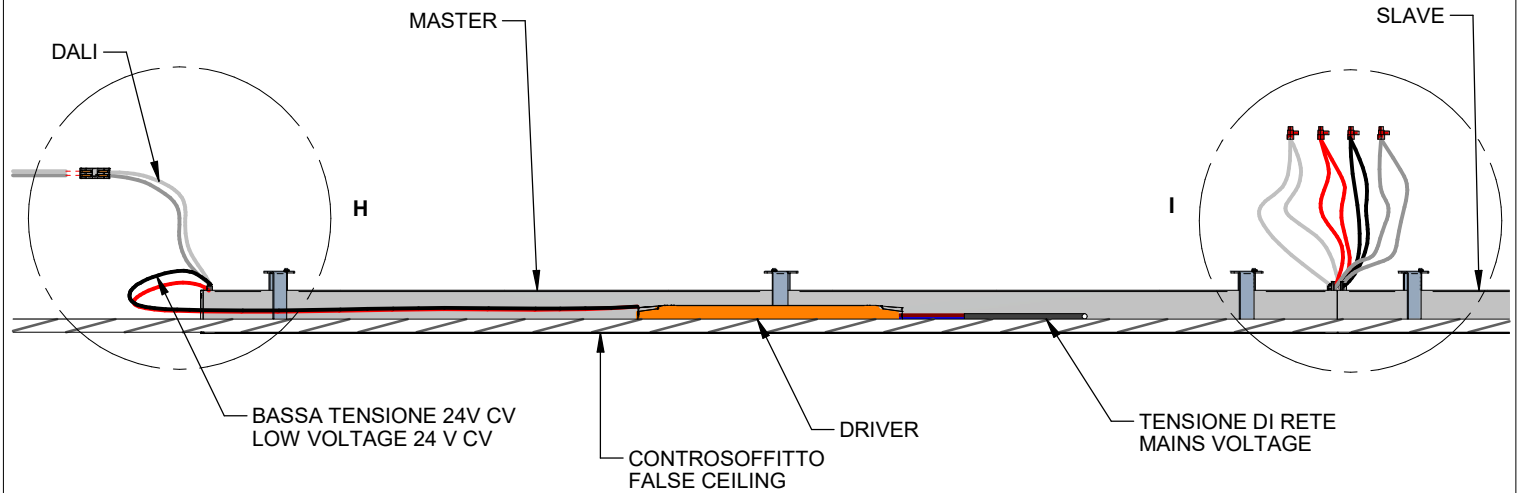

DETTAGLIO H

DETTAGLIO I

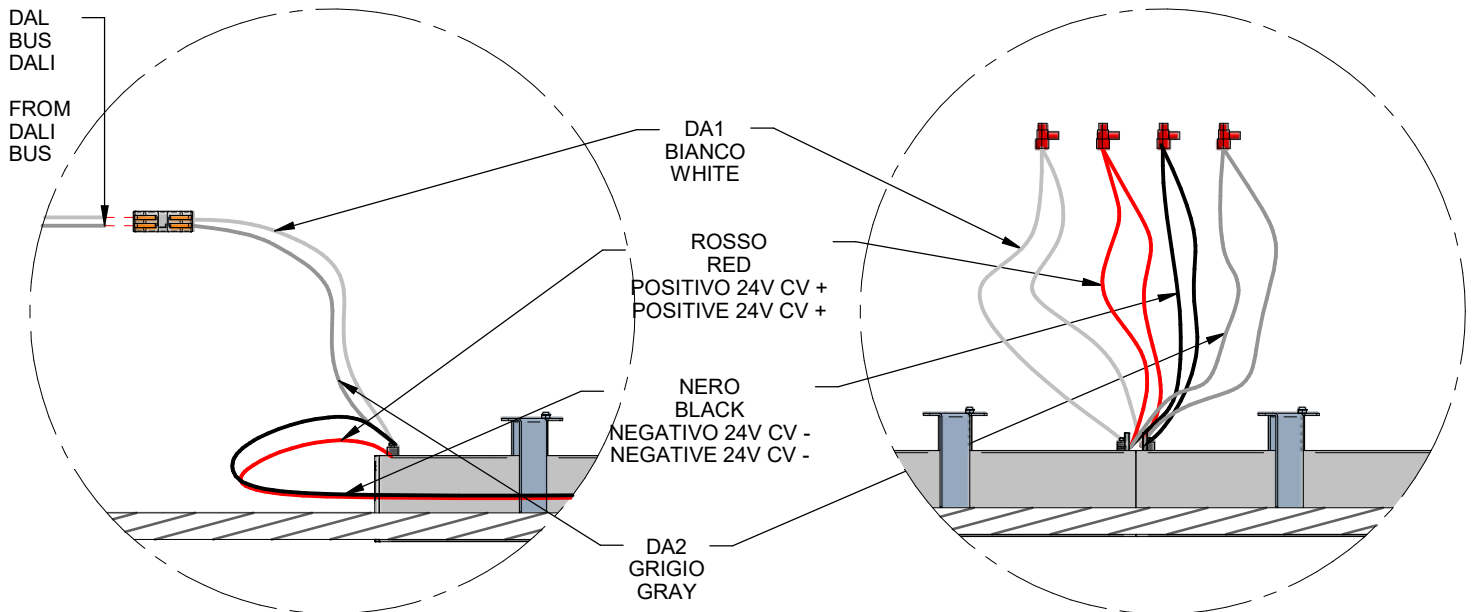

**MASSIMO CARICO PER LINEA  
MAX LOAD PER LINE**

TABELLA "A"  
TABLE "A"

CODICE REF.	LUNGHEZZA LENGHT	MAX CARICO PER MASTER + N° SLAVE MAX LOAD PER MASTER + N° SLAVES
C00166	1200mm	90 W
C00167	1500mm	90 W
C00168	2400mm	140 W
C00169	3000mm	140 W



SERIES: Modus\_MC

BRAND: i-LèD

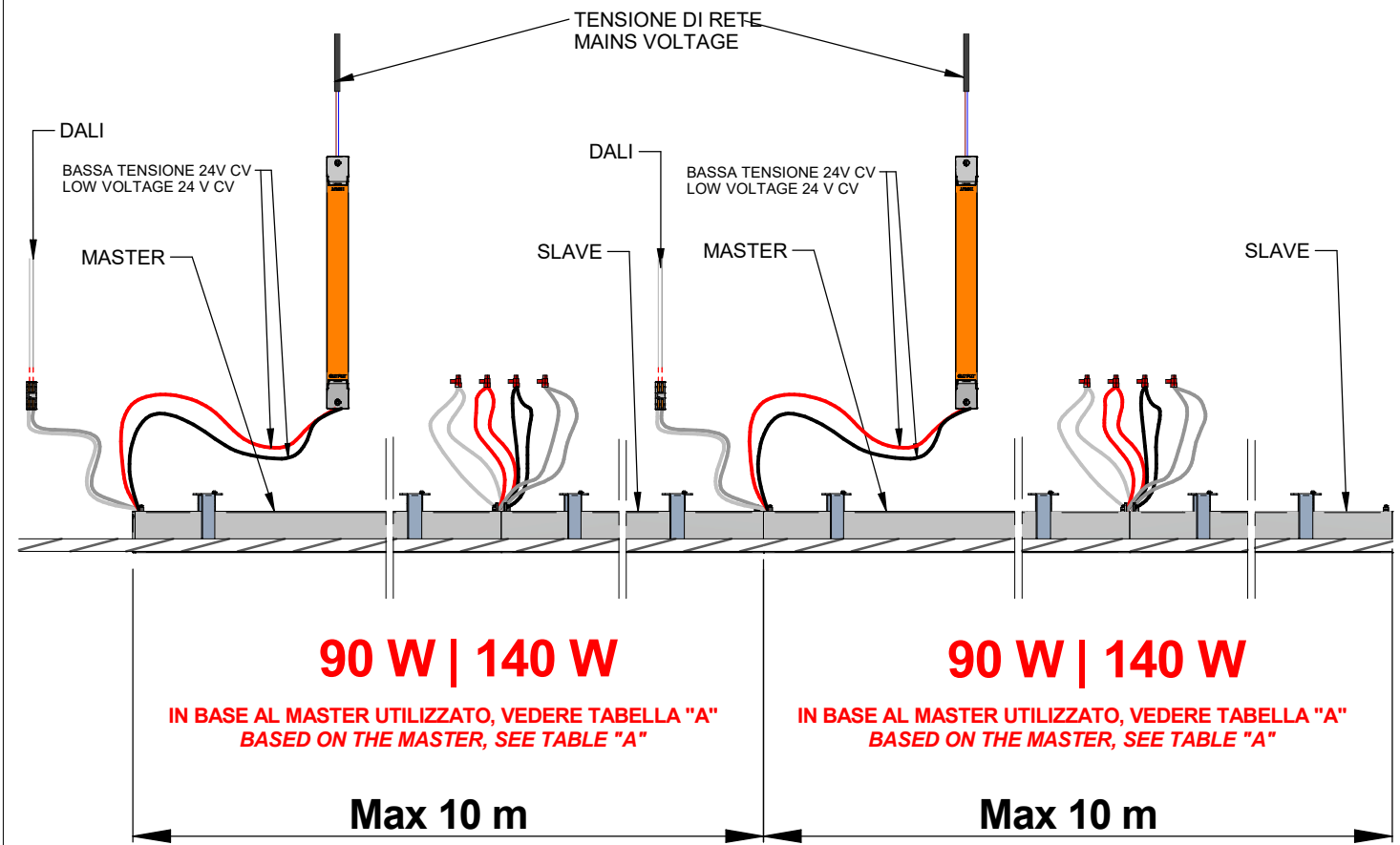

ACCESSORI NON INCLUSI  
ACCESSORIES NOT INCLUDED

D. TAPPI DI CHIUSURA  
D. END CAPS

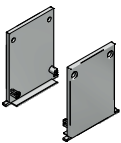

C-K400056  
C-K400057

E. MICROPRISMATICO  
E. MICROPRISMATIC



83722  
83746  
83760  
83723  
83747  
83761  
83724  
83748  
83762

F. OPTUS EX  
F. OPTUS EX

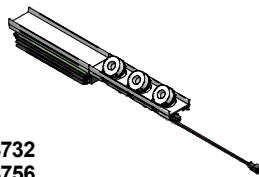

83732  
83756

G. PROIETTORI  
G. PROJECTORS

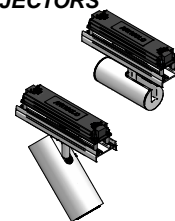

83731  
83755  
83730  
83754

H. CELL\_WW  
H. CELL\_WW



83721  
83745

I. CELL  
I. CELL

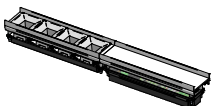

83720  
83744

L. SENSORE QUALITA' DELL'ARIA  
L. AIR QUALITY SENSOR

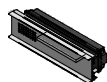

M. SENSORE LUMINOSITA' PRESENZA  
M. PIR LIGHT SENSOR

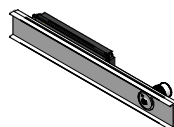

C-E900002  
C-E900001

N. TAMPONAMENTO  
N. FILL ELEMENT

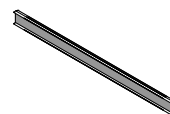

83725  
83749  
83729  
83753  
83726  
83750  
83727  
83751  
83728  
83752

ACCESSORI NON INCLUSI: PER L'INSTALLAZIONE SEGUIRE IL FOGLIO DI ISTRUZIONE DEDICATO, FORNITO CON L'ACCESSORIO  
ACCESSORIES NOT INCLUDED: FOLLOW ACCESSORY'S INSTRUCTION MANUAL INCLUDED

NOME FOGLIO DI ISTRUZIONE  
INSTRUCTION MANUAL NAME

**LED-FGI861**

SERIES: Modus\_MC

BRAND: i-LèD

**CABLAGGIO / WIRING**

Collegamento diretto alla linea elettrica  
Directo connection to the main

