

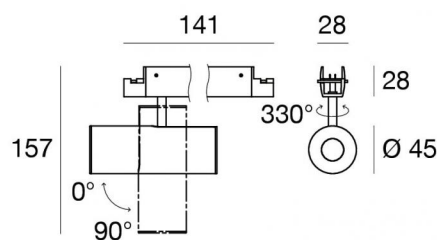

Systèmes - Éléments linéaires
1 topLED 10 W DC 24 V | CRI 90

83957W30



| Données techniques | |
|--|-------------------------------|
| Designer | Linea Light |
| Année de réalisation | 2020 |
| Typologie | Systèmes - Éléments linéaires |
| Position d'installation | Câble |
| Environnement d'installation | Intérieur |
| Source lumineuse | LED |
| Circuit structure | topLED |
| Optique | Medium Flood |
| Light emission direction | downward |
| Puissance nominale | 10 W DC |
| Flux lumineux (source) | 1068 lm |
| Plage de tension d'entrée | 24 V |
| Frequency | 50-60 Hz |
| Température de couleur / Tone | 3000 K |
| Indice de rendu chromatique | 90 Ra |
| C.C. / V.C. | CV |
| Classe d'isolation | 3 |
| IP | IP40 |
| Essai au fil incandescent | 650° |
| Montage direct sur des surfaces normalement inflammables | Oui |
| CE | Oui |
| Driver inclus | Non |
| C.V. - C.C. Converter | Convertisseur 24 V inclus |
| Article à intensité variable | DALI - 1-10V - PUSH DIM |
| Orientable | Orientable |
| angle total (plan vertical) | 330 ° |
| Basculement | Oui |
| angle total (plan horizontal) | 90 ° |
| Piétinable | Non |
| Carrossable | Non |
| Câble inclus | Non |
| Revêtement en résine | Non |
| Type d'émission lumineuse | Émission simple |
| Poids net | 0455 Kg |
| Protection contre les décharges électrostatiques | Non |
| Protection contre les surtensions | Non |
| Technologie optique | Honey comb |

Finition corps

| | |
|-------------|------------|
| Matériau | Aluminium |
| Fabrication | Vernissage |



Finition diffuseur

| | |
|----------|-------------|
| Matériau | PMMA |
| Couleur | transparent |

Finition monture

| | |
|-------------|------------|
| Matériau | Aluminium |
| Fabrication | Vernissage |

Électronique

| | |
|---|--|
|  | 81416 On/Off Driver 220~240V AC 120 W (1 - 12 art.) |
|  | 81417 On/Off Driver 220~240V AC 180 W (1 - 18 art.) |
|  | 83042 1-10V - Push and Simply Dim - DALI-2 Controller (1 - 28 art.) |



Systèmes - Éléments linéaires | 1 topLED 10 W DC 24 V | CRI 90
83957W30

Single emission systems or lines for indoor application. The warm white LED light source with a medium flood light distribution is composed of 1 powered LEDs with CCT of 3000 K and a CRI 90; the source luminous flux is 1068 lm, with a 106.8 lm/W nominal luminous efficacy.

The device body is made of aluminium and features a 5g 9005 black finish, processed by means of coating; the diffuser is made of pmma; the mounting frame is made of aluminium, with a 5g 9005 black finish, processed by means of coating. The ingress protection degree is IP40; the total weight is of 0455 kg.

The total absorbed power is 10 W.

The device features protection class III and can be cable-mounted.

Compliant with the EN 60598-1 standard and its specific provisions.

Classe d'efficacité énergétique

Ce produit contient une source lumineuse de classe d'efficacité énergétique F.

Caractéristiques Techniques de l'éclairage

| | |
|-------------------------------------|----------------|
| Light Output Ratio (LOR) | 64 % |
| Flux lumineux (source) | 1068 lm |
| Flux lumineux du luminaire | 690 lm |
| Consumption | 10 W |
| Efficacité lumineuse du luminaire | 69 lm/W |
| Température de couleur | 3000 K |
| Standards de Concordance de Couleur | 3 Step MacAdam |
| Indice de rendu chromatique | 90 Ra |
| Température de jonction (appareil) | 80 |

Température standard de l'environnement de -20 / +50°C

LED Life / Failure Ratio

L80 B20 C0 80000h (at Tj 85 Ta 25)

UGR

| | |
|-------------------|----------|
| UGR axial | 16.6 |
| UGR transversal | 17.1 |
| X=4H Y=8H | S=0.25H |
| Reflection factor | 70/50/20 |

OPTICAL

| | |
|-----------------------------|-------------|
| Optique C0/C180 | 32° |
| Light distribution simmetry | Symmetrical |

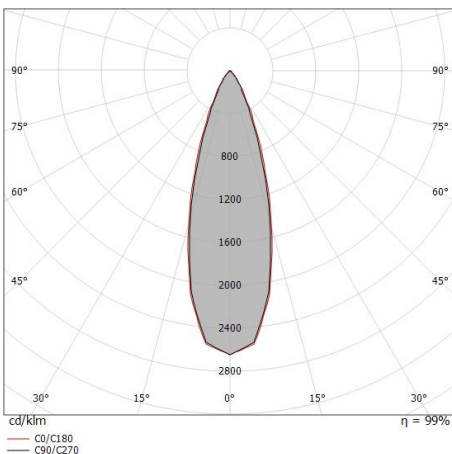

| Distance [m] | Cone diameter [m] | illuminance [lx] |
|--------------|-------------------|---|
| 0.5 | 0.28 0.29 | E(0°) 7300 E(C90) 3254 E(C0) 3250 |
| 1.0 | 0.57 0.58 | E(0°) 1825 E(C90) 813 E(C0) 813 |
| 1.5 | 0.85 0.88 | E(0°) 811 E(C90) 362 E(C0) 361 |
| 2.0 | 1.13 1.17 | E(0°) 456 E(C90) 203 E(C0) 203 |
| 2.5 | 1.41 1.46 | E(0°) 292 E(C90) 130 E(C0) 130 |
| 3.0 | 1.70 1.75 | E(0°) 203 E(C90) 90 E(C0) 90 |

— C0/C180 (Half-peak divergence: 32.6°)
— C90/C270 (Half-peak divergence: 31.6°)



| | | | |
|--|--|--|----------------------|
| | | Outil - Kit de coupe/dénudage de câbles | Code 81427 |
| | | Câble Type câble power cable; Longueur 1000 mm; isolation doppio; section 1.5 mm ² ; serre-câble: non; couleurs: noir - rouge. | Code 84016 |
| | | Câble Type câble power cable; Longueur 5000 mm; isolation doppio; section 1.5 mm ² ; serre-câble: non; couleurs: noir - rouge. | Code 81410 |
| | | Câble Type câble power cable; Longueur 10000 mm; isolation doppio; section 1.5 mm ² ; serre-câble: non; couleurs: noir - rouge. | Code 81411 |
| | | Profil - L. 1000mm Matériau:Aluminium, fabrication :Vernissage. | Code 84012 |
| | | Profil - L. 2000mm Matériau:Aluminium, fabrication :Vernissage. | Code 84013 |
| | | Profil - L. 3000mm Matériau:Aluminium, fabrication :Vernissage. | Code 84014 |
| | | Profil - Coin intégré Matériau:Aluminium, fabrication :Vernissage. | Code 84015 |



Ink system_SP | Lines | Accessories
83957W30

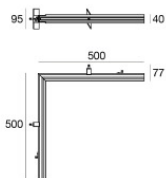

Profil - Coin intégré - IN
Matériau:Aluminium, fabrication :Vernissage.

Code
84073

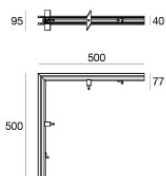
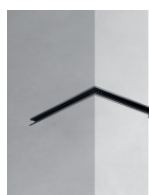

Profil - Coin intégré - OUT
Matériau:Aluminium, fabrication :Vernissage.

Code
84074

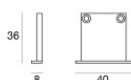

Bouchon - 2X
Matériau:PC, couleur:noir.

Code
83153

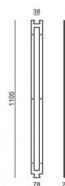

Gabarit

Code
83186