

Ceiling Downlights - Projectors | 198-264 V  
1 arrayLED 9 W DC - 11 W AC | CRI 90

9911

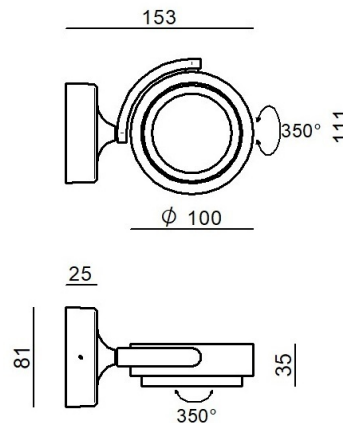

### Technical data

Type	--- Surface
Installation position	Wall lights - Ceiling
Installation environment	Indoor
Light Source	LED
Circuit structure	arrayLED
Optics	Spot
Light emission direction	downward
Nominal power	9 W DC
Total Power	11 W
Source lumens	958 lm
Nominal input voltage	220 - 240 V AC
Input voltage range	198 - 264 V AC
Frequency	50 - 60 Hz
CCT / Tone	3000 K
Colour rendering index	90 Ra
C.C. / C.V.	AC
Safety class	1
IP	IP20
Glow wire test	850°
Direct mounting on normally flammable surfaces	Yes
CE	Yes
Driver included	Driver
Dimmable article	Phase cut
Directional	Swivelling
total angle (vertical plane)	350 °
total angle (horizontal plane)	350 °
Tilting	No
Walk-over	No
Drive-over	No
Cable included	No
Resin potting	No
Type of light emission	Single emission
Net weight	0.600 Kg
Electrostatic discharge protection	No
Surge protection	No

### Finishing casing

Material	Aluminium
Colour	Black
Processing	Coating

### Finishing diffuser

Material	PC
Colour	opaline

## Ceiling Downlights - Projectors | 198-264 V | 1 arrayLED 9 W DC - 11 W AC | CRI 90 | Base

**9911**

Single emission ceiling downlights, projectors or projectors for indoor application. The warm white LED light source with a spot light distribution is composed of 1 topped LEDs with CCT of 3000 K and a CRI 90; the source luminous flux is 958 lm, with a 106.4 lm/W nominal luminous efficacy.

The device body is made of aluminium and features a black finish, processed by means of coating; the diffuser is made of PC. The ingress protection degree is IP20; the total weight is of 0.600 kg.

The total absorbed power is 11 W.

The device features protection class I and can be wall lights or ceiling-mounted.

Compliant with the EN 60598-1 standard and its specific provisions.

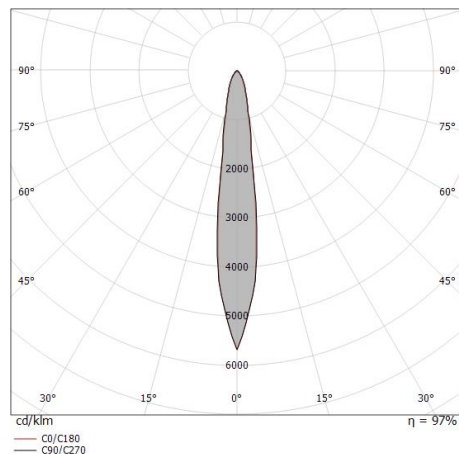

Distance [m]	Cone diameter [m]	Illuminance [lx]
0.5	0.14	E(0°) 19490 E(C0) 9494
1.0	0.27	E(0°) 4872 E(C0) 2373
1.5	0.41	E(0°) 2166 E(C0) 1055
2.0	0.54	E(0°) 1218 E(C0) 593
2.5	0.68	E(0°) 780 E(C0) 380
3.0	0.81	E(0°) 541 E(C0) 264

— C0/C180 (Half-peak divergence: 15.4°)

### Energy efficiency class

This product contains a light source of energy efficiency class F.

### Illuminotechnical Features

Light Output Ratio (LOR)	89 %
Source lumens	958 lm
Delivered lumens	856 lm
Consumption	11 W
Luminaire efficacy	77 lm/W
Colour temperature	3000 K
Standard Deviation of Colour Matching	3 Step MacAdam
Colour rendering index	90 Ra
Junction temperature (lighting fixture)	80
Standard Operating Ambient Temperature	25°C

### LED Life / Failure Ratio

L80 B20 C0 80000h

### UGR

UGR axial	17.7
UGR transversal	17.8
X=4H   Y=8H	S=0.25H
Reflection factor	70/50/20

### OPTICAL

C0/C180 optics	15°
Light distribution symmetry	Symmetrical

## Ceiling Downlights - Projectors | 198-264 V | 1 arrayLED 9 W DC - 11 W AC | CRI 90 | Base

### 9911

Single emission ceiling downlights, projectors or projectors for indoor application. The warm white LED light source with a spot light distribution is composed of 1 topped LEDs with CCT of 3000 K and a CRI 90; the source luminous flux is 958 lm, with a 106.4 lm/W nominal luminous efficacy.

The device body is made of aluminium and features a black finish, processed by means of coating; the diffuser is made of PC. The ingress protection degree is IP20; the total weight is of 0.600 kg.

The total absorbed power is 11 W.

The device features protection class I and can be wall lights or ceiling-mounted.

Compliant with the EN 60598-1 standard and its specific provisions.

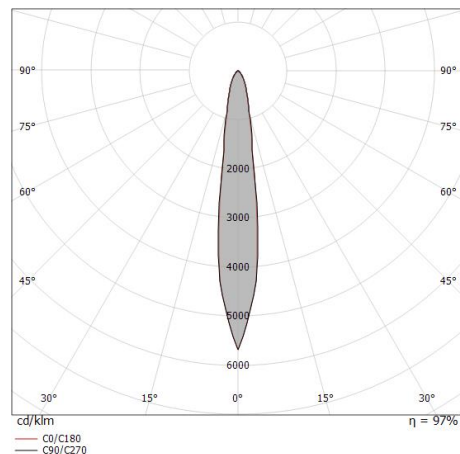

Distance [m]	Cone diameter [m]	Beam diameter [m]	Peak illuminance [lx]	Average illuminance [lx]
0.5	0.14	0.14	18124	8828
1.0	0.27	0.27	4531	2207
1.5	0.41	0.41	2014	981
2.0	0.54	0.54	1133	552
2.5	0.68	0.68	725	353
3.0	0.81	0.81	503	245

Distance [m] Cone diameter [m] Illuminance [lx]

— C0/C180 (Half-peak divergence: 15.4°)

#### Energy efficiency class

This product contains a light source of energy efficiency class F.

#### Illuminotechnical Features

Light Output Ratio (LOR)	83 %
Source lumens	958 lm
Delivered lumens	796 lm
Consumption	11 W
Luminaire efficacy	72 lm/W
Colour temperature	3000 K
Standard Deviation of Colour Matching	3 Step MacAdam
Colour rendering index	90 Ra
Junction temperature (lighting fixture)	80
Standard Operating Ambient Temperature	25°C

#### LED Life / Failure Ratio

L80 B20 C0 80000h

#### UGR

UGR axial	17.5
UGR transversal	17.5
X=4H   Y=8H	S=0.25H
Reflection factor	70/50/20

#### OPTICAL

C0/C180 optics	15°
Light distribution symmetry	Symmetrical

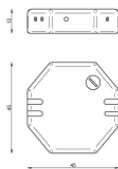

Dimmer  
220-240V

**Code**

KIT0026