

# Archiline\_W PRO

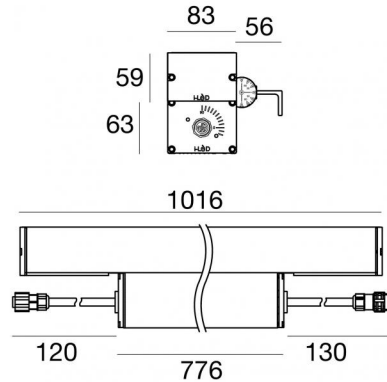

Wall Lights - Lines | 190-250 V  
18 x powerLEDs 80.5 W DC - 89 W AC | CRI 80  
**90461M30**



Technical data	
Type	- - Surface
Installation position	Wall lights - Ceiling
Installation environment	Outdoor
Light Source	LED
Circuit structure	powerLEDs
Optics	30°
Light emission direction	frontal
Nominal power	80.5 W DC
Total Power	89 W
Source lumens	10486 lm
Nominal input voltage	220 - 240 V AC
Input voltage range	190 - 250 V AC
CCT / Tone	2700 K
Colour rendering index	80 Ra
C.C. / C.V.	AC
Safety class	1
IP	IP67
IK	IK08
Glow wire test	850°
Direct mounting on normally flammable surfaces	Yes
CE	Yes
Driver included	Driver
Dimmable article	No
Directional	Swivelling
total angle (vertical plane)	135 °
Tilting	No
Walk-over	No
Drive-over	No
Cable included	Yes
Cable length	0.17 m
Resin potting	No
Type of light emission	Single emission
Net weight	6.2 Kg
Electrostatic discharge protection	Yes
Surge protection	6 KV
Optics technology	Dark light
Product technological characteristics	TCS - TVS

## Finishing casing

Material	Aluminium 6060
Colour	Anodised Aluminum
Processing	20 µm anodizing

## Finishing diffuser

Material	Extra clear glass - Tempered
Colour	transparent
Processing	Silk-screening

## Finishing bracket

Material	Aluminium 6060
Colour	Anodised Aluminum
Processing	20 µm anodizing

## Cables Electrification

Cable connector	Male Plug 3 pin
IP (locked condition)	68
Cable connector	Female Socket 3 Pin



Wall Lights - Lines | 190-250 V | 18 x powerLEDs 80.5 W DC - 89 W AC | CRI 80 | Base  
**90461M30**

Single emission wall lights or lines for outdoor application. The super warm white LED light source is composed of 18 powered LEDs with CCT of 2700 K and a CRI 80; the source luminous flux is 10486 lm, with a 130.3 lm/W nominal luminous efficacy.

The device body is made of aluminium 6060 and features a anodised aluminum finish, processed by means of 20 µm anodizing; the diffuser is made of extra clear glass - tempered with a silk-screening treatment. The ingress protection degree is IP67; the total weight is of 6.2 kg.

The total absorbed power is 89 W. The power supply cable is included and features a 0.17 m length.

The device features protection class I and can be wall lights or ceiling-mounted.

Compliant with the EN 60598-1 standard and its specific provisions.

### Energy efficiency class

This product contains 6 light sources of energy efficiency class E.

### Illuminotechnical Features

Light Output Ratio (LOR)	62 %
Source lumens	10486 lm
Delivered lumens	6519 lm
Consumption	89 W
Luminaire efficacy	73 lm/W
Colour temperature	2700 K
Standard Deviation of Colour Matching	3 Step MacAdam
Colour rendering index	80 Ra
Black Body Locus	On
Standard Operating Ambient Temperature	-20 / +50°C
Ordinary temperature on the glass	40°C

### LED Life / Failure Ratio



L70 B10 C0 247450h (at Tj 60 Ta 25 )

### OPTICAL

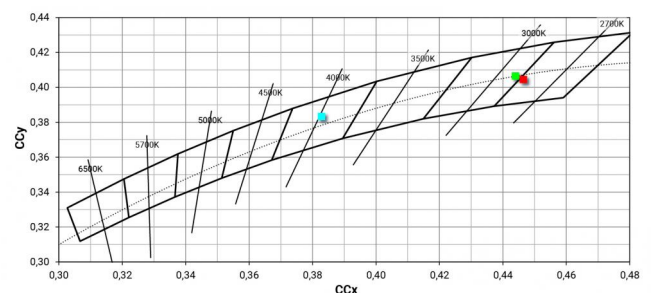
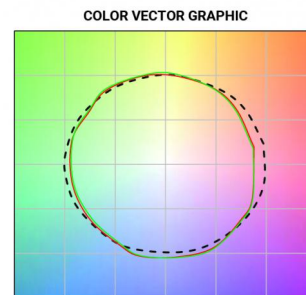
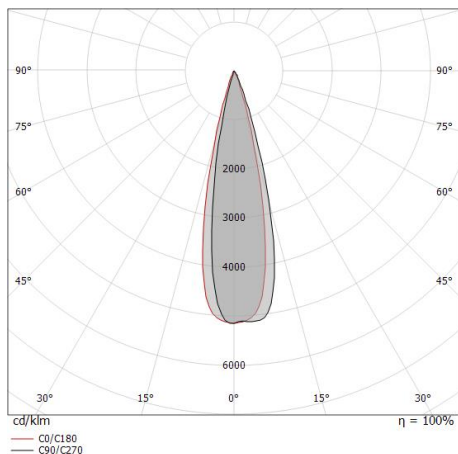
C0/C180 optics	25°
Light distribution symmetry	Asymmetrical



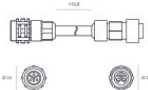

	<p>Cable and connector Length 2000 mm; insulation double; section 1.5 mm<sup>2</sup>; cable gland: no; external diameter: 9.5 mm; colors: blue - brown - yellow-green.</p>	<p><b>Code</b> <u>99057</u></p>	
	<p>Cable and connector Length 5000 mm; insulation double; section 1.5 mm<sup>2</sup>; cable gland: no; external diameter: 9.5 mm; colors: blue - brown - yellow-green.</p>	<p><b>Code</b> <u>98147</u></p>	
		<p>Cable and connector Length 10000 mm; insulation double; section 1.5 mm<sup>2</sup>; cable gland: no; external diameter: 9.5 mm; colors: blue - brown - yellow-green.</p>	<p><b>Code</b> <u>98146</u></p>