

# Ink system\_SP

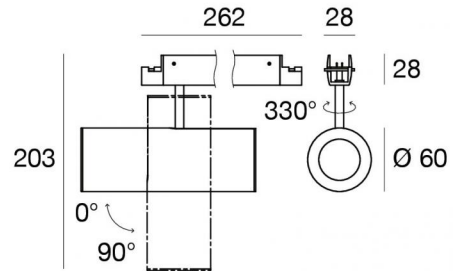

Systems - Lines | 1 arrayLED 22 W DC 24 V | CRI 90  
84000W35



Technical data	
Designer	Linea Light
Type	Cabled - -
Installation position	Cable
Installation environment	Indoor
Light Source	LED
Circuit structure	arrayLED
Optics	Medium Flood
Light emission direction	downward
Nominal power	22 W DC
Source lumens	2534 lm
Input voltage range	24 V
Frequency	50-60 Hz
CCT / Tone	3000 K
Colour rendering index	90 Ra
C.C. / C.V.	CV
Safety class	3
IP	IP40
Glow wire test	650°
Direct mounting on normally flammable surfaces	Yes
CE	Yes
Driver included	No
C.V. - C.C. Converter	Converter 24V included
Dimmable article	P2P
Directional	Swivelling
total angle (vertical plane)	330 °
Tilting	Yes
total angle (horizontal plane)	90 °
Walk-over	No
Drive-over	No
Cable included	No
Resin potting	No
Type of light emission	Single emission
Net weight	0.930 Kg
Electrostatic discharge protection	No
Surge protection	No
Optics technology	Honey comb

## Finishing casing

Material	Aluminium
Colour	5G 9005 Black
Processing	Coating



## Finishing diffuser

Material	PMMA
Colour	transparent

## Finishing mounting frame

Material	Aluminium
Colour	5G 9005 Black
Processing	Coating

## Electronics

	81416 On/Off Driver 220-240V AC 120 W
	81417 On/Off Driver 220-240V AC 180 W
	84018 DALI - DALI-2 - P2P Controller 24V DC 150 W



Systems - Lines | 1 arrayLED 22 W DC 24 V | CRI 90 | Base 84000W35

Single emission systems or lines for indoor application. The warm white LED light source with a medium flood light distribution is composed of 1 topped LEDs with CCT of 3000 K and a CRI 90; the source luminous flux is 2534 lm, with a 115.2 lm/W nominal luminous efficacy.

The device body is made of aluminium and features a 5g 9005 black finish, processed by means of coating; the diffuser is made of pmma; the mounting frame is made of aluminium, with a 5g 9005 black finish, processed by means of coating. The ingress protection degree is IP40; the total weight is of 0.930 kg.

The total absorbed power is 22 W.

The device features protection class III and can be cable-mounted.

Compliant with the EN 60598-1 standard and its specific provisions.

### Energy efficiency class

This product contains a light source of energy efficiency class F.

### Illuminotechnical Features

Light Output Ratio (LOR)	78 %
Source lumens	2534 lm
Delivered lumens	1977 lm
Consumption	22 W
Luminaire efficacy	89 lm/W
Colour temperature	3000 K
Standard Deviation of Colour Matching	3 Step MacAdam
Colour rendering index	90 Ra
Junction temperature (lighting fixture)	80

Standard Operating Ambient Temperature -20 / +50°C

### LED Life / Failure Ratio

L80 B20 C0 80000h

### UGR

UGR axial	17.3
UGR transversal	17.4
X=4H   Y=8H	S=0.25H
Reflection factor	70/50/20

### OPTICAL

C0/C180 optics	36°
Light distribution simmetry	Symmetrical

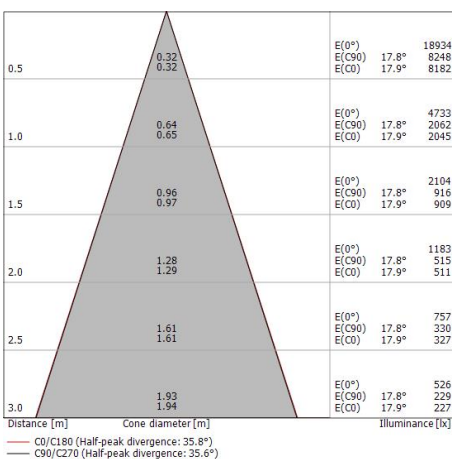
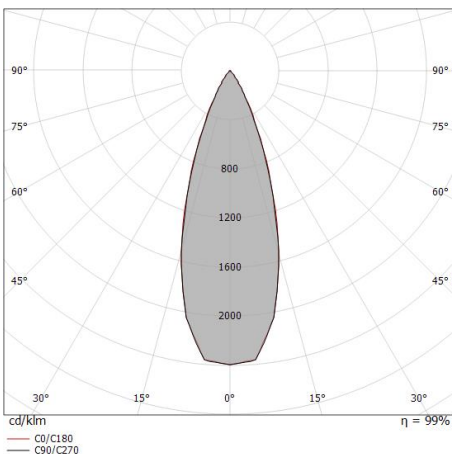



		<p><b>Cable</b> Type of cable power cable; Length 5000 mm; insulation double; section 1.5 mm<sup>2</sup>; cable gland: no; colors: black - red.</p>	<p><b>Code</b> <u>81410</u></p>
		<p><b>Cable</b> Type of cable power cable; Length 10000 mm; insulation double; section 1.5 mm<sup>2</sup>; cable gland: no; colors: black - red.</p>	<p><b>Code</b> <u>81411</u></p>
		<p><b>Cable</b> Type of cable power cable; Length 1000 mm; insulation double; section 1.5 mm<sup>2</sup>; cable gland: no; colors: black - red.</p>	<p><b>Code</b> <u>84016</u></p>
		<p><b>Tool</b></p>	<p><b>Code</b> <u>81427</u></p>
		<p><b>Profile - Recessed corner</b> Material:Aluminium, processing:Coating.</p>	<p><b>Code</b> <u>84015</u></p>
		<p><b>Profile - L. 1000mm</b> Material:Aluminium, processing:Coating.</p>	<p><b>Code</b> <u>84012</u></p>
		<p><b>Profile - L. 2000mm</b> Material:Aluminium, processing:Coating.</p>	<p><b>Code</b> <u>84013</u></p>
		<p><b>Profile - L. 3000mm</b> Material:Aluminium, processing:Coating.</p>	<p><b>Code</b> <u>84014</u></p>



Ink system\_SP | Lines | Accessories  
**84000W35**

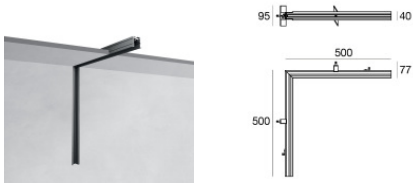

Profile - Recessed corner - IN  
Material:Aluminium, processing:Coating.

**Code**  
84073

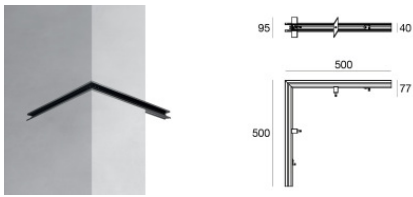

Profile - Recessed corner - OUT  
Material:Aluminium, processing:Coating.

**Code**  
84074

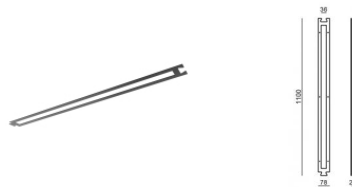

Template

**Code**  
83186



Closing cap - 2X  
Material:PC, colour:black.

**Code**  
83153