

Projectors | 198-264 V
1 arrayLED 23 W DC - 26 W AC | CRI 98
83806W15

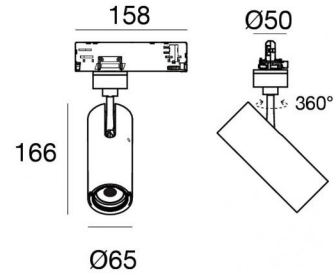

Technical data	
Type	Track
Installation position	Ceiling
Installation environment	Indoor
Light Source	LED
Circuit structure	arrayLED
Optics	Spot
Light emission direction	frontal
Nominal power	23 W DC
Total Power	26 W
Source lumens	2748 lm
Nominal input voltage	220 - 240 V AC
Input voltage range	198 - 264 V AC
Frequency	50 - 60 Hz
CCT / Tone	3000 K
Colour rendering index	98 Ra
C.C. / C.V.	AC
Safety class	2
IP	IP20
Glow wire test	850°
Direct mounting on normally flammable surfaces	Yes
CE	Yes
Driver included	Driver
Dimmable article	Bluetooth
Directional	Swivelling
total angle (vertical plane)	90 °
total angle (horizontal plane)	360 °
Tilting	No
Walk-over	No
Drive-over	No
Cable included	No
Resin potting	No
Type of light emission	Single emission
Net weight	0.612 Kg
Electrostatic discharge protection	Yes
Surge protection	2 KV
Optics technology	Anti - Glare

Finishing casing	
Material	Die-cast Aluminium EN AB - 46100
Colour	Black
Processing	Powder coating

Technology Partner
SILVAIR

Projectors | 198-264 V | 1 arrayLED 23 W DC - 26 W AC | CRI 98 | Base
83806W15

Single emission projectors for indoor application. The warm white LED light source with a spot light distribution is composed of 1 arrayed LEDs with CCT of 3000 K and a CRI 98; the source luminous flux is 2748 lm, with a 119.5 lm/W nominal luminous efficacy.

The device body is made of die-cast aluminium en ab - 46100 and features a black finish, processed by means of powder coating. The ingress protection degree is IP20; the total weight is of 0.612 kg.

The total absorbed power is 26 W.

The device features protection class II and can be ceiling-mounted.

Compliant with the EN 60598-1 standard and its specific provisions.

Energy efficiency class

This product contains a light source of energy efficiency class F.

Illuminotechnical Features

Source lumens	2748 lm
Colour temperature	3000 K
Standard Deviation of Colour Matching	2 Step MacAdam
Colour rendering index	98 Ra
Black Body Locus	Below
Standard Operating Ambient Temperature	-20 / +50°C
Ordinary temperature on the glass	40°C

LED Life / Failure Ratio

L70 B10 C0 252000h (at Tj 65 Ta 25)

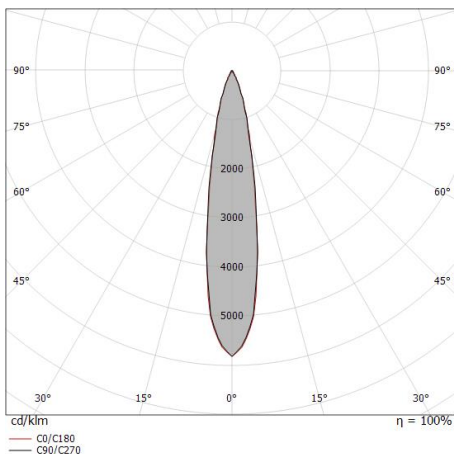

Distance [m]	Cone diameter [m]	illuminance [lx]
0.5	0.17 0.17	E(0°) 42608 E(C90) 9.7° 20547 E(C0) 9.6° 20535
1.0	0.34 0.34	E(0°) 10652 E(C90) 9.7° 5137 E(C0) 9.6° 5134
1.5	0.51 0.51	E(0°) 4734 E(C90) 9.7° 2283 E(C0) 9.6° 2282
2.0	0.68 0.68	E(0°) 2663 E(C90) 9.7° 1284 E(C0) 9.6° 1283
2.5	0.85 0.85	E(0°) 1704 E(C90) 9.7° 822 E(C0) 9.6° 821
3.0	1.03 1.01	E(0°) 1184 E(C90) 9.7° 571 E(C0) 9.6° 570

— C0/C180 (Half-peak divergence: 19.2°)
 — C90/C270 (Half-peak divergence: 19.4°)

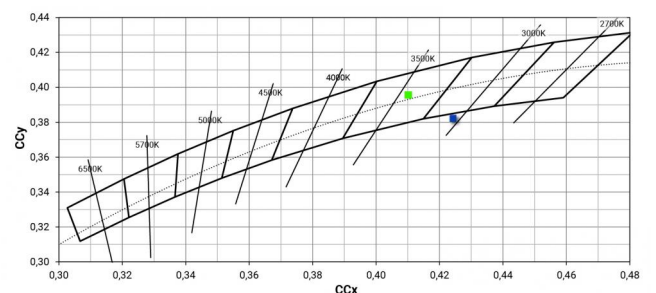
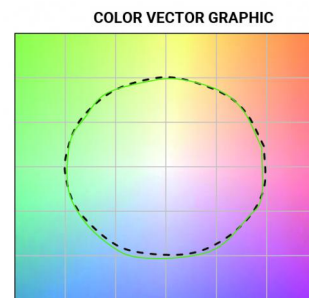

Pound_T | Projectors | Accessories
83806W15



Optics
 Light distribution: spot,Cover material: uv resistant polycarbonate

Code
99827



Optics
 Light distribution: medium flood,Cover material: uv resistant polycarbonate

Code
99828



Optics
 Light distribution: flood,Cover material: uv resistant polycarbonate

Code
99829

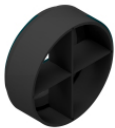

Anti-glare
 Anti-glare Type: cross louveres.
 Material:Pom-C, colour:Black.

Code
99779



Anti-glare
 Anti-glare Type: honeycomb louvere.
 Material:Pom-C, colour:Black.

Code
99780



Diffuser
 Diffuser Type: elliptical filter.
 Material:Pom-C, colour:Black.

Code
99781



Anti-glare
 Anti-glare Type: 45° cylindrical screen.
 Material:Pom-C, colour:Black.

Code
99782

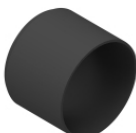

Anti-glare
 Anti-glare Type: cylindrical screen.
 Material:Pom-C, colour:Black.

Code
99783

Pound_T | Projectors | Accessories
83806W15

		<p>Track Length: 1000mm; Type of track: Standard. Material:Aluminium, colour:White, processing:Coating.</p>	<table border="1"> <thead> <tr> <th>Finish</th> <th>Code</th> </tr> </thead> <tbody> <tr> <td>White</td> <td>83336</td> </tr> </tbody> </table>	Finish	Code	White	83336
Finish	Code						
White	83336						
		<p>Track Length: 1000mm; Type of track: Standard. Material:Aluminium, colour:Black, processing:Coating.</p>	<table border="1"> <thead> <tr> <th>Finish</th> <th>Code</th> </tr> </thead> <tbody> <tr> <td>Black</td> <td>83339</td> </tr> </tbody> </table>	Finish	Code	Black	83339
Finish	Code						
Black	83339						
		<p>Track Length: 3000mm; Type of track: Standard. Material:Aluminium, colour:Black, processing:Coating.</p>	<table border="1"> <thead> <tr> <th>Finish</th> <th>Code</th> </tr> </thead> <tbody> <tr> <td>Black</td> <td>83341</td> </tr> </tbody> </table>	Finish	Code	Black	83341
Finish	Code						
Black	83341						
		<p>Track - Three-phase Recessed White DALI Track, 2 m (9000-2/W-R) Length: 2000mm; Type of track: Standard. Material:Aluminium, colour:White, processing:Coating.</p>	<table border="1"> <thead> <tr> <th>Finish</th> <th>Code</th> </tr> </thead> <tbody> <tr> <td>White</td> <td>80991</td> </tr> </tbody> </table>	Finish	Code	White	80991
Finish	Code						
White	80991						
		<p>Track - Three-phase Recessed Grey DALI Track, 1 m (9000-1/B-R) Length: 1000mm; Type of track: Standard. Material:Aluminium, colour:Black, processing:Coating.</p>	<table border="1"> <thead> <tr> <th>Finish</th> <th>Code</th> </tr> </thead> <tbody> <tr> <td>Black</td> <td>80993</td> </tr> </tbody> </table>	Finish	Code	Black	80993
Finish	Code						
Black	80993						
		<p>Track - Three-phase Recessed White DALI Track, 3 m (9000-3/W-R) Length: 3000mm; Type of track: Standard. Material:Aluminium, colour:White, processing:Coating.</p>	<table border="1"> <thead> <tr> <th>Finish</th> <th>Code</th> </tr> </thead> <tbody> <tr> <td>White</td> <td>80992</td> </tr> </tbody> </table>	Finish	Code	White	80992
Finish	Code						
White	80992						
		<p>Power supply - White Right power supply header (9001/W) Material:PC, colour:white.</p>	<table border="1"> <thead> <tr> <th>Code</th> </tr> </thead> <tbody> <tr> <td>81033</td> </tr> </tbody> </table>	Code	81033		
Code							
81033							
		<p>Power supply - Black left power supply header (9002/B) Material:PC, colour:black.</p>	<table border="1"> <thead> <tr> <th>Code</th> </tr> </thead> <tbody> <tr> <td>81037</td> </tr> </tbody> </table>	Code	81037		
Code							
81037							

Pound_T | Projectors | Accessories
83806W15

		<p>Junction - White power supply junction - central (9010/W) Type linear. Material:PC, colour:white.</p>	<p>Finish White</p>	<p>Code 81042</p>
		<p>Junction - Black power supply junction - centrale (9010/B) Type linear. Material:PC, colour:black.</p>	<p>Finish Black</p>	<p>Code 81043</p>
		<p>Track - Three-phase Recessed Black DALI Track, 2 m (9000-1/B-R) Length: 2000mm; Type of track: Standard. Material:Aluminium, colour:Black, processing:Coating.</p>	<p>Finish Black</p>	<p>Code 80994</p>
		<p>Power supply - White left power supply header (9002/W) Material:PC, colour:white.</p>		<p>Code 81036</p>
		<p>Junction - Left white T junction - external (9013/W) Type linear. Material:PC, colour:white.</p>	<p>Finish White</p>	<p>Code 81051</p>
		<p>Junction - Black left T junction - external (9013/B) Type linear. Material:PC, colour:black.</p>	<p>Finish Black</p>	<p>Code 81052</p>
		<p>Track Length: 2000mm; Type of track: Standard. Material:Aluminium, colour:White, processing:Coating.</p>	<p>Finish White</p>	<p>Code 83337</p>
		<p>Track Length: 2000mm; Type of track: Standard. Material:Aluminium, colour:Black, processing:Coating.</p>	<p>Finish Black</p>	<p>Code 83340</p>

Pound_T | Projectors | Accessories
83806W15

		<p>Junction - Flexible white junction (9018/W) Type flexible curve. Material:PC, colour:white.</p>	<p>Finish White</p>	<p>Code 81066</p>
		<p>Closing cap - White end cap 9004/W Material:PC, colour:white.</p>	<p>Code 80999</p>	<p>Code 80999</p>
		<p>Junction - White electrical junction - internal (9003/W) Type linear. Material:PC, colour:white.</p>	<p>Finish White</p>	<p>Code 81039</p>
		<p>Track - Three-phase Recessed Black DALI Track, 3 m (9000-3/B-R) Length: 3000mm; Type of track: Standard. Material:Aluminium, colour:Black, processing:Coating.</p>	<p>Finish Black</p>	<p>Code 80995</p>
		<p>Junction - Right white T junction - external (9014/W) Type linear. Material:PC, colour:white.</p>	<p>Finish White</p>	<p>Code 81054</p>
		<p>Junction - Black electrical junction - internal (9003/B) Type linear. Material:PC, colour:black.</p>	<p>Finish Black</p>	<p>Code 81040</p>
		<p>Junction - White L junction - internal (9011/W) Type linear. Material:PC, colour:white.</p>	<p>Finish White</p>	<p>Code 81045</p>
		<p>Junction - Flexible black junction (9018/B) Type flexible curve. Material:PC, colour:black.</p>	<p>Finish Black</p>	<p>Code 81067</p>

Pound_T | Projectors | Accessories
83806W15

		<p>Power supply - Black Right power supply header (9001/B) Material:PC, colour:black.</p>	<p>Code 81034</p>
		<p>Junction - White X junction (9017/W) Type linear. Material:PC, colour:white.</p>	<p>Finish White Code 81063</p>
		<p>Track - Three-phase Recessed White DALI Track, 1 m (9000-1/W-R) Length: 1000mm; Type of track: Standard. Material:Aluminium, colour:White, processing:Coating.</p>	<p>Finish White Code 80990</p>
		<p>Closing cap - Black end cap 9004/B Material:PC, colour:black.</p>	<p>Code 81000</p>
		<p>Junction - Left black T junction - internal (9015/B) Type linear. Material:PC, colour:black.</p>	<p>Finish Black Code 81058</p>
		<p>Junction - Right black T junction - internal (9016/B) Type linear. Material:PC, colour:black.</p>	<p>Finish Black Code 81061</p>
		<p>Closing cap - Recessed white end cap 9004-R/W Material:PC, colour:white.</p>	<p>Code 81002</p>
		<p>Junction - Left white T junction - internal (9015/W) Type linear. Material:PC, colour:white.</p>	<p>Finish White Code 81057</p>

Pound_T | Projectors | Accessories
83806W15

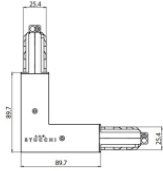

Junction - Black L junction - internal (9011/B)
 Type linear.
 Material:PC, colour:black.

Finish	Code
Black	81046

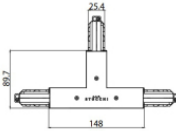

Junction - Right White T junction - internal (9016/W)
 Type linear.
 Material:PC, colour:white.

Finish	Code
White	81060

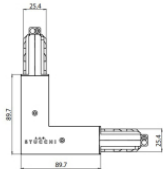

Junction - Black L junction - external (9012/B)
 Type linear.
 Material:PC, colour:black.

Finish	Code
Black	81049



Ceiling rose - 5m black pendant luminaires kit + bracket (9000-KIT5-5-B)
 Material:plastic, colour:black.

Code
81015



Suspensions - White rigid suspension 1m (S-9000-P3-W)
 Material:plastic, colour:white.

Code
81021



Suspensions - Black rigid suspension 1m (S-9000-P3-B)
 Material:plastic, colour:black.

Code
81022

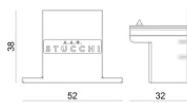

Closing cap - Recessed black end cap 9004-R/B
 Material:PC, colour:black.

Code
81003

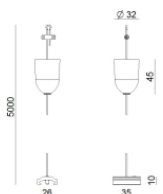

Ceiling rose - 5m white pendant luminaires kit + bracket (9000-KIT5-5-W)
 Material:plastic, colour:white.

Code
81013

Pound_T | Projectors | Accessories
83806W15



Ceiling rose - 1.5m white pendant luminaires kit + bracket (9000-KIT5-1,5-W)
 Material:plastic, colour:white.

Code
81012

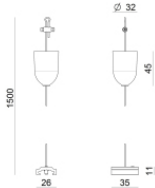

Ceiling rose - 1.5m black pendant luminaires kit + bracket ((9000-KIT5-1,5-B)
 Material:plastic, colour:black.

Code
81014



Bracket - Anodized fixing bracket (S-9000/131)
 L=35mm, H=14mm, D=24mm.
 Material:Aluminium, colour:translucent.

Finish
 Anod. Al. **Code**
81086



Bracket - White fixing braket (S-9000/131-W)
 L=35mm, H=14mm, D=24mm.
 Material:Aluminium, colour:white, processing:Coating.

Finish
 White **Code**
81087



Bracket - Black fixing braket (S-9000/131-B)
 L=35mm, H=14mm, D=24mm.
 Material:Aluminium, colour:Black, processing:Coating.

Finish
 Black **Code**
81088



Cable cover - White cover for recessed L junction (S-9011-R/6-W)
 Material:PC, colour:white.

Code
81075

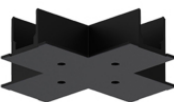

Cable cover - Black cover for recessed X junction (S-9017-R/6-B)
 Material:PC, colour:black.

Code
81082

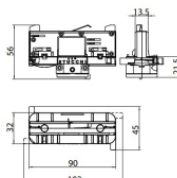

White three-phase adapter (9009-4/W)

Code
81091

Pound_T | Projectors | Accessories
83806W15

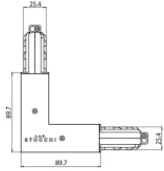

Junction - White L junction - external (9012/W)
 Type linear.
 Material:PC, colour:white.

Finish	Code
White	81048

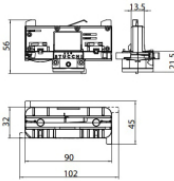

Black three-phase adapter (9009-4/B)

Code
81093



Suspensions - 1.5m white pendant luminaires kit (9000-KIT3-1,5-W)
 Material:plastic, colour:white.

Code
81006



Cable cover - White recessed cover (S-9001-R/6-W)
 Material:PC, colour:white.

Code
81069



Suspensions - 5m white pendant luminaires kit (9000-KIT3-5-W)
 Material:plastic, colour:white.

Code
81007



Tool - Cutter S-9000/T

Code
81005

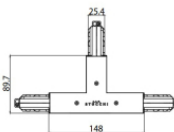

Junction - Right black T junction - external (9014/B)
 Type linear.
 Material:PC, colour:black.

Finish	Code
Black	81055



Suspensions - White rigid suspension clip (S-9000-P2-W)
 Material:plastic, colour:white.

Code
81018

Pound_T | Projectors | Accessories
83806W15

		<p>Cable cover - Black recessed cover (S-9001-R/6-B) Material:PC, colour:black.</p>	<p>Code <u>81070</u></p>
		<p>Cable cover - White cover for recessed X junction (S-9017-R/6-W) Material:PC, colour:white.</p>	<p>Code <u>81081</u></p>
		<p>Bracket - Black stiffening bracket (S-9000/333-B) L=180mm, H=24mm, D=20mm. Material:Aluminium, colour:black RAL 9005, processing:Coating.</p>	<p>Finish Black Code <u>81026</u></p>
		<p>Cable cover - White cover for recessed junction (S-9010-R/6-W) Material:PC, colour:white.</p>	<p>Code <u>81072</u></p>
		<p>Suspensions - 1.5m black pendant luminaires kit (9000-KIT3-1,5-B) Material:plastic, colour:black.</p>	<p>Code <u>81008</u></p>
		<p>Junction - Black X junction (9017/B) Type linear. Material:PC, colour:black.</p>	<p>Finish Black Code <u>81064</u></p>
		<p>Cable cover - Black cover for recessed T junction (S-9013-R/6-B) Material:PC, colour:black.</p>	<p>Code <u>81079</u></p>
		<p>Cable cover Material:white.</p>	<p>Code <u>83249</u></p>

Pound_T | Projectors | Accessories
83806W15



Bracket - Anodized stiffening bracket (S-9000/333)

L=180mm, H=24mm, D=26mm.

Material:Aluminium, colour:Anodised Aluminum, processing:Anodisation.

Finish	Code
	81024



Bracket - White stiffening bracket (S-9000/333-W)

L=180mm, H=24mm, D=20mm.

Material:Aluminium, colour:white RAL 9010, processing:Coating.

Finish	Code
	81025

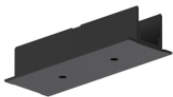

Cable cover - Black cover for recessed junction (S-9010-R/6-B)

Material:PC, colour:black.

Code
81073

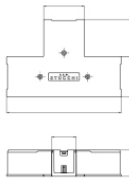
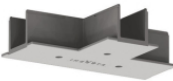

Cable cover - White cover for recessed T junction (S-9013-R/6-W)

Material:PC, colour:white.

Code
81078



Suspensions - Black rigid suspension clip (S-9000-P2-B)

Material:plastic, colour:black.

Code
81019

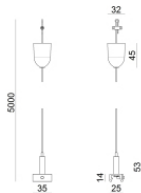

Suspensions - 5m black pendant luminaire kit (9000-KIT3-5-B)

Material:plastic, colour:black.

Code
81009



Cable cover

Material:black, colour:black.

Code
83250

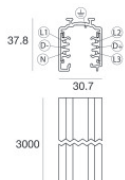

Track

Length: 3000mm; Type of track: Standard.

Material:Aluminium, colour:White, processing:Coating.

Finish	Code
	83338

Pound_T | Projectors | Accessories
83806W15

		<p>Cable cover Material:PC, colour:black.</p>	<p>Code <u>81076</u></p>
--	--	--	--------------------------------------

		<p>Closing cap - White gasket (S-9001/115-W) Material:white.</p>	<p>Code <u>81084</u></p>
--	--	---	--------------------------------------

		<p>Closing cap - Black gasket (S-9001/115-B) Material:black, colour:black.</p>	<p>Code <u>81085</u></p>
--	--	---	--------------------------------------

		<p>White three-phase/DALI adapter (9009/W)</p>	<p>Code <u>81094</u></p>
--	--	--	--------------------------------------

		<p>Black three-phase/DALI adapter (9009/B)</p>	<p>Code <u>81095</u></p>
--	--	--	--------------------------------------

		<p>Electronic accessory - TWIL-DALI controller for devices with DALI protocol installed on three-phase track. installation position: ceiling L=90mm, H=124mm, D=45mm. Material:ABS Plastic, colour:black.</p>	<p>Code <u>C-E700008</u></p>
--	--	---	--

Wiring Diagram

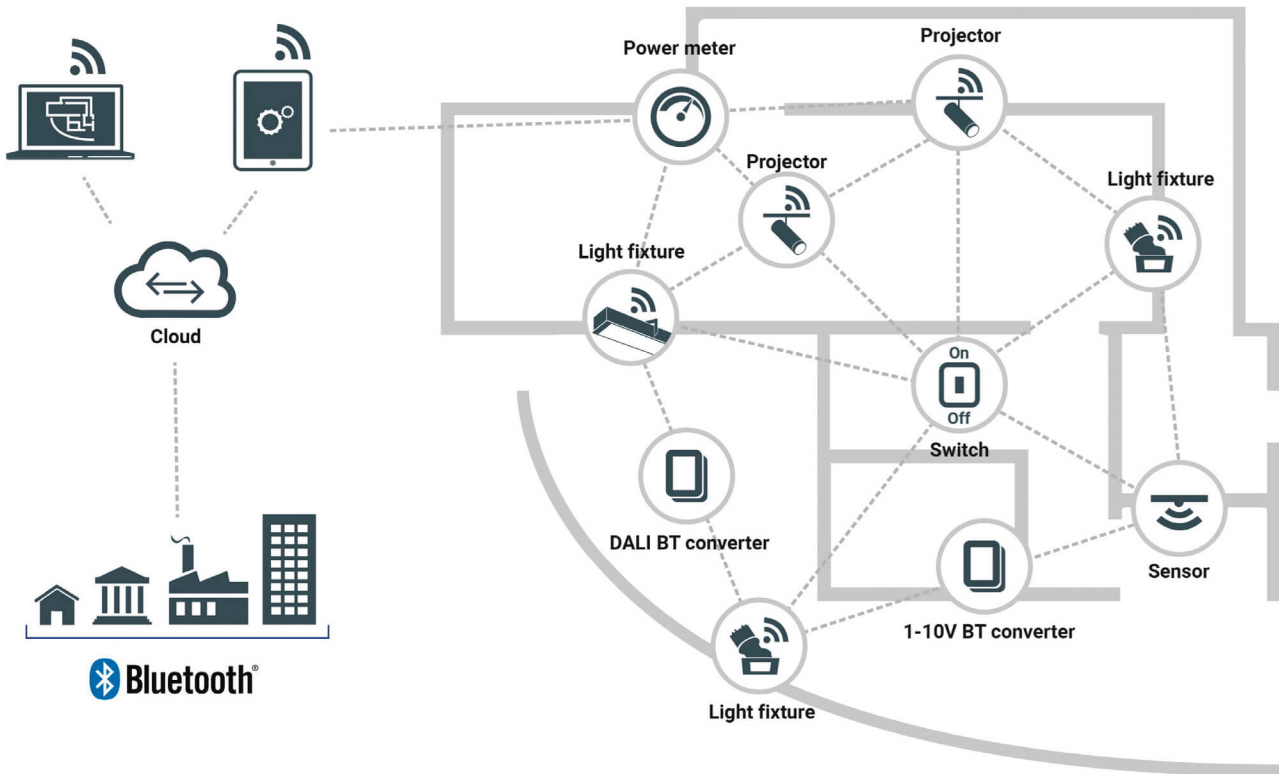

Identify

The first time the device is turned on and every time it gets reseted, the system identify the lamps. The identification consists in an animation called "Attention event" with a 40% dimming for 500ms, 100% dimming for 500ms. The blue status LED blinks during identification too, 500msON/500ms OFF.

Bluetooth - Factory reset for Bluetooth device

A factory reset of the bluetooth device will change the device status in the network mesh from provisioned to not provisioned, all the network settings will be lost. This feature is necessary to reset the connection of a device which cannot be longer controlled. To perform the factory reset action on the device a magnet must be placed on the shown symbol on the box containing the bluetooth module. Keep contact for 5 seconds. Once the factory reset operation is done the system will identify the device.



Antenna

The antenna is incorporated into the article.

LED Blinking

The blue status LED placed on the box containing the Bluetooth interface performs a blink pattern depending on the lamp status.

Quick blinking/slow blinking

The LED blinks fast if the lamp is not connected to the network (every 300ms)
The LED blinks slowly if the lamp is connected to the network (every 2s)

Unprovisioned



Provisioned



Factory Reset

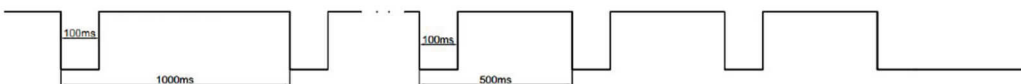

Mesh packet received



Other informations

- If the device is encased in a box, the wireless range may be affected, especially by metallic surfaces. Wireless range must be verified.
- Anunprovisioned device requires 30 seconds to be shown as available to provisioning after turning on
- The device successfully passed the SILVAIR test process
- Supporting EnOcean switch 83017
- Supporting Murata 83016 sensors
- The device can be operated with the SILVAIR app available for Apple phones and tablets
- Check the SILVAIR guide for more informations <https://silvair.com/resources/product-documents/>
- Linea Light has no responsibility for any third party instrument and does not provide any declaration, explicit or implicit, about the availability and/or the performances of said instrument.

POUND_T POUND FOCUS

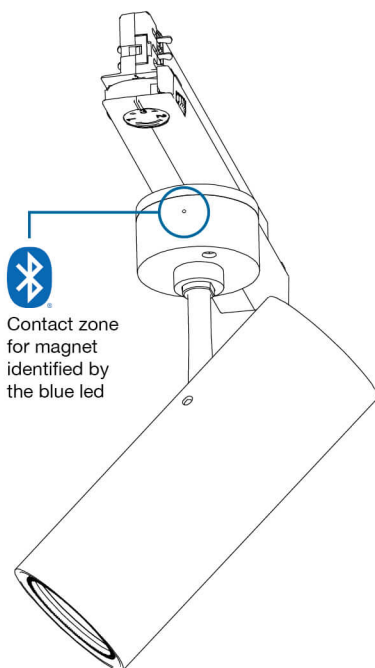

POUND SHAPER

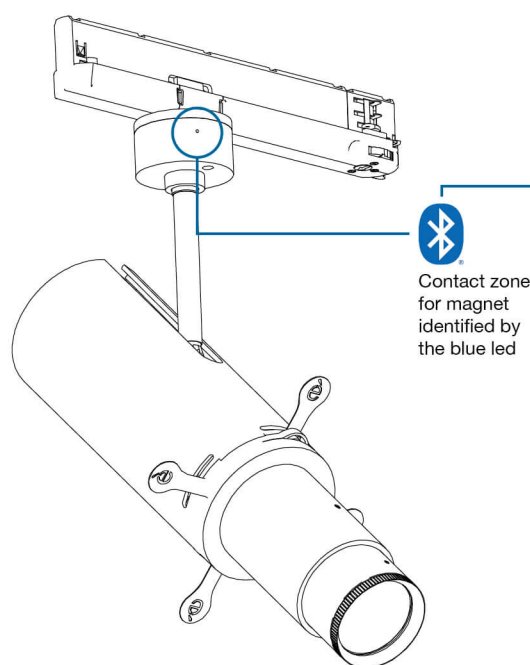

OPTUS_T

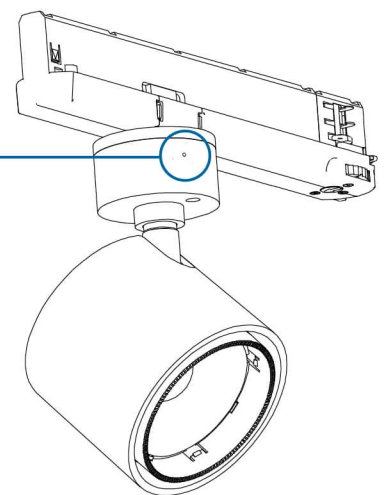

OPTUS_Ww

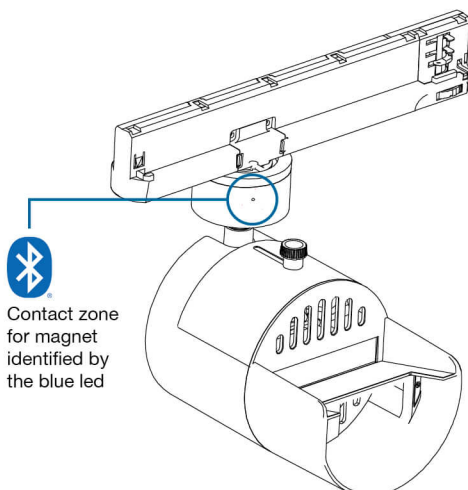

Base NAVATA OPTUS NAVATA POUND SHAPER

