

# Step66

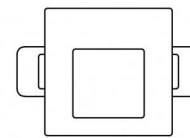

Wall Lights | 1 x powerLED 1 W DC 350 mA | CRI 80  
82741A07

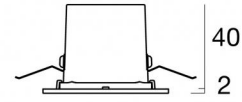

□ 50

40 x  
45

Technical data	
Type	Encasement with flange - -
Installation position	Wall lights
Installation environment	Outdoor
Light Source	LED
Circuit structure	powerLED
Optics	Asymmetric Wallwasher
Light emission direction	downward
Nominal power	1 W DC
Source lumens	111 lm
Input voltage range	350mA
CCT / Tone	2200 K
Colour rendering index	80 Ra
C.C. / C.V.	CC
Safety class	3
IP	IP65
IK	IK08
Glow wire test	850°
Direct mounting on normally flammable surfaces	Yes
CE	Yes
Driver included	No
Dimmable article	DALI - 1-10V
Directional	No
Tilting	No
Walk-over	No
Drive-over	No
Cable included	Yes
Cable length	0.5 m
Resin potting	No
Type of light emission	Single emission
Net weight	0.027 Kg
Electrostatic discharge protection	No
Surge protection	No
Product technological characteristics	TVS

## Finishing casing

Material	Die-cast Aluminium EN AB - 46100
Colour	Aluminium

## Finishing diffuser

Material	Extra clear glass - Tempered
Colour	transparent

## Finishing flange

Material	UV Resistant Polycarbonate
Colour	chrome
Processing	Metallization

## Electronics

 89421  
On/Off Driver 198~264V AC / 176~275V DC (3 - 6 art.)

 89419  
On/Off Driver 198~264V AC / 176~275V DC (1 - 2 art.)

 C-E200006  
On/Off Driver 198~264V AC / 180~275V DC (6 - 12 art.)

## Wall Lights | 1 x powerLED 1 W DC 350 mA | CRI 80 | Base 82741A07

Single emission wall lights for outdoor application. The ancient white LED light source with a asymmetric wallwasher light distribution is composed of 1 powerled LEDs with CCT of 2200 K and a CRI 80; the source luminous flux is 111 lm, with a 111.0 lm/W nominal luminous efficacy.

The device body is made of die-cast aluminium en ab - 46100 and features a aluminium finish; the diffuser is made of extra clear glass - tempered. The ingress protection degree is IP65; the total weight is of 0.027 kg. The power supply driver is not provided and is to be ordered separately.

The total absorbed power is 1 W. The power supply cable is included and features a 0.5 m length.

The device features protection class III and can be wall lights-mounted, with a 40 x 45 mm hole (in plasterboard) with an outer casing, code 83181 (for concrete or masonry).

Compliant with the EN 60598-1 standard and its specific provisions.

### Energy efficiency class

This product contains a light source of energy efficiency class F.

### Illuminotechnical Features

Light Output Ratio (LOR)	45 %
Source lumens	111 lm
Delivered lumens	50 lm
Consumption	1,0 W
Luminaire efficacy	50 lm/W
Colour temperature	2200 K
Standard Deviation of Colour Matching	1/16 ANSI BIN
Colour rendering index	80 Ra
Standard Operating Ambient Temperature	-20 / +50°C
Ordinary temperature on the glass	40°C

### LED Life / Failure Ratio

L70 B10 C0 361980h

### OPTICAL

C0/C180 optics	73°
Light distribution simmetry	Asymmetrical

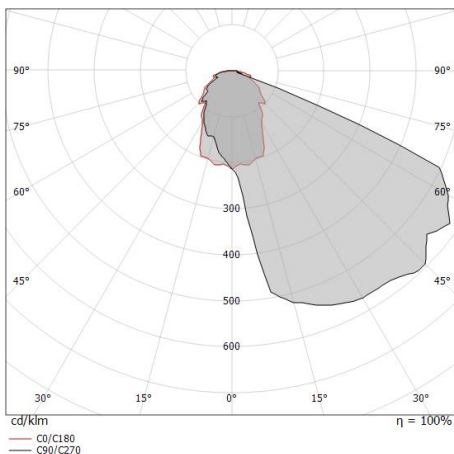

Distance [m]	Cone diameter [m]	Illuminance [lx]
0.5	0.73	E(0°) 42 E(C0) 11
1.0	1.47	E(0°) 11 E(C0) 3
1.5	2.20	E(0°) 5 E(C0) 1
2.0	2.94	E(0°) 3 E(C0) 1
2.5	3.67	E(0°) 2 E(C0) 0
3.0	4.41	E(0°) 1 E(C0) 0

Distance [m] Cone diameter [m] Illuminance [lx]  
 — C0/C180 (Half-peak divergence: 72.6°)



Step66 | Step Lights | Accessories  
**82741A07**

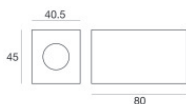
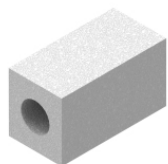

Outer casing

installation position: wall lights; type of installation: masonry L=45mm, H=40.5mm,  
D=80mm

**Code**

83181