

Navata_Optus

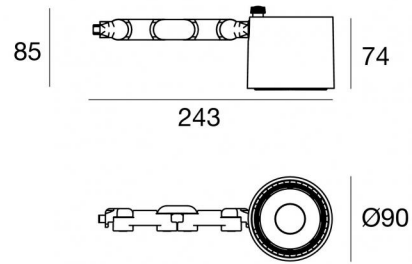

Projectors | 1 arrayLED 24 W DC 700 mA | CRI 98
82391W30



| Technical data | |
|--|----------------------------------|
| Type | Surface |
| Installation position | Wall lights - Ceiling - Floor |
| Installation environment | Indoor |
| Light Source | LED |
| Circuit structure | arrayLED |
| Optics | Flood |
| Light emission direction | frontal |
| Nominal power | 24 W DC |
| Source lumens | 3978 lm |
| Input voltage range | 700mA |
| CCT / Tone | 3000 K |
| Colour rendering index | 98 Ra |
| C.C. / C.V. | CC |
| Safety class | 3 |
| IP | IP20 |
| Glow wire test | 850° |
| Direct mounting on normally flammable surfaces | Yes |
| CE | Yes |
| Driver included | No |
| Dimmable article | DALI - 1-10V |
| Directional | Swivelling |
| total angle (vertical plane) | 180 ° |
| total angle (horizontal plane) | 360 ° |
| Tilting | No |
| Walk-over | No |
| Drive-over | No |
| Cable included | Yes |
| Cable length | 0,2 m |
| Resin potting | No |
| Type of light emission | Single emission |
| Net weight | 0.600 Kg |
| Electrostatic discharge protection | No |
| Surge protection | No |

Finishing casing

| | |
|------------|-----------|
| Material | Aluminium |
| Colour | White |
| Processing | Coating |

Electronics



99112
On/Off Driver 198~264V AC (1 art.)



99938
Multi Power 198~264V AC / 176~264V DC (1 art.)



99936
Push and Simply Dim - DALI-2 Controller (1 art.)



99946
DALI Multi Power 198~264V AC / 176~275V DC (1 art.)



99948
Multi Power 198~264V AC / 176~264V DC (1 art.)



83171
Bluetooth Controller (1 art.)



C-E100008
Multi Power 198~264V AC / 180~275V DC (1 art.)



Projectors | 1 arrayLED 24 W DC 700 mA | CRI 98 | Base 82391W30

Single emission projectors for indoor application. The warm white LED light source with a flood light distribution is composed of 1 arrayled LEDs with CCT of 3000 K and a CRI 98; the source luminous flux is 3978 lm, with a 165.8 lm/W nominal luminous efficacy.

The device body is made of aluminium and features a white finish, processed by means of coating. The ingress protection degree is IP20; the total weight is of 0.600 kg. The power supply driver is not provided and is to be ordered separately.

The total absorbed power is 24 W. The power supply cable is included and features a 0,2 m length.

The device features protection class III and can be wall lights, ceiling or floor-mounted.

Compliant with the EN 60598-1 standard and its specific provisions.

Energy efficiency class

This product contains a light source of energy efficiency class E.

Illuminotechnical Features

| | |
|--|----------------|
| Light Output Ratio (LOR) | 68 % |
| Source lumens | 3978 lm |
| Delivered lumens | 2724 lm |
| Consumption | 24 W |
| Luminaire efficacy | 113 lm/W |
| Colour temperature | 3000 K |
| Standard Deviation of Colour Matching | 2 Step MacAdam |
| Colour rendering index | 98 Ra |
| Black Body Locus | On |
| Standard Operating Ambient Temperature | -20 / +50°C |
| Ordinary temperature on the glass | 40°C |

LED Life / Failure Ratio

L70 B10 C0 252000h (at Tj 65 Ta 25)

UGR

| | |
|-------------------|----------|
| UGR axial | 11.7 |
| UGR transversal | 11.7 |
| X=4H Y=8H | S=0.25H |
| Reflection factor | 70/50/20 |

OPTICAL

| | |
|-----------------------------|-------------|
| C0/C180 optics | 25° |
| Light distribution simmetry | Symmetrical |

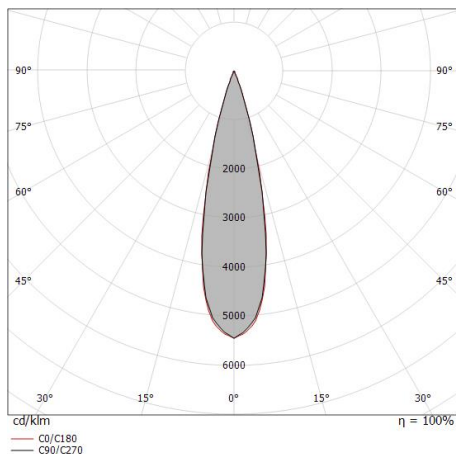

| Distance [m] | Cone diameter [m] | illuminance [lx] |
|--------------|-------------------|--|
| 0.5 | 0.22 0.22 | E(0°) 59313 E(C90) 12.5° 27742 E(C0) 12.6° 27815 |
| 1.0 | 0.44 0.45 | E(0°) 14828 E(C90) 12.5° 6936 E(C0) 12.6° 6954 |
| 1.5 | 0.67 0.67 | E(0°) 6590 E(C90) 12.5° 3082 E(C0) 12.6° 3091 |
| 2.0 | 0.89 0.89 | E(0°) 3707 E(C90) 12.5° 1734 E(C0) 12.6° 1738 |
| 2.5 | 1.11 1.12 | E(0°) 2373 E(C90) 12.5° 1110 E(C0) 12.6° 1113 |
| 3.0 | 1.33 1.34 | E(0°) 1648 E(C90) 12.5° 771 E(C0) 12.6° 773 |

— C0/C180 (Half-peak divergence: 25.2°)
— C90/C270 (Half-peak divergence: 25.0°)

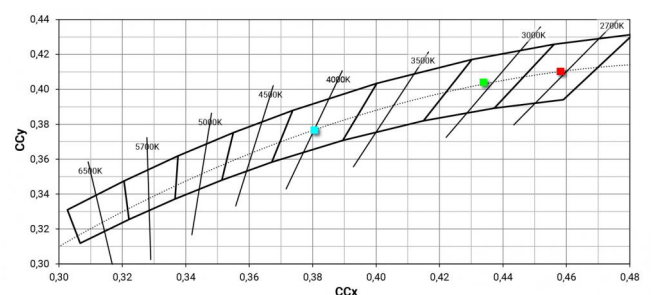
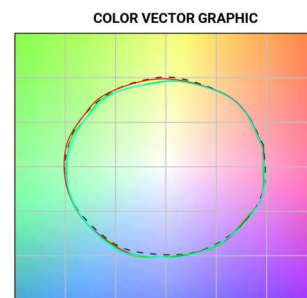



Fixing base - Base without power supply
Material:Iron, colour:White, processing:Coating.

Code
98588



Optics - Focal kit (min 16° max 42°)
Light distribution: adjustable,Cover material: aluminium

Code
99843



Diffuser
Diffuser Type: elliptical filter.
Material:Pom-C, colour:Black.

Code
99797

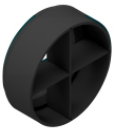

Anti-glare
Anti-glare Type: cross louvres.
Material:Pom-C, colour:Black.

Code
99799



Anti-glare
Anti-glare Type: honeycomb louvre.
Material:Pom-C, colour:Black.

Code
99798



Anti-glare
Anti-glare Type: 45° cylindrical screen.
Material:Pom-C, colour:Black.

Code
99795



Anti-glare
Anti-glare Type: cylindrical screen.
Material:Pom-C, colour:Black.

Code
99796



Optics
Light distribution: spot,Cover material: uv resistant polycarbonate

Code
99808



Optics
Light distribution: medium flood,Cover material: uv resistant polycarbonate

Code
99809



Optics
Light distribution: flood,Cover material: uv resistant polycarbonate

Code
99810

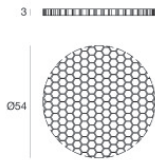

Anti-glare
Anti-glare Type: honeycomb louvre.
Material:Pom-C, colour:Black.

Code
99842