

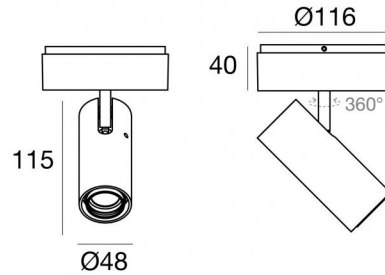

Ceiling Downlights | 110-240 V
1 arrayLED 13 W DC - 15.5 W AC | CRI 90
82366M15



Technical data	
Type	Surface
Installation position	Ceiling
Installation environment	Indoor
Light Source	LED
Circuit structure	arrayLED
Optics	Spot
Light emission direction	frontal
Nominal power	13 W DC
Total Power	15.5 W
Source lumens	1669 lm
Nominal input voltage	220 - 240 V AC
Input voltage range	110 - 240 V AC
Frequency	50 - 60 Hz
CCT / Tone	2700 K
Colour rendering index	90 Ra
C.C. / C.V.	AC
Safety class	1
IP	IP20
Glow wire test	850°
Direct mounting on normally flammable surfaces	Yes
CE	Yes
Driver included	Driver
Dimmable article	DALI
Directional	Swivelling
total angle (vertical plane)	90 °
total angle (horizontal plane)	360 °
Tilting	No
Walk-over	No
Drive-over	No
Cable included	No
Resin potting	No
Type of light emission	Single emission
Net weight	0.390 Kg
Electrostatic discharge protection	Yes
Surge protection	3.75 KV
Optics technology	Anti - Glare

Finishing casing	
Material	Die-cast Aluminium EN AB - 46100
Colour	Black
Processing	Powder coating



Ceiling Downlights | 110-240 V | 1 arrayLED 13 W DC - 15.5 W AC | CRI 90 | Base
82366M15

Single emission ceiling downlights for indoor application. The super warm white LED light source with a spot light distribution is composed of 1 arrayed LEDs with CCT of 2700 K and a CRI 90; the source luminous flux is 1669 lm, with a 128.4 lm/W nominal luminous efficacy.

The device body is made of die-cast aluminium en ab - 46100 and features a black finish, processed by means of powder coating. The ingress protection degree is IP20; the total weight is of 0.390 kg.

The total absorbed power is 15.5 W.

The device features protection class I and can be ceiling-mounted.

Compliant with the EN 60598-1 standard and its specific provisions.

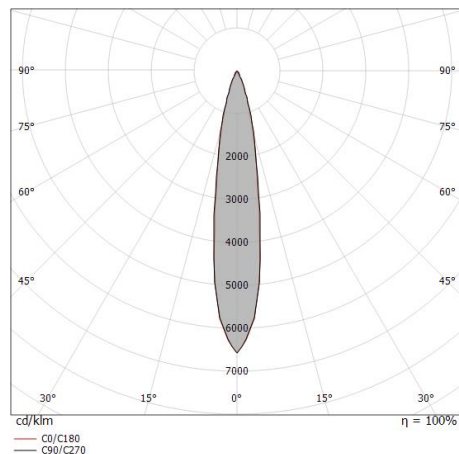

Distance [m]	Cone diameter [m]	illuminance [lx]
0.5	0.16 0.16	E(0°) 28010 E(C90) 9.2° 13491 E(C0) 8.9° 13677
1.0	0.32 0.31	E(0°) 7003 E(C90) 9.2° 3373 E(C0) 8.9° 3419
1.5	0.49 0.47	E(0°) 3112 E(C90) 9.2° 1499 E(C0) 8.9° 1520
2.0	0.65 0.63	E(0°) 1751 E(C90) 9.2° 843 E(C0) 8.9° 855
2.5	0.81 0.78	E(0°) 1120 E(C90) 9.2° 540 E(C0) 8.9° 547
3.0	0.97 0.94	E(0°) 778 E(C90) 9.2° 375 E(C0) 8.9° 380

Distance [m] Cone diameter [m] illuminance [lx]

— C0/C180 (Half-peak divergence: 17.8°)
 — C90/C270 (Half-peak divergence: 18.4°)

Energy efficiency class

This product contains a light source of energy efficiency class E.

Illuminotechnical Features

Light Output Ratio (LOR)	63 %
Source lumens	1669 lm
Delivered lumens	1066 lm
Consumption	15.5 W
Luminaire efficacy	68 lm/W
Colour temperature	2700 K
Standard Deviation of Colour Matching	2 Step MacAdam
Colour rendering index	90 Ra
Colour Rendering Index	60 R9
Black Body Locus	On
Standard Operating Ambient Temperature	-20 / +50°C
Ordinary temperature on the glass	40°C

LED Life / Failure Ratio

L70 B10 C0 252000h (at Tj 65 Ta 25)

UGR

UGR transversal	13.6
UGR axial	13.8
X=4H Y=8H	S=0.25H
Reflection factor	70/50/20

OPTICAL

C0/C180 optics	18°
Light distribution simmetry	Symmetrical

COLOR VECTOR GRAPHIC

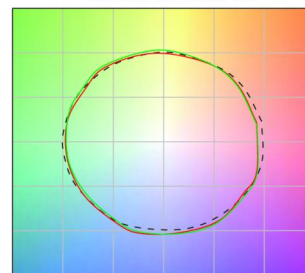



Optics
Light distribution: spot,Cover material: uv resistant polycarbonate

Code
99805



Optics
Light distribution: medium flood,Cover material: uv resistant polycarbonate

Code
99806



Optics
Light distribution: flood,Cover material: uv resistant polycarbonate

Code
99807



Diffuser
Diffuser Type: elliptical filter.
Material:Pom-C, colour:Black.

Code
99775



Anti-glare
Anti-glare Type: honeycomb louvre.
Material:Pom-C, colour:Black.

Code
99776

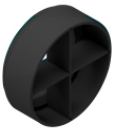

Anti-glare
Anti-glare Type: cross louvres.
Material:Pom-C, colour:Black.

Code
99777



Anti-glare
Anti-glare Type: cylindrical screen.
Material:Pom-C, colour:Black.

Code
99774



Anti-glare
Anti-glare Type: 45° cylindrical screen.
Material:Pom-C, colour:Black.

Code
99773