

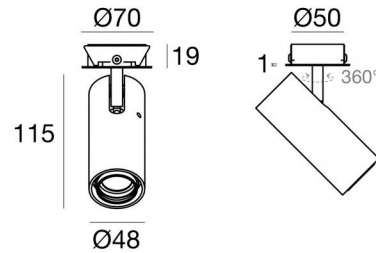

Ceiling Downlights | 1 arrayLED 13 W DC 350 mA  
CRI 90  
**82354W60**





57

Technical data	
Type	Semi-recessed
Installation position	Ceiling
Installation environment	Indoor
Light Source	LED
Circuit structure	arrayLED
Optics	Medium Wide Flood
Light emission direction	frontal
Nominal power	13 W DC
Source lumens	1771 lm
Input voltage range	350mA
CCT / Tone	3000 K
Colour rendering index	90 Ra
C.C. / C.V.	CC
Safety class	3
IP	IP20
Glow wire test	850°
Direct mounting on normally flammable surfaces	Yes
CE	Yes
Driver included	No
Dimmable article	DALI - 1-10V
Directional	Swivelling
total angle (vertical plane)	90 °
total angle (horizontal plane)	360 °
Tilting	No
Walk-over	No
Drive-over	No
Cable included	No
Resin potting	No
Type of light emission	Single emission
Net weight	0.340 Kg
Electrostatic discharge protection	No
Surge protection	No
Optics technology	Anti - Glare

### Finishing casing

Material	Die-cast Aluminium EN AB - 46100
Colour	Black
Processing	Powder coating

### Electronics

	99115 1-10V - N/O button Multi Power 198-264V AC / 180-275V DC (1 art.)
	99375 On/Off Driver 198-264V AC (1 art.)
	83322 Push and Simply Dim - DALI-2 Controller (1 art.)



## Ceiling Downlights | 1 arrayLED 13 W DC 350 mA | CRI 90 | Base 82354W60

Single emission ceiling downlights for indoor application. The warm white LED light source with a medium wide flood light distribution is composed of 1 arrayed LEDs with CCT of 3000 K and a CRI 90; the source luminous flux is 1771 lm, with a 136.2 lm/W nominal luminous efficacy.

The device body is made of die-cast aluminium en ab - 46100 and features a black finish, processed by means of powder coating. The ingress protection degree is IP20; the total weight is of 0.340 kg. The power supply driver is not provided and is to be ordered separately.

The total absorbed power is 13 W.

The device features protection class III and can be ceiling-mounted, with a 57 mm diameter hole (in plasterboard).

Compliant with the EN 60598-1 standard and its specific provisions.

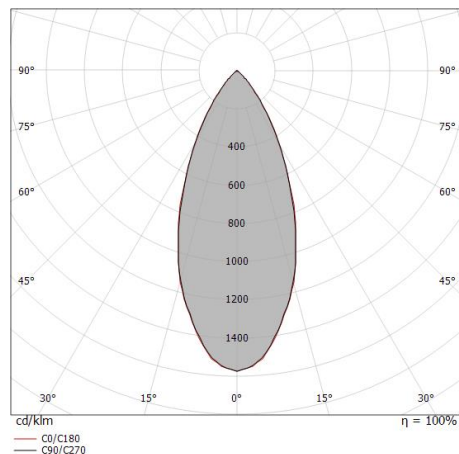

Distance [m]	Cone diameter [m]	illuminance [lx]
0.5	0.40 0.41	E(0°) 6948 E(C90) 2275 E(C0) 2759
1.0	0.81 0.83	E(0°) 1737 E(C90) 696 E(C0) 690
1.5	1.21 1.24	E(0°) 772 E(C90) 309 E(C0) 307
2.0	1.62 1.66	E(0°) 434 E(C90) 174 E(C0) 172
2.5	2.02 2.07	E(0°) 278 E(C90) 111 E(C0) 110
3.0	2.42 2.49	E(0°) 193 E(C90) 77 E(C0) 77

— C0/C180 (Half-peak divergence: 45.0°)  
— C90/C270 (Half-peak divergence: 44.0°)

### Energy efficiency class

This product contains a light source of energy efficiency class E.

### Illuminotechnical Features

Light Output Ratio (LOR)	62 %
Source lumens	1771 lm
Delivered lumens	1104 lm
Consumption	13 W
Luminaire efficacy	84 lm/W
Colour temperature	3000 K
Standard Deviation of Colour Matching	2 Step MacAdam
Colour rendering index	90 Ra
Colour Rendering Index	60 R9
Black Body Locus	On
Standard Operating Ambient Temperature	-20 / +50°C
Ordinary temperature on the glass	40°C

### LED Life / Failure Ratio

L70 B10 C0 252000h (at Tj 65 Ta 25)

### UGR

UGR axial	24.3
UGR transversal	24.2
X=4H   Y=8H	S=0.25H
Reflection factor	70/50/20

### OPTICAL

C0/C180 optics	44°
Light distribution symmetry	Symmetrical

### COLOR VECTOR GRAPHIC





Optics  
Light distribution: spot,Cover material: uv resistant polycarbonate

**Code**  
99805



Optics  
Light distribution: medium flood,Cover material: ,uv resistant polycarbonate,uv resistant polycarbonate,uv resistant polycarbonate

**Code**  
99806



Optics  
Light distribution: flood,Cover material: ,uv resistant polycarbonate,uv resistant polycarbonate,uv resistant polycarbonate

**Code**  
99807



Diffuser  
Diffuser Type: elliptical filter.  
Material:Pom-C, colour:Black.

**Code**  
99775



Anti-glare  
Anti-glare Type: honeycomb louvre.  
Material:Pom-C, colour:Black.

**Code**  
99776

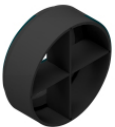

Anti-glare  
Anti-glare Type: cross louvres.  
Material:Pom-C, colour:Black.

**Code**  
99777



Anti-glare  
Anti-glare Type: cylindrical screen.  
Material:Pom-C, colour:Black.

**Code**  
99774



Anti-glare  
Anti-glare Type: 45° cylindrical screen.  
Material:Pom-C, colour:Black.

**Code**  
99773