

Projectors | 198-264 V
1 arrayLED 13 W DC - 15.5 W AC | CRI 98
83799W15

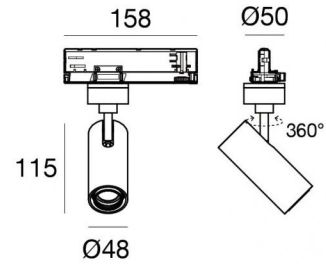

Technical data	
Type	Track
Installation position	Ceiling
Installation environment	Indoor
Light Source	LED
Circuit structure	arrayLED
Optics	Spot
Light emission direction	frontal
Nominal power	13 W DC
Total Power	15.5 W
Source lumens	1482 lm
Nominal input voltage	220 - 240 V AC
Input voltage range	198 - 264 V AC
Frequency	50 - 60 Hz
CCT / Tone	3000 K
Colour rendering index	98 Ra
C.C. / C.V.	AC
Safety class	2
IP	IP20
Glow wire test	850°
Direct mounting on normally flammable surfaces	Yes
CE	Yes
Driver included	Driver
Dimmable article	Bluetooth
Directional	Swivelling
total angle (vertical plane)	90 °
total angle (horizontal plane)	360 °
Tilting	No
Walk-over	No
Drive-over	No
Cable included	No
Resin potting	No
Type of light emission	Single emission
Net weight	0.39 Kg
Electrostatic discharge protection	Yes
Surge protection	2 KV
Optics technology	Anti - Glare

Finishing casing	
Material	Die-cast Aluminium EN AB - 46100
Colour	White
Processing	Powder coating

Technology Partner
SILVAIR

Projectors | 198-264 V | 1 arrayLED 13 W DC - 15.5 W AC | CRI 98 | Base
83799W15

Single emission projectors for indoor application. The warm white LED light source with a spot light distribution is composed of 1 arrayed LEDs with CCT of 3000 K and a CRI 98; the source luminous flux is 1482 lm, with a 114.0 lm/W nominal luminous efficacy.

The device body is made of die-cast aluminium en ab - 46100 and features a white finish, processed by means of powder coating. The ingress protection degree is IP20; the total weight is of 0.39 kg.

The total absorbed power is 15.5 W.

The device features protection class II and can be ceiling-mounted.

Compliant with the EN 60598-1 standard and its specific provisions.

Energy efficiency class

This product contains a light source of energy efficiency class F.

Illuminotechnical Features

Light Output Ratio (LOR)	63 %
Source lumens	1482 lm
Delivered lumens	947 lm
Consumption	15.5 W
Luminaire efficacy	61 lm/W
Colour temperature	3000 K
Standard Deviation of Colour Matching	2 Step MacAdam
Colour rendering index	98 Ra
Black Body Locus	Below
Standard Operating Ambient Temperature	-20 / +50°C
Ordinary temperature on the glass	40°C

LED Life / Failure Ratio

L70 B10 C0 252000h (at Tj 65 Ta 25)

UGR

UGR axial	13.4
UGR transversal	13.2
X=4H Y=8H	S=0.25H
Reflection factor	70/50/20

OPTICAL

C0/C180 optics	18°
Light distribution simmetry	Symmetrical

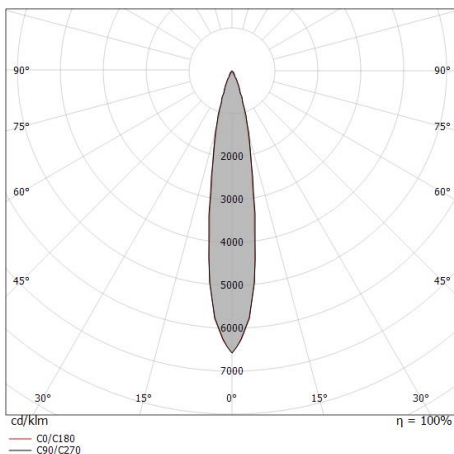

Distance [m]	Cone diameter [m]	E(0°)	E(C90)	E(C0)	Illuminance [lx]
0.5	0.16	24888	11987	12153	
1.0	0.32	6222	2997	3038	
1.5	0.49	2765	1332	1350	
2.0	0.65	1555	749	760	
2.5	0.81	996	479	486	
3.0	0.97	691	333	338	

— C0/C180 (Half-peak divergence: 17.8°)
— C90/C270 (Half-peak divergence: 18.4°)

COLOR VECTOR GRAPHIC

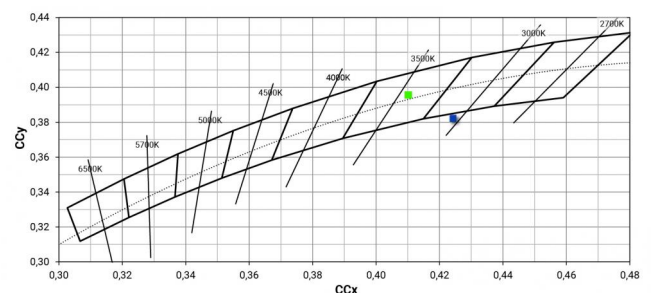
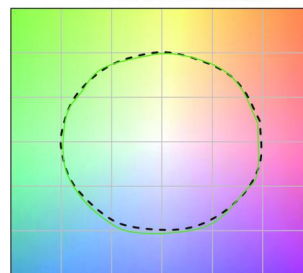

Pound_T | Projectors | Accessories
83799W15



Optics
 Light distribution: spot,Cover material: uv resistant polycarbonate

Code
99805



Optics
 Light distribution: medium flood,Cover material: ,uv resistant polycarbonate,uv resistant polycarbonate,uv resistant polycarbonate

Code
99806



Optics
 Light distribution: flood,Cover material: ,uv resistant polycarbonate,uv resistant polycarbonate,uv resistant polycarbonate

Code
99807



Anti-glare
 Anti-glare Type: 45° cylindrical screen.
 Material:Pom-C, colour:Black.

Code
99773



Anti-glare
 Anti-glare Type: cylindrical screen.
 Material:Pom-C, colour:Black.

Code
99774



Diffuser
 Diffuser Type: elliptical filter.
 Material:Pom-C, colour:Black.

Code
99775



Anti-glare
 Anti-glare Type: honeycomb louvre.
 Material:Pom-C, colour:Black.

Code
99776



Anti-glare
 Anti-glare Type: cross louvres.
 Material:Pom-C, colour:Black.

Code
99777

Pound_T | Projectors | Accessories
83799W15

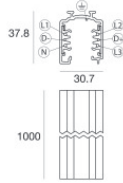

Track
 Length: 1000mm; Type of track: Standard.
 Material:Aluminium, colour:White, processing:Coating.

Finish	Code
White	83336

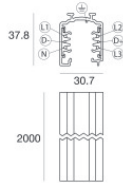

Track
 Length: 2000mm; Type of track: Standard.
 Material:Aluminium, colour:White, processing:Coating.

Finish	Code
White	83337

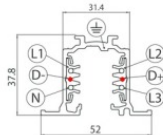

Track - Three-phase Recessed White DALI Track, 2 m (9000-2/W-R)
 Length: 2000mm; Type of track: Standard.
 Material:Aluminium, colour:White, processing:Coating.

Finish	Code
White	80991

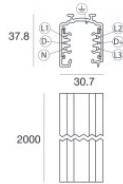

Track
 Length: 2000mm; Type of track: Standard.
 Material:Aluminium, colour:Black, processing:Coating.

Finish	Code
Black	83340

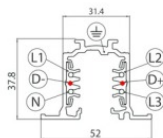

Track - Three-phase Recessed Black DALI Track, 3 m (9000-3/B-R)
 Length: 3000mm; Type of track: Standard.
 Material:Aluminium, colour:Black, processing:Coating.

Finish	Code
Black	80995

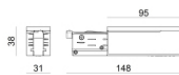

Power supply - White Right power supply header (9001/W)
 Material:PC, colour:white.

Code
81033

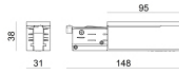

Power supply - Black Right power supply header (9001/B)
 Material:PC, colour:black.

Code
81034

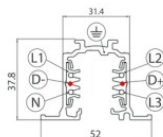

Track - Three-phase Recessed Black DALI Track, 2 m (9000-1/B-R)
 Length: 2000mm; Type of track: Standard.
 Material:Aluminium, colour:Black, processing:Coating.

Finish	Code
Black	80994

Pound_T | Projectors | Accessories
83799W15

		<p>Track Length: 3000mm; Type of track: Standard. Material:Aluminium, colour:White, processing:Coating.</p>	<table border="1"> <thead> <tr> <th>Finish</th> <th>Code</th> </tr> </thead> <tbody> <tr> <td>White</td> <td>83338</td> </tr> </tbody> </table>	Finish	Code	White	83338
Finish	Code						
White	83338						
		<p>Junction - Black power supply junction - centrale (9010/B) Type linear. Material:PC, colour:black.</p>	<table border="1"> <thead> <tr> <th>Finish</th> <th>Code</th> </tr> </thead> <tbody> <tr> <td>Black</td> <td>81043</td> </tr> </tbody> </table>	Finish	Code	Black	81043
Finish	Code						
Black	81043						
		<p>Junction - White power supply junction - central (9010/W) Type linear. Material:PC, colour:white.</p>	<table border="1"> <thead> <tr> <th>Finish</th> <th>Code</th> </tr> </thead> <tbody> <tr> <td>White</td> <td>81042</td> </tr> </tbody> </table>	Finish	Code	White	81042
Finish	Code						
White	81042						
		<p>Junction - Left white T junction - external (9013/W) Type linear. Material:PC, colour:white.</p>	<table border="1"> <thead> <tr> <th>Finish</th> <th>Code</th> </tr> </thead> <tbody> <tr> <td>White</td> <td>81051</td> </tr> </tbody> </table>	Finish	Code	White	81051
Finish	Code						
White	81051						
		<p>Junction - Black left T junction - external (9013/B) Type linear. Material:PC, colour:black.</p>	<table border="1"> <thead> <tr> <th>Finish</th> <th>Code</th> </tr> </thead> <tbody> <tr> <td>Black</td> <td>81052</td> </tr> </tbody> </table>	Finish	Code	Black	81052
Finish	Code						
Black	81052						
		<p>Power supply - White left power supply header (9002/W) Material:PC, colour:white.</p>	<table border="1"> <thead> <tr> <th>Code</th> </tr> </thead> <tbody> <tr> <td>81036</td> </tr> </tbody> </table>	Code	81036		
Code							
81036							
		<p>Junction - Flexible white junction (9018/W) Type flexible curve. Material:PC, colour:white.</p>	<table border="1"> <thead> <tr> <th>Finish</th> <th>Code</th> </tr> </thead> <tbody> <tr> <td>White</td> <td>81066</td> </tr> </tbody> </table>	Finish	Code	White	81066
Finish	Code						
White	81066						
		<p>Closing cap - White end cap 9004/W Material:PC, colour:white.</p>	<table border="1"> <thead> <tr> <th>Code</th> </tr> </thead> <tbody> <tr> <td>80999</td> </tr> </tbody> </table>	Code	80999		
Code							
80999							

Pound_T | Projectors | Accessories
83799W15

		<p>Track - Three-phase Recessed White DALI Track, 1 m (9000-1/W-R) Length: 1000mm; Type of track: Standard. Material:Aluminium, colour:White, processing:Coating.</p>	<table border="1"> <thead> <tr> <th>Finish</th> <th>Code</th> </tr> </thead> <tbody> <tr> <td>White</td> <td>80990</td> </tr> </tbody> </table>	Finish	Code	White	80990
Finish	Code						
White	80990						
		<p>Junction - White electrical junction - internal (9003/W) Type linear. Material:PC, colour:white.</p>	<table border="1"> <thead> <tr> <th>Finish</th> <th>Code</th> </tr> </thead> <tbody> <tr> <td>White</td> <td>81039</td> </tr> </tbody> </table>	Finish	Code	White	81039
Finish	Code						
White	81039						
		<p>Junction - Right white T junction - external (9014/W) Type linear. Material:PC, colour:white.</p>	<table border="1"> <thead> <tr> <th>Finish</th> <th>Code</th> </tr> </thead> <tbody> <tr> <td>White</td> <td>81054</td> </tr> </tbody> </table>	Finish	Code	White	81054
Finish	Code						
White	81054						
		<p>Junction - White L junction - internal (9011/W) Type linear. Material:PC, colour:white.</p>	<table border="1"> <thead> <tr> <th>Finish</th> <th>Code</th> </tr> </thead> <tbody> <tr> <td>White</td> <td>81045</td> </tr> </tbody> </table>	Finish	Code	White	81045
Finish	Code						
White	81045						
		<p>Junction - Black electrical junction - internal (9003/B) Type linear. Material:PC, colour:black.</p>	<table border="1"> <thead> <tr> <th>Finish</th> <th>Code</th> </tr> </thead> <tbody> <tr> <td>Black</td> <td>81040</td> </tr> </tbody> </table>	Finish	Code	Black	81040
Finish	Code						
Black	81040						
		<p>Junction - White L junction - external (9012/W) Type linear. Material:PC, colour:white.</p>	<table border="1"> <thead> <tr> <th>Finish</th> <th>Code</th> </tr> </thead> <tbody> <tr> <td>White</td> <td>81048</td> </tr> </tbody> </table>	Finish	Code	White	81048
Finish	Code						
White	81048						
		<p>Junction - Black L junction - external (9012/B) Type linear. Material:PC, colour:black.</p>	<table border="1"> <thead> <tr> <th>Finish</th> <th>Code</th> </tr> </thead> <tbody> <tr> <td>Black</td> <td>81049</td> </tr> </tbody> </table>	Finish	Code	Black	81049
Finish	Code						
Black	81049						
		<p>Closing cap - Black end cap 9004/B Material:PC, colour:black.</p>	<table border="1"> <thead> <tr> <th>Code</th> </tr> </thead> <tbody> <tr> <td>81000</td> </tr> </tbody> </table>	Code	81000		
Code							
81000							

Pound_T | Projectors | Accessories
83799W15

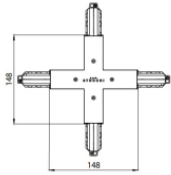

Junction - Black X junction (9017/B)
Type linear.
Material:PC, colour:black.

Finish	Code
Black	81064

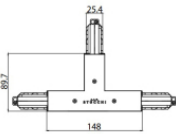

Junction - Left white T junction - internal (9015/W)
Type linear.
Material:PC, colour:white.

Finish	Code
White	81057

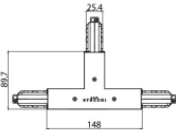

Junction - Left black T junction - internal (9015/B)
Type linear.
Material:PC, colour:black.

Finish	Code
Black	81058

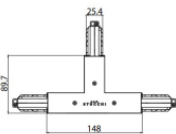

Junction - Right White T junction - internal (9016/W)
Type linear.
Material:PC, colour:white.

Finish	Code
White	81060

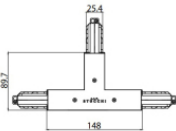

Junction - Right black T junction - internal (9016/B)
Type linear.
Material:PC, colour:black.

Finish	Code
Black	81061



Closing cap - Recessed white end cap 9004-R/W
Material:PC, colour:white.

Code
81002



Closing cap - Recessed black end cap 9004-R/B
Material:PC, colour:black.

Code
81003



Ceiling rose - 1.5m white pendant luminaires kit + bracket (9000-KIT5-1,5-W)
Material:plastic, colour:white.

Code
81012

Pound_T | Projectors | Accessories
83799W15

		<p>Ceiling rose - 1.5m black pendant luminaires kit + bracket ((9000-KIT5-1,5-B) Material:plastic, colour:black.</p>	<p>Code 81014</p>
		<p>Ceiling rose - 5m white pendant luminaires kit + bracket (9000-KIT5-5-W) Material:plastic, colour:white.</p>	<p>Code 81013</p>
		<p>Junction - Black L junction - internal (9011/B) Type linear. Material:PC, colour:black.</p>	<p>Finish Black</p> <p>Code 81046</p>
		<p>Suspensions - White rigid suspension 1m (S-9000-P3-W) Material:plastic, colour:white.</p>	<p>Code 81021</p>
		<p>Suspensions - Black rigid suspension 1m (S-9000-P3-B) Material:plastic, colour:black.</p>	<p>Code 81022</p>
		<p>Bracket - Anodized fixing bracket (S-9000/131) L=35mm, H=14mm, D=24mm. Material:Aluminium, colour:translucent.</p>	<p>Finish Anod. Al.</p> <p>Code 81086</p>
		<p>Bracket - White fixing braket (S-9000/131-W) L=35mm, H=14mm, D=24mm. Material:Aluminium, colour:white, processing:Coating.</p>	<p>Finish White</p> <p>Code 81087</p>
		<p>Bracket - Black fixing braket (S-9000/131-B) L=35mm, H=14mm, D=24mm. Material:Aluminium, colour:Black, processing:Coating.</p>	<p>Finish Black</p> <p>Code 81088</p>

Pound_T | Projectors | Accessories
83799W15

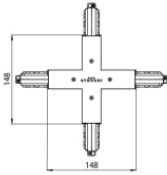
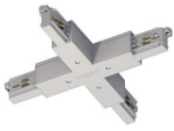

Junction - White X junction (9017/W)
Type linear.
Material:PC, colour:white.

Finish	Code
White	81063



Ceiling rose - 5m black pendant luminaires kit + bracket (9000-KIT5-5-B)
Material:plastic, colour:black.

Code
81015



Cable cover - White cover for recessed L junction (S-9011-R/6-W)
Material:PC, colour:white.

Code
81075

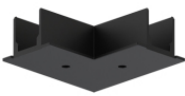

Cable cover
Material:PC, colour:black.

Code
81076



Cable cover - Black recessed cover (S-9001-R/6-B)
Material:PC, colour:black.

Code
81070

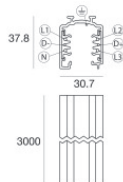
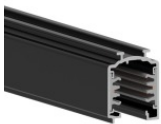

Track
Length: 3000mm; Type of track: Standard.
Material:Aluminium, colour:Black, processing:Coating.

Finish	Code
Black	83341

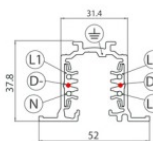

Track - Three-phase Recessed White DALI Track, 3 m (9000-3/W-R)
Length: 3000mm; Type of track: Standard.
Material:Aluminium, colour:White, processing:Coating.

Finish	Code
White	80992

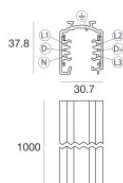

Track
Length: 1000mm; Type of track: Standard.
Material:Aluminium, colour:Black, processing:Coating.

Finish	Code
Black	83339

	<p>Tool - Cutter S-9000/T</p>	<p>Code 81005</p>
	<p>Junction - Flexible black junction (9018/B) Type flexible curve. Material:PC, colour:black.</p>	<p>Finish Black Code 81067</p>
	<p>Cable cover - White recessed cover (S-9001-R/6-W) Material:PC, colour:white.</p>	<p>Code 81069</p>
	<p>Suspensions - 5m white pendant luminaire kit (9000-KIT3-5-W) Material:plastic, colour:white.</p>	<p>Code 81007</p>
	<p>Suspensions - 5m black pendant luminaire kit (9000-KIT3-5-B) Material:plastic, colour:black.</p>	<p>Code 81009</p>
	<p>Suspensions - 1.5m black pendant luminaire kit (9000-KIT3-1,5-B) Material:plastic, colour:black.</p>	<p>Code 81008</p>
	<p>Suspensions - Black rigid suspension clip (S-9000-P2-B) Material:plastic, colour:black.</p>	<p>Code 81019</p>
	<p>Cable cover - White cover for recessed X junction (S-9017-R/6-W) Material:PC, colour:white.</p>	<p>Code 81081</p>

Pound_T | Projectors | Accessories
83799W15

		<p>Black three-phase adapter (9009-4/B)</p>	<p>Code 81093</p>
		<p>Bracket - Black stiffening bracket (S-9000/333-B) L=180mm, H=24mm, D=20mm. Material:Aluminium, colour:black RAL 9005, processing:Coating.</p>	<p>Finish Black Code 81026</p>
		<p>Power supply - Black left power supply header (9002/B) Material:PC, colour:black.</p>	<p>Code 81037</p>
		<p>Track - Three-phase Recessed Grey DALI Track, 1 m (9000-1/B-R) Length: 1000mm; Type of track: Standard. Material:Aluminium, colour:Black, processing:Coating.</p>	<p>Finish Black Code 80993</p>
		<p>Cable cover - Black cover for recessed X junction (S-9017-R/6-B) Material:PC, colour:black.</p>	<p>Code 81082</p>
		<p>Bracket - White stiffening bracket (S-9000/333-W) L=180mm, H=24mm, D=20mm. Material:Aluminium, colour:white RAL 9010, processing:Coating.</p>	<p>Finish White Code 81025</p>
		<p>Cable cover - White cover for recessed T junction (S-9013-R/6-W) Material:PC, colour:white.</p>	<p>Code 81078</p>
		<p>Suspensions - White rigid suspension clip (S-9000-P2-W) Material:plastic, colour:white.</p>	<p>Code 81018</p>

Pound_T | Projectors | Accessories
83799W15

	<p>Cable cover Material:black, colour:black.</p>	<p>Code 83250</p>	
	<p>Cable cover Material:white.</p>	<p>Code 83249</p>	
		<p>Junction - Right black T junction - external (9014/B) Type linear. Material:PC, colour:black.</p>	<p>Finish Black Code 81055</p>
		<p>Cable cover - White cover for recessed junction (S-9010-R/6-W) Material:PC, colour:white.</p>	<p>Code 81072</p>
		<p>Bracket - Anodized stiffening bracket (S-9000/333) L=180mm, H=24mm, D=26mm. Material:Aluminium, colour:Anodised Aluminum, processing:Anodisation.</p>	<p>Finish Code 81024</p>
		<p>Closing cap - White gasket (S-9001/115-W) Material:white.</p>	<p>Code 81084</p>
		<p>Cable cover - Black cover for recessed T junction (S-9013-R/6-B) Material:PC, colour:black.</p>	<p>Code 81079</p>
		<p>Cable cover - Black cover for recessed junction (S-9010-R/6-B) Material:PC, colour:black.</p>	<p>Code 81073</p>

Pound_T | Projectors | Accessories
83799W15



Suspensions - 1.5m white pendant luminaires kit (9000-KIT3-1,5-W)
 Material:plastic, colour:white.

Code
81006

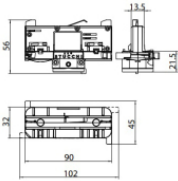

White three-phase adapter (9009-4/W)

Code
81091

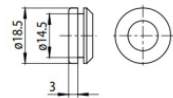

Closing cap - Black gasket (S-9001/115-B)
 Material:black, colour:black.

Code
81085

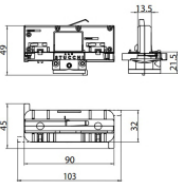

White three-phase/DALI adapter (9009/W)

Code
81094

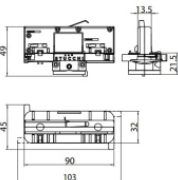

Black three-phase/DALI adapter (9009/B)

Code
81095

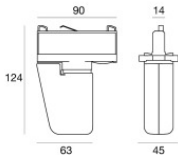

Electronic accessory - TWIL-DALI controller for devices with DALI protocol installed on three-phase track.
 installation position: ceiling L=90mm, H=124mm, D=45mm.
 Material:ABS Plastic, colour:black.

Code
C-E700008

Wiring Diagram

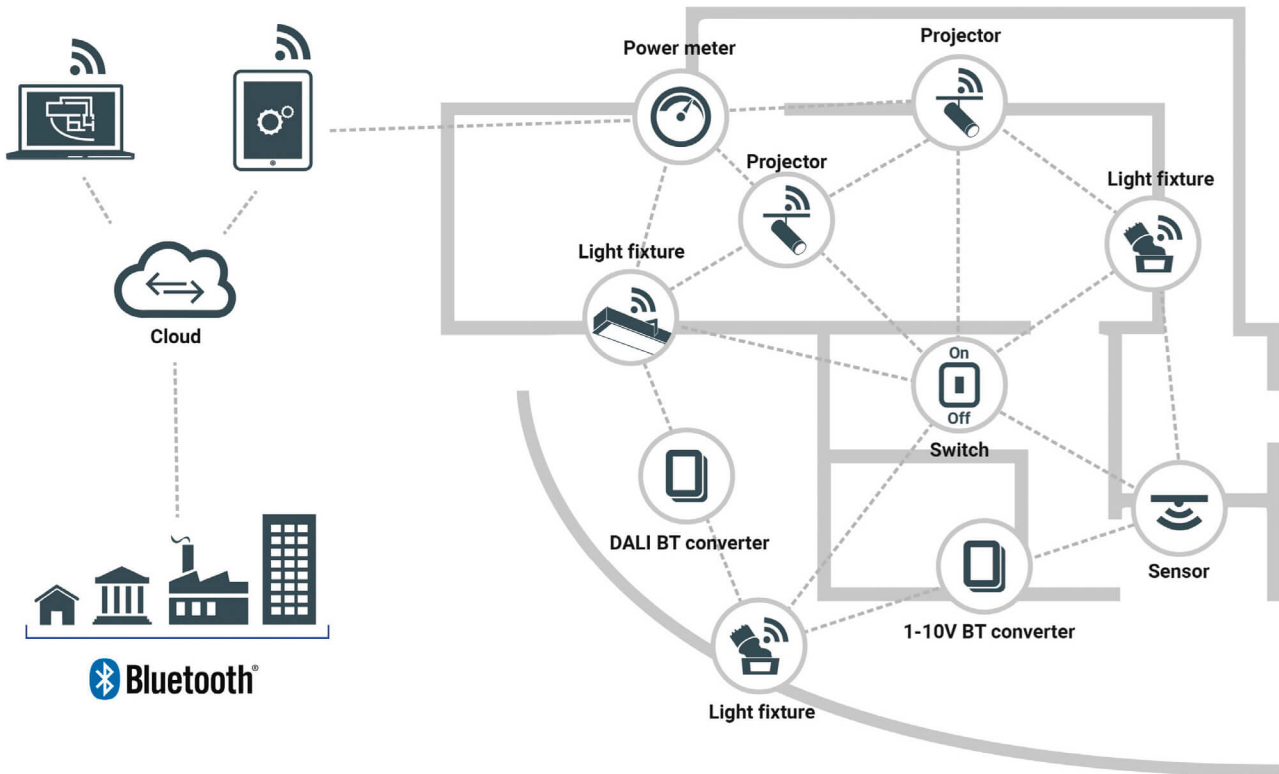

Identify

The first time the device is turned on and every time it gets reset, the system identify the lamps. The identification consists in an animation called "Attention event" with a 40% dimming for 500ms, 100% dimming for 500ms. The blue status LED blinks during identification too, 500msON/500ms OFF.

Bluetooth - Factory reset for Bluetooth device

A factory reset of the bluetooth device will change the device status in the network mesh from provisioned to not provisioned, all the network settings will be lost. This feature is necessary to reset the connection of a device which cannot be longer controlled. To perform the factory reset action on the device a magnet must be placed on the shown symbol on the box containing the bluetooth module. Keep contact for 5 seconds. Once the factory reset operation is done the system will identify the device.



Antenna

The antenna is incorporated into the article.

LED Blinking

The blue status LED placed on the box containing the Bluetooth interface performs a blink pattern depending on the lamp status.

Quick blinking/slow blinking

The LED blinks fast if the lamp is not connected to the network (every 300ms)
The LED blinks slowly if the lamp is connected to the network (every 2s)

Unprovisioned



Provisioned



Factory Reset

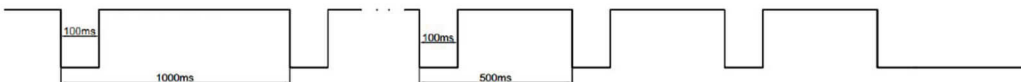

Mesh packet received



Other informations

- If the device is encased in a box, the wireless range may be affected, especially by metallic surfaces. Wireless range must be verified.
- An unprovisioned device requires 30 seconds to be shown as available to provisioning after turning on
- The device successfully passed the SILVAIR test process
- Supporting EnOcean switch 83017
- Supporting Murata 83016 sensors
- The device can be operated with the SILVAIR app available for Apple phones and tablets
- Check the SILVAIR guide for more informations <https://silvair.com/resources/product-documents/>
- Linea Light has no responsibility for any third party instrument and does not provide any declaration, explicit or implicit, about the availability and/or the performances of said instrument.

POUND_T POUND FOCUS

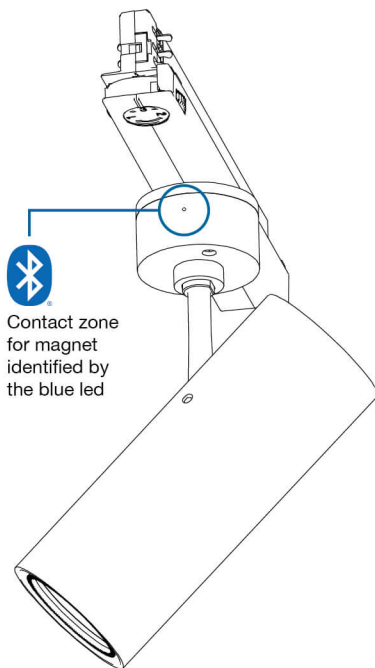

POUND SHAPER

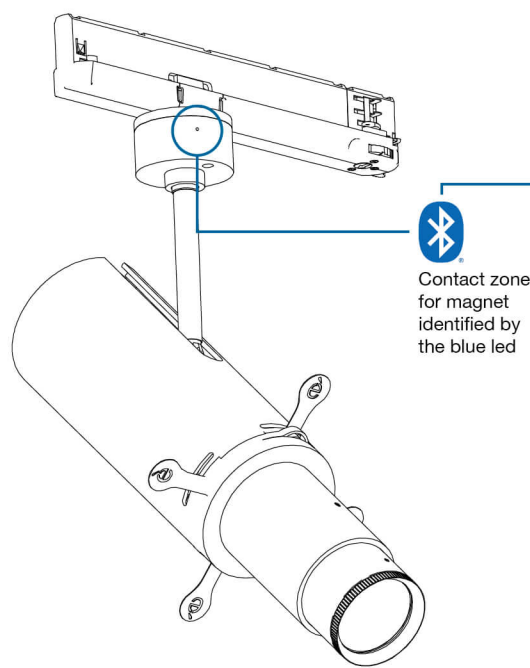

OPTUS_T

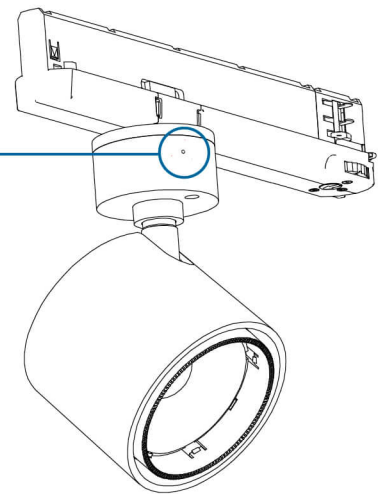

OPTUS_Ww

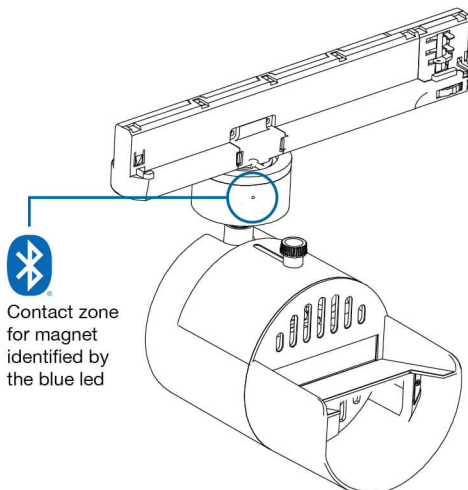

Base NAVATA OPTUS NAVATA POUND SHAPER

